

Make	Model	Year	Install	CAN	Lights	Trunk/Liftgate	IGN	I/O Changes
DL-FM3 Lincoln	MKX 80 bit Key	2011-12	Type 7	OBD-II	Park / Auto A	BCM/SW	GREEN	Green White/Blue N/A

Firmware: Esta instalación utiliza **BLADE-AL (DL) -FM3**, módulo flash y actualiza el firmware del controlador antes de la instalación.

Configuración del controlador: Configure la función 1-11 en la opción 2 (*Pulso de encendido - mismo tiempo que el pulso de desarmado*) para el manejo adecuado de la alarma OEM.

Instalación: El tipo 7 requiere cortar el lazo FM3 TX cerca del conector BLADE del arnés, cortar el lazo antes de programar el vehículo.

Cerraduras: Tipo A se bloquea en el conector negro de 26 clavijas, Bloqueo: clavija # 6, **azul/verde**, Desbloqueo: clavija # 8, **amarillo/violeta**.

Liberación de la compuerta trasera/maletero: (-) en el conector BCM negro de 26 clavijas (clavija n. ° 23, **marrón**), también disponible en la compuerta interruptor de liberación Conector de 6 pines (pin # 6, **gris o marrón**), o conector de 8 pines (pin # 7, **gris/amarillo**)

Luces de estacionamiento: + luces de estacionamiento están disponibles en el conector BCM gris de 10 pines (pin # 6, **amarillo/azul**).

RAP: Manejo del RAP, conéctelo a la clavija de la puerta del conductor en el conector BCM negro de 26 clavijas, clavija n. ° 9, **violeta**.



Tenga en cuenta que el arnés ha cambiado, se han agregado puentes que permiten seleccionar entre potencia IGN y PATS para la programación BLADE. Este tipo de instalación requiere que el puente verde esté conectado, otra configuración no funcionará.

FTI-FDK1 - Notas de instalación y configuración

- A** CORTE REQUERIDO
- B** NO SE CONECTA (Si el vehículo no está equipado con un inmovilizador, conéctelo antes de programar)
- C** CONEXION REQUERIDA
- D** CONEXIÓN OPCIONAL
- E** CONEXION REQUERIDA



COBERTURA DE FUNCIONES															
IMMOBILIZER DATA															
DOOR LOCK															
DOOR UNLOCK															
ARM OEM ALARM															
DISARM OEM ALARM															
TRUNK/HATCH RELEASE															
DOOR STATUS															
RAP SHUTDOWN															
BRAKE STATUS															
HOOD STATUS															
TACH OUTPUT															
A/M CONTROL															
PARKING LIGHTS															

•FT-DAS Required for manual transmission.
•BOTH Red & Red/White MUST be connected with high current application.

Jumper Setting

Parking Light				(+)Door Trigger In
Accessory				(-)Door Trigger In
Ignition (Default)				
Trunk				Starter
Starter				Ignition
Parking Light (Default)				Accessory (Default)

CM7000/7200 Cut loop for A/T

CM-900S/900AS

CM900AS/900S Jumper

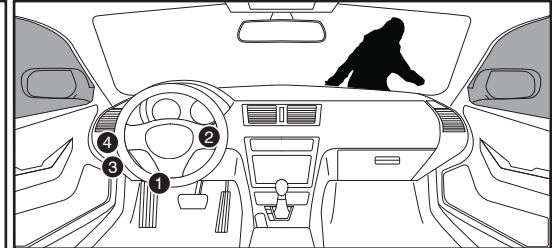
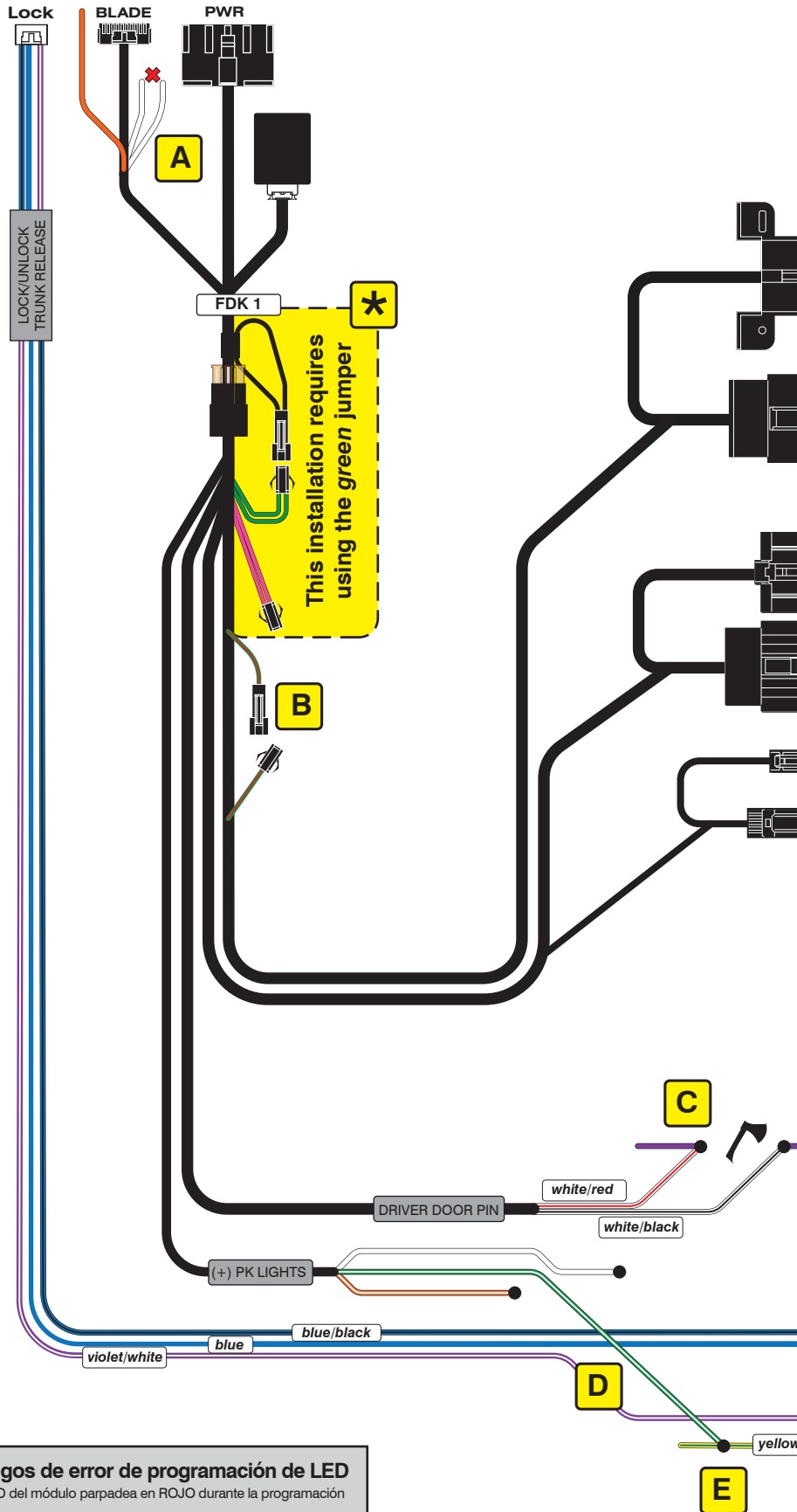

OBD-II Connector

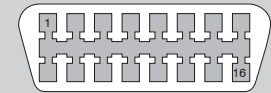

Ignition switch

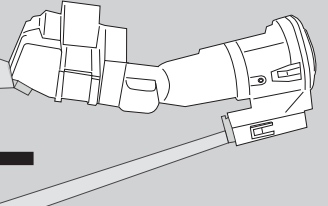

BCM

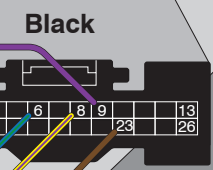
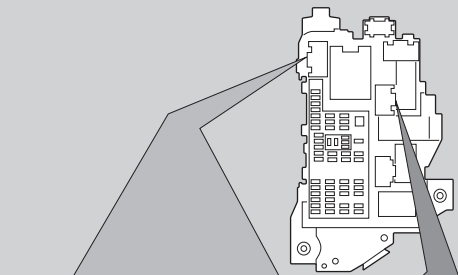

Hatch Release

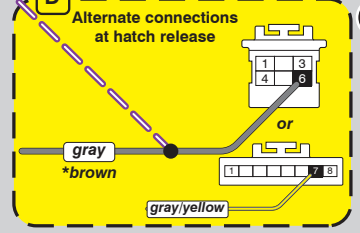

Códigos de error de programación de LED

El LED del módulo parpadea en ROJO durante la programación

- 1x - Error de CAN, verifique el cableado
- 2x - Error de VIN, verifique el cableado CAN
- 3x - Firmware incorrecto
- 4x - Error de VIN, vehículo no identificado
- 5x - Error de aprendizaje del inmovilizador (RX / TX)
- ** Parpadeo rojo rápido: problema de RX / TX, cables inversos, confirmar 2 llaves diferentes, confirme que el inmovilizador del vehículo está operativo
- 9x - Introduzca el cilindro, retirelo y continúe

CARTRIDGE INSTALLATION

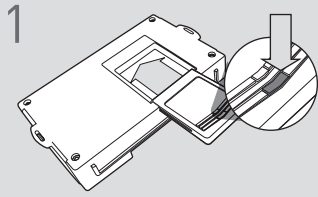

1 Slide cartridge into unit. Notice button under LED.

2

Ready for Module Programming Procedure.

MODULE PROGRAMMING PROCEDURE - 1 OF 2

NOTE

1 To complete this procedure, both OEM keys are required.

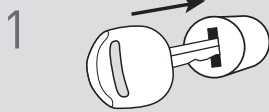

1 Insert key 1 into ignition.



2 Turn key 1 to ON position.

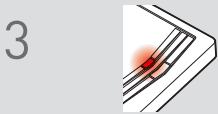

3 LED will turn solid RED.

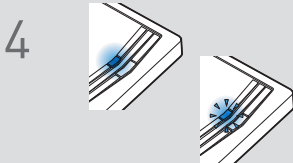

4 If LED turns solid BLUE, proceed with step 21.

If LED flashes BLUE, proceed with step 5.

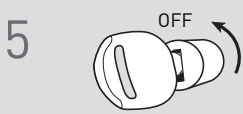

5 Turn key 1 to OFF position.

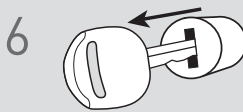

6 Remove key 1.



7 Wait, LED will turn OFF. (This may take up to 30 seconds.)

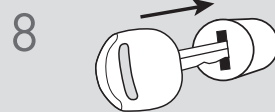

8 Insert key 1 into ignition.



9 Turn key 1 to ON position.



If the LED begins to flash RED, verify the RX and TX connections between the module and the vehicle.

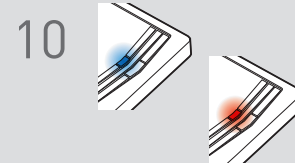

10 If LED turns solid BLUE for 2 seconds, proceed with step 21.

If LED turns solid RED, proceed with step 11 within 5 seconds, after LED turns OFF.

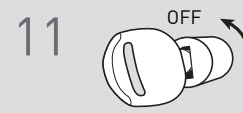

11 Turn key 1 to OFF position.

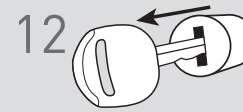

12 Remove key 1.



13 Insert key 2 into ignition.



IMPORTANT: READ NEXT PAGE !

MODULE PROGRAMMING PROCEDURE - 2 OF 2

14  Turn key 2 to ON position.

 **TIME RESTRICTION COMING UP !**

15  Wait, LED will turn solid RED then will turn OFF.

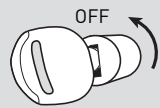
16  **TIME RESTRICTION**
Complete steps 16 to 20 within 5 seconds.
Turn key 2 to OFF position.

17  Remove key 2.

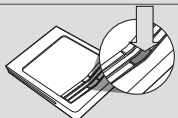
18  Press and release programming button.

19  Insert key 2 into ignition.

20  Turn key 2 to ON position.
Do not start vehicle.

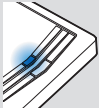
21  Wait, LED will turn solid BLUE for 2 seconds.

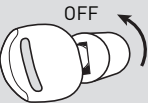
22  Turn key 2 to OFF position.

23  Remove key 2.

24
Module Programming Procedure completed.