

Make	Model	Year	Install	CAN	Lights	Trunk/Liftgate	IGN	I/O Changes
DL-FM3					Park / Auto			Green White/Blue
Ford	Super Duty 80 bit Key	2011-16	Type 8	OBD-II	A	N/A	GREEN	N/A

Firmware:

Esta instalación utiliza **BLADE-AL (DL) -FM3**, módulo flash y actualiza el firmware del controlador antes de la instalación.

Configuración del controlador: Configure la función 1-11 en la opción 2 (Pulso de encendido - mismo tiempo que el pulso de desarmado) para el manejo adecuado de la alarma OEM.

Instalación: El tipo 8 requiere cortar el bucle FM3 TX cerca del conector BLADE del arnés, cortar el bucle antes de programar el vehículo.

Cerraduras: Tipo A se bloquea en el conector negro de 26 clavijas, Bloqueo: clavija # 6, **azul/verde**, Desbloqueo: clavija # 8, **amarillo/violeta**.

Luces de estacionamiento: + Luces de estacionamiento están disponibles en el conector BCM gris de 10 pines (pin # 6, **amarillo / azul**).

RAP:

Manejo del RAP, conéctelo a la clavija de la puerta del conductor en el conector BCM negro de 26 clavijas, clavija n. ° 9, **violeta**.

***** Tenga en cuenta que el arnés ha cambiado, se han agregado puentes que permiten seleccionar entre potencia IGN y PATS para la programación de BLADE. Este tipo de instalación requiere que el puente VERDE esté conectado, otra configuraciones no funcionará.

Nota: Si el vehículo no está equipado con un inmovilizador, conecte el puente ROSA para la programación de BLADE.

FTI-FDK1 - Notas de instalación y configuración

- A** CORTE REQUERIDO
- B** NO SE CONECTA (Si el vehículo no está equipado con un inmovilizador, conéctelo antes de programar)
- C** CONEXION REQUERIDA
- D** CONEXION REQUERIDA
- E** CONEXION REQUERIDA



COBERTURA DE FUNCIONES															
IMMOBILIZER DATA															
DOOR LOCK															
DOOR UNLOCK															
ARM OEM ALARM															
DISARM OEM ALARM															
DOOR STATUS															
RAP SHUTDOWN															
BRAKE STATUS															
HOOD STATUS															
TACH OUTPUT															
A/M CONTROL															
PARKING LIGHTS															

•FT-DAS Required for manual transmission.
•BOTH Red & Red/White MUST be connected with high current application.

Jumper Setting

Parking Light				(+)Door Trigger In
Accessory				(-)Door Trigger In
Ignition (Default)				(Default)
Trunk				Starter
Starter				Ignition
Parking Light (Default)				Accessory (Default)

CM7000/7200 Cut loop for A/T

CM-900S/900AS

CM900AS/900S Jumper

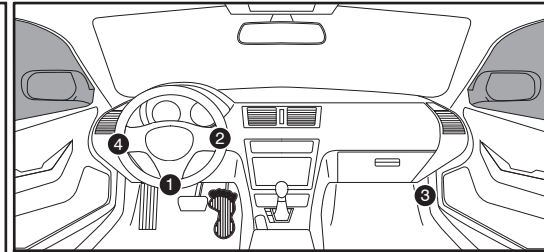
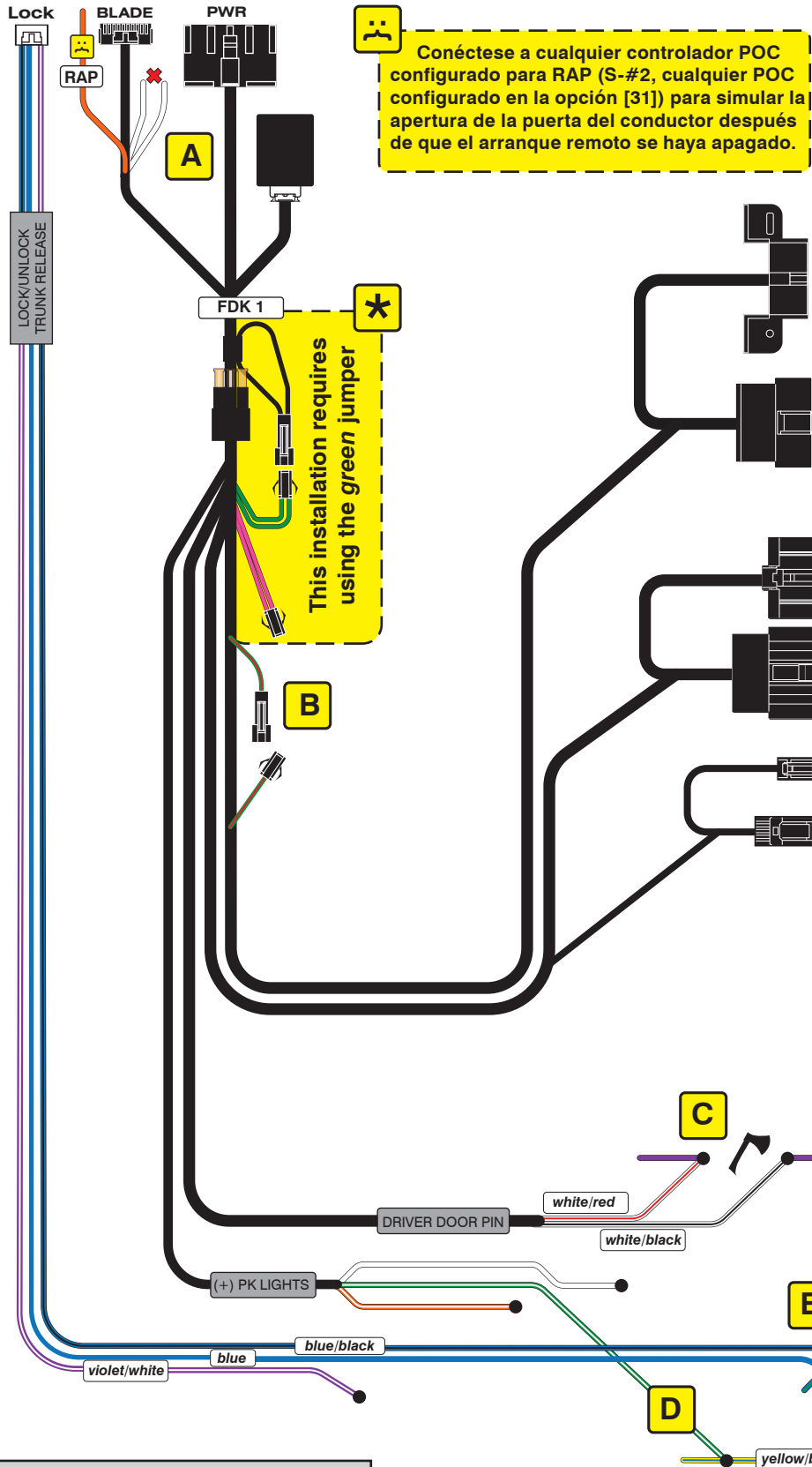

OBD-II Connector

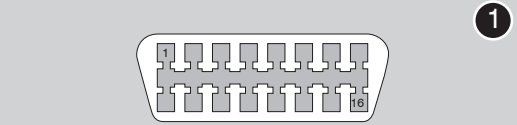

Ignition switch

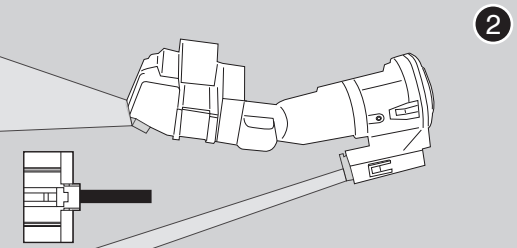

BCM

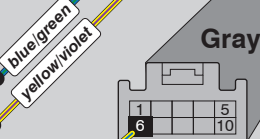
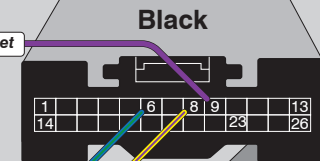
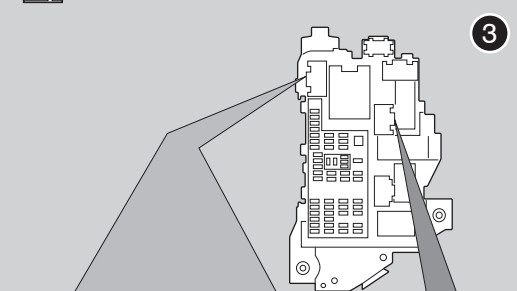

Códigos de error de programación de LED

El LED del módulo parpadea en ROJO durante la programación

- 1x - Error de CAN, verifique el cableado
- 2x - Error de VIN, verifique el cableado CAN
- 3x - Firmware incorrecto
- 4x - Error de VIN, vehículo no identificado
- 5x - Error de aprendizaje del inmovilizador (RX / TX)
- ** Parpadeo rojo rápido: problema de RX / TX, cables inversos, confirmar 2 llaves diferentes, confirme que el inmovilizador del vehículo está operativo
- 9x - Introduzca el cilindro, retírelo y continúe

CARTRIDGE INSTALLATION

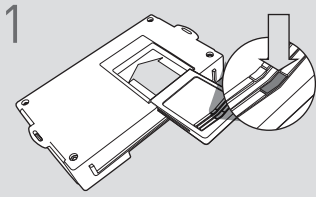

1 Slide cartridge into unit. Notice button under LED.

2

Ready for Module Programming Procedure.

MODULE PROGRAMMING PROCEDURE - 1 OF 2

NOTE

1 To complete this procedure, both OEM keys are required.

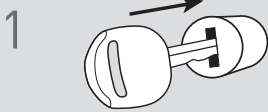

1 Insert key 1 into ignition.



2 Turn key 1 to ON position.

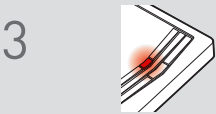

3 LED will turn solid RED.

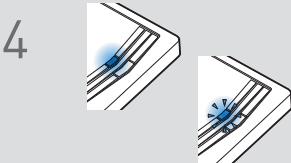

4 If LED turns solid BLUE, proceed with step 21.

If LED flashes BLUE, proceed with step 5.

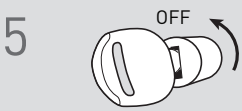

5 Turn key 1 to OFF position.

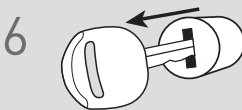

6 Remove key 1.



7 Wait, LED will turn OFF. (This may take up to 30 seconds.)

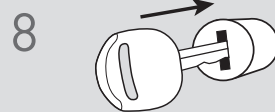

8 Insert key 1 into ignition.



9 Turn key 1 to ON position.



If the LED begins to flash RED, verify the RX and TX connections between the module and the vehicle.

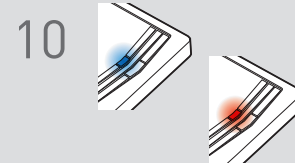

10 If LED turns solid BLUE for 2 seconds, proceed with step 21.

If LED turns solid RED, proceed with step 11 within 5 seconds, after LED turns OFF.

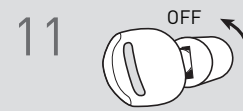

11 Turn key 1 to OFF position.

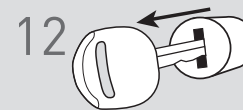

12 Remove key 1.

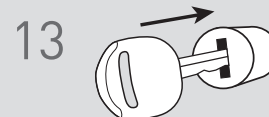

13 Insert key 2 into ignition.



IMPORTANT: READ NEXT PAGE !

MODULE PROGRAMMING PROCEDURE - 2 OF 2

14  Turn key 2 to ON position.

 **TIME RESTRICTION COMING UP !**

15  Wait, LED will turn solid RED then will turn OFF.

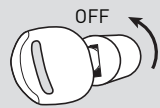
16  **TIME RESTRICTION**
Complete steps 16 to 20 within 5 seconds.
Turn key 2 to OFF position.

17  Remove key 2.

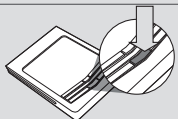
18  Press and release programming button.

19  Insert key 2 into ignition.

20  Turn key 2 to ON position.
Do not start vehicle.

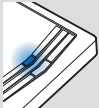
21  Wait, LED will turn solid BLUE for 2 seconds.

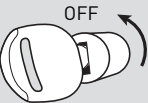
22  Turn key 2 to OFF position.

23  Remove key 2.

24
Module Programming Procedure completed.