

FTI-FDK1: Vehicle Coverage and Preparation Notes

Make	Model	Year	Install	CAN	Lights	Trunk/Liftgate	IGN	I/O Changes
DL-FM3 Ford	Expedition 80 bit Key	2015-17	Type 9	OBD-II	Park / Auto A	BCM/SW	GREEN	Green White/Blue N/A

Firmware: This installation uses **BLADE-AL(DL)-FM3**, flash module and update the controller firmware before installing.

Controller Configuration: Set feature 1-11 to option 2 (Ignition pulse - same timing as disarm pulse) for proper handling of OEM alarm.

Installation: Type 9 requires cutting the FM3 TX loop near the harness BLADE connector, cut loop before programming to vehicle.

Locks: Type A locks at 26-pin BCM connector, Lock: Pin #6, white/brown, Unlock: Pin #8, blue/brown.

Rear hatch release: (-) at black 26-pin BCM connector (pin #23, brown), also available at hatch release switch connector (pin #7, gray/yellow)

Parking lights: If vehicle is not equipped with auto-lights, + parking lights are available at the gray 10-pin BCM connector (pin #6, yellow/blue).

RAP: RAP handling, connect to driver door pin at black 26-pin BCM connector, pin#9, green/violet.



Please note that the harness has changed, jumpers have been added that allow selecting between IGN and PATS power for BLADE programming. This install type requires that the Green jumper is connected, other configuration will not work.

FTI-FDK1 - Installation and Configuration Notes

- A** CUT REQUIRED
- B** DO NOT CONNECT (If the vehicle is not equipped with an immobilizer, connect before programming)
- C** REQUIRED CONNECTION
- D** OPTIONAL CONNECTION
- E** REQUIRED CONNECTION



FEATURE COVERAGE															
IMMOBILIZER DATA															
DOOR LOCK															
DOOR UNLOCK															
ARM OEM ALARM															
DISARM OEM ALARM															
TRUNK/HATCH RELEASE															
DOOR STATUS															
RAP SHUTDOWN															
BRAKE STATUS															
HOOD STATUS															
TACH OUTPUT															
A/M CONTROL															
PARKING LIGHTS															

•FT-DAS Required for manual transmission.
•BOTH Red & Red/White MUST be connected with high current application.

Jumper Setting

Parking Light				(+)Door Trigger In
Accessory				(-)Door Trigger In
Ignition (Default)				(Default)

Trunk				Starter
Starter				Ignition
Parking Light (Default)				Accessory (Default)

CM7000/7200 Cut loop for A/T

CM-900S/900AS

CM900AS/900S Jumper

**START
ACC
IGN1**

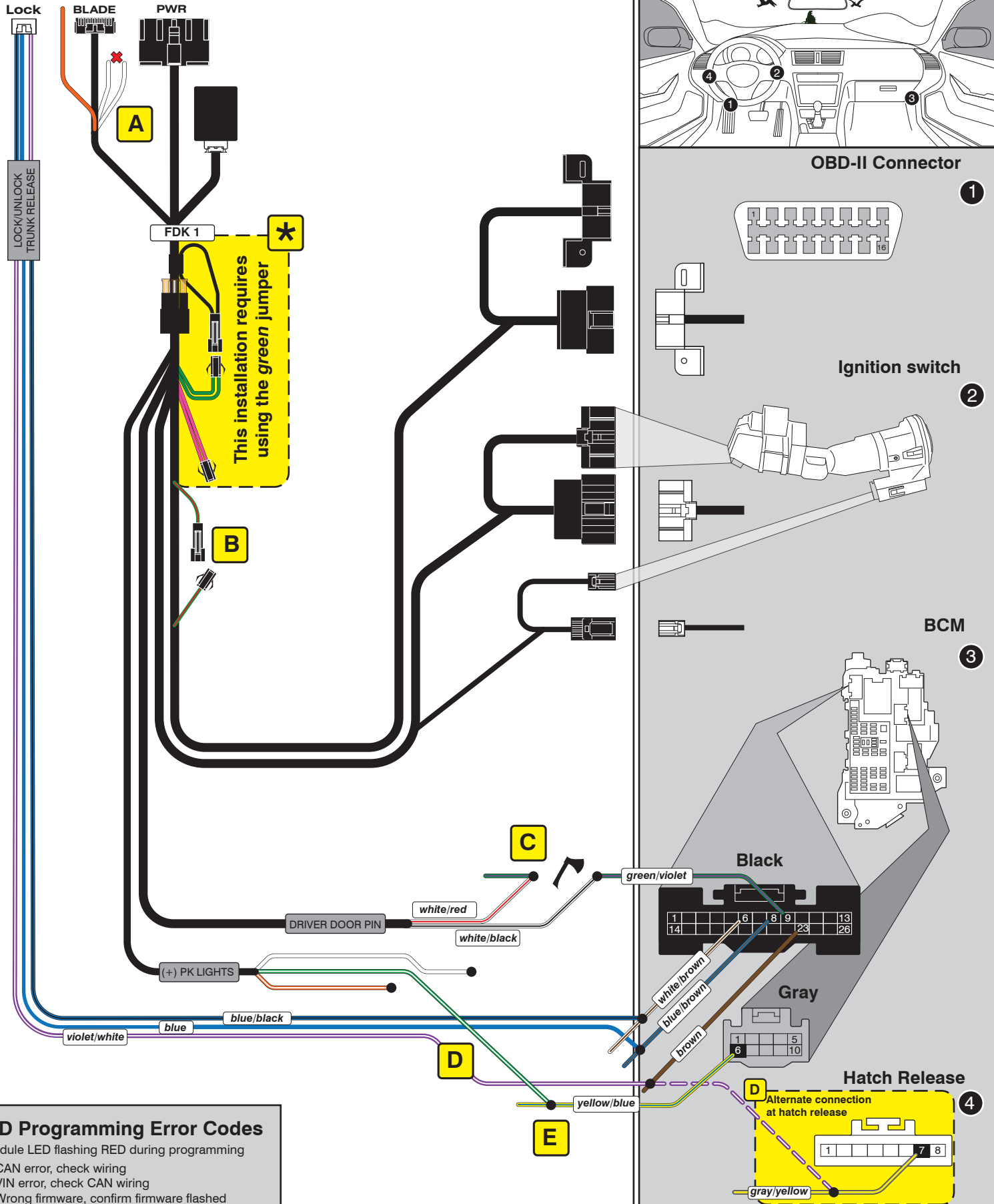

LED Programming Error Codes

- Module LED flashing RED during programming
- 1x - CAN error, check wiring
- 2x - VIN error, check CAN wiring
- 3x - Wrong firmware, confirm firmware flashed
- 4x - VIN error, vehicle not identified, contact support
- 5x - Immobilizer learn error, check RX/TX wiring
- **Rapid red flash - RX/TX issue, reverse wires, confirm
- 2 different keys, confirm immobilizer is operational
- 9x - Key in cylinder, remove and proceed

CARTRIDGE INSTALLATION

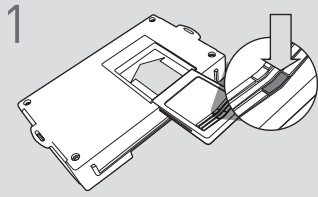

1 Slide cartridge into unit. Notice button under LED.

2

Ready for Module Programming Procedure.

MODULE PROGRAMMING PROCEDURE - 1 OF 2

NOTE

1 To complete this procedure, both OEM keys are required.

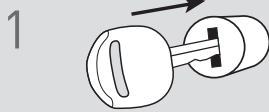

1 Insert key 1 into ignition.



2 Turn key 1 to ON position.

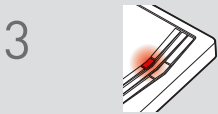

3 LED will turn solid RED.

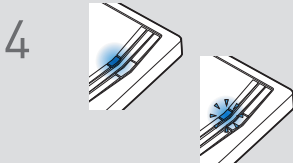

4 If LED turns solid BLUE, proceed with step 21.

If LED flashes BLUE, proceed with step 5.

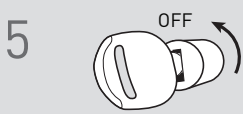

5 Turn key 1 to OFF position.

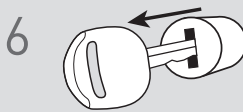

6 Remove key 1.



7 Wait, LED will turn OFF. (This may take up to 30 seconds.)

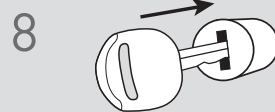

8 Insert key 1 into ignition.



9 Turn key 1 to ON position.



If the LED begins to flash RED, verify the RX and TX connections between the module and the vehicle.

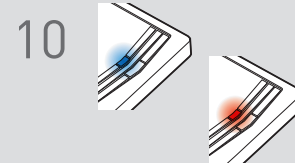

10 If LED turns solid BLUE for 2 seconds, proceed with step 21.

If LED turns solid RED, proceed with step 11 within 5 seconds, after LED turns OFF.

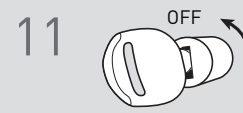

11 Turn key 1 to OFF position.

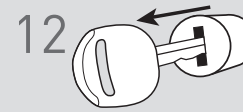

12 Remove key 1.



13 Insert key 2 into ignition.



IMPORTANT: READ NEXT PAGE !

MODULE PROGRAMMING PROCEDURE - 2 OF 2

14  Turn key 2 to ON position.

 **TIME RESTRICTION COMING UP !**

15  Wait, LED will turn solid RED then will turn OFF.

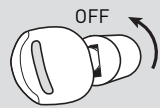
16  **TIME RESTRICTION**
Complete steps 16 to 20 within 5 seconds.
Turn key 2 to OFF position.

17  Remove key 2.

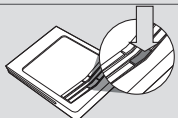
18  Press and release programming button.

19  Insert key 2 into ignition.

20  Turn key 2 to ON position.
Do not start vehicle.

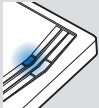
21  Wait, LED will turn solid BLUE for 2 seconds.

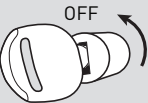
22  Turn key 2 to OFF position.

23  Remove key 2.

24
Module Programming Procedure completed.