

Overview: The initial production release of the FTI-TLK1 harness has an issue where in some vehicles the secondary power input to the CN1 connector will overload the associated vehicle circuit, causing a fuse to blow. This issue affects the initial release of harnesses and is already being addressed in production. A field correction procedure is detailed below in Figure 1.

Issue: The secondary power circuit can overload some vehicle ignition switch circuits, causing a blown 5A/7.5A AM1 fuse, potentially disabling the vehicle and leaving the consumer stranded. Affected adapters are illustrated below in figure 2.

Corrective steps:

- 1.) Select the applicable CN1 adapter, isolate the RED/WHITE power wire, cut wire approximately 4" from the BLACK plug
- 2.) Insulate the wire still connected to the WHITE plug using heat shrink tubing, and strip the insulation on the other wire end
- 3.) Strip a portion of the insulation from the RED wire, attach the stripped RED/WHITE to the exposed RED wire, solder together
- 4.) Apply insulating tape to the soldered connection and secure the cut ends back to the bundle of wires created by the adapter
- 5.) Correction complete, you may safely proceed to finish your installation

Figure 1: Step by step adapter correction

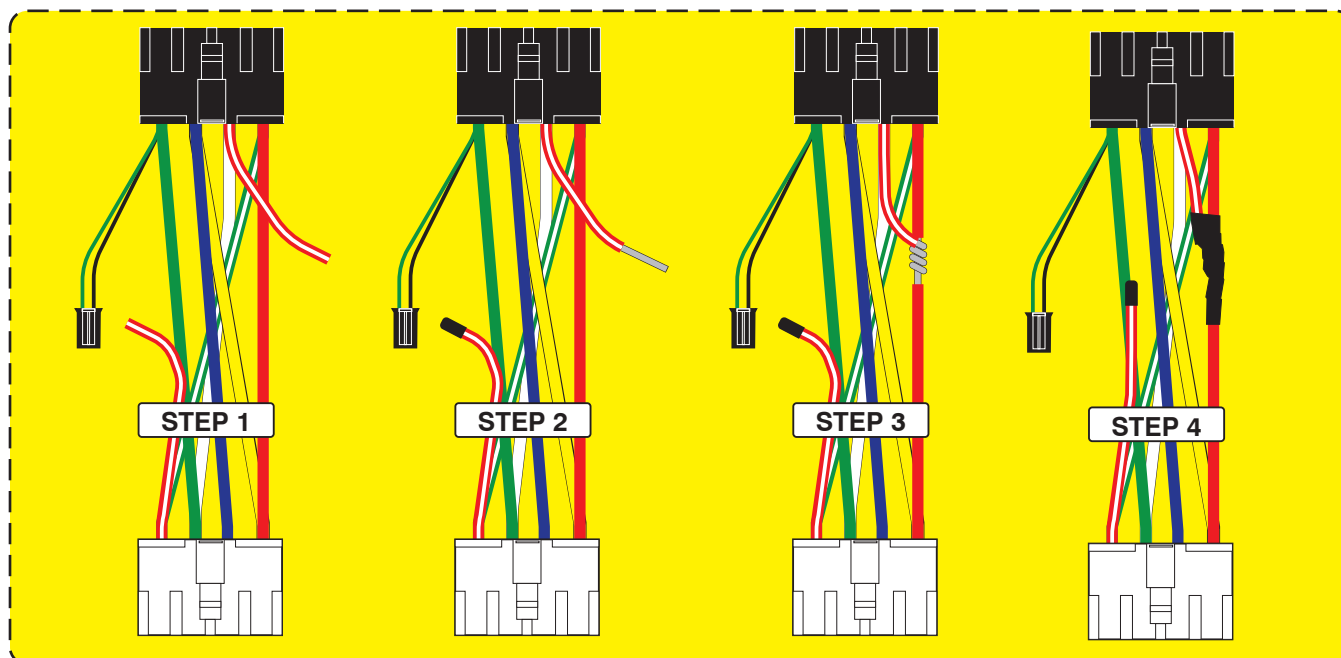
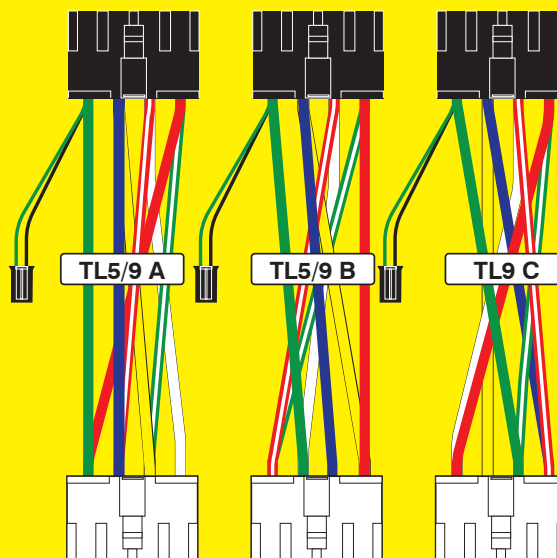

Figure 2: Supplied CN1 Harness Adapters

Incorrect power provisions with the potential to overload vehicle ignition supply circuit, resulting in blown AM1 fuse.



FTI-TLK1 Type 3A2 - Vehicle Coverage & Preparation Notes

RSTECH, L.L.C.
SUPPORT - 1 (888) 820-3690, EXT. 203

Make	Model	Year	Install	CAN	Lights	SIL	Trunk	I/O Changes
DL-TL9					Park / Auto			Green White/Blue
Toyota	Sienna 80 bit H Key	2018-19	Type 3/A	BCM	A / A	FBX/10	SW/6	

Hey! Read this stuff before you start the installation...

Firmware: Covered vehicle uses **BLADE-AL(DL)-TL9**, flash module and update the controller firmware before installing.

Type 3/A Install: Installation requires use of the **TL 5/9 A CN1** adapter, **do not attempt to use any other adapter, doing so will result in damage and malfunction.**

Lights: Type A parking lights require a connection between the **green/white** wires in the **park/auto** and **BECU** harnesses. Type A auto lights require cutting the violet **AUTO LT. A** loop on the BECU harness, connecting the loop ends to the **white/red & white/black** wires in the park/auto harness as illustrated.

TPMS: The Sienna requires an interrupt of the SIL data wire at the TPMS module (left of the fuse box) which opens a necessary communication line. Cut the wire at the TPMS module 12-pin connector, pin #10, **blue**, and connect as illustrated.

Trunk: Trunk/Hatch release requires additional wiring, connect CM (-) trunk output, or program any available POC for trunk release, and connect to either pin #6 at the hatch release switch, or the BECU 28-pin connector, pin #8, **red** wire.

If issues arise disarming the OEM alarm during remote start, set option 1-01 to 2.

Okay, now get to work...



•FT-DAS Required for manual transmission.
•BOTH Red & Red/White MUST be connected with high current application.

Jumper Setting			
Parking Light	<input type="checkbox"/>	<input type="checkbox"/>	(+)Door Trigger In
Accessory	<input type="checkbox"/>	<input type="checkbox"/>	(-)Door Trigger In (Default)
Ignition (Default)	<input type="checkbox"/>	<input type="checkbox"/>	
Trunk	<input type="checkbox"/>	<input type="checkbox"/>	Starter
Starter	<input type="checkbox"/>	<input type="checkbox"/>	Ignition
Parking Light (Default)	<input type="checkbox"/>	<input type="checkbox"/>	Accessory (Default)

CM7000/7200 **Cut loop for A/T**

CM-900S/900AS

CM900AS/900S Jumper

START
ACC
IGN1

FTI-TLK1 Type 3A2 - Installation Notes & Wiring Diagram

- A** Use TL 5/9 A CN1 adapter, any other adapter will result in malfunction and damage. Jumper connected to IMMO for equipped vehicles, if not equipped, connect to NO IMMO before programming. IGN/GND connection required.
- B** Type 3A2 installs require CAN jumper to be connected to the BCM source connector. Secure unused OBD-II connector for safety.
- C** Door lock control for this install requires connecting provided RDA wire to RDA 3 connection, secure unused RDA 1 & RDA 2 connections for safety.
- D** Type A parking lights, connect harness green/white (park/auto harness) to the green/white (BECU harness), if equipped with auto-lights, cut AUTO LT. A loop and connect as illustrated
- E** 2018-19 Sienna requires an interrupt of the SIL data wire at the TPMS module located to the left of the fuse box, failure to perform interrupt will result in failed start attempts. Connect as illustrated.

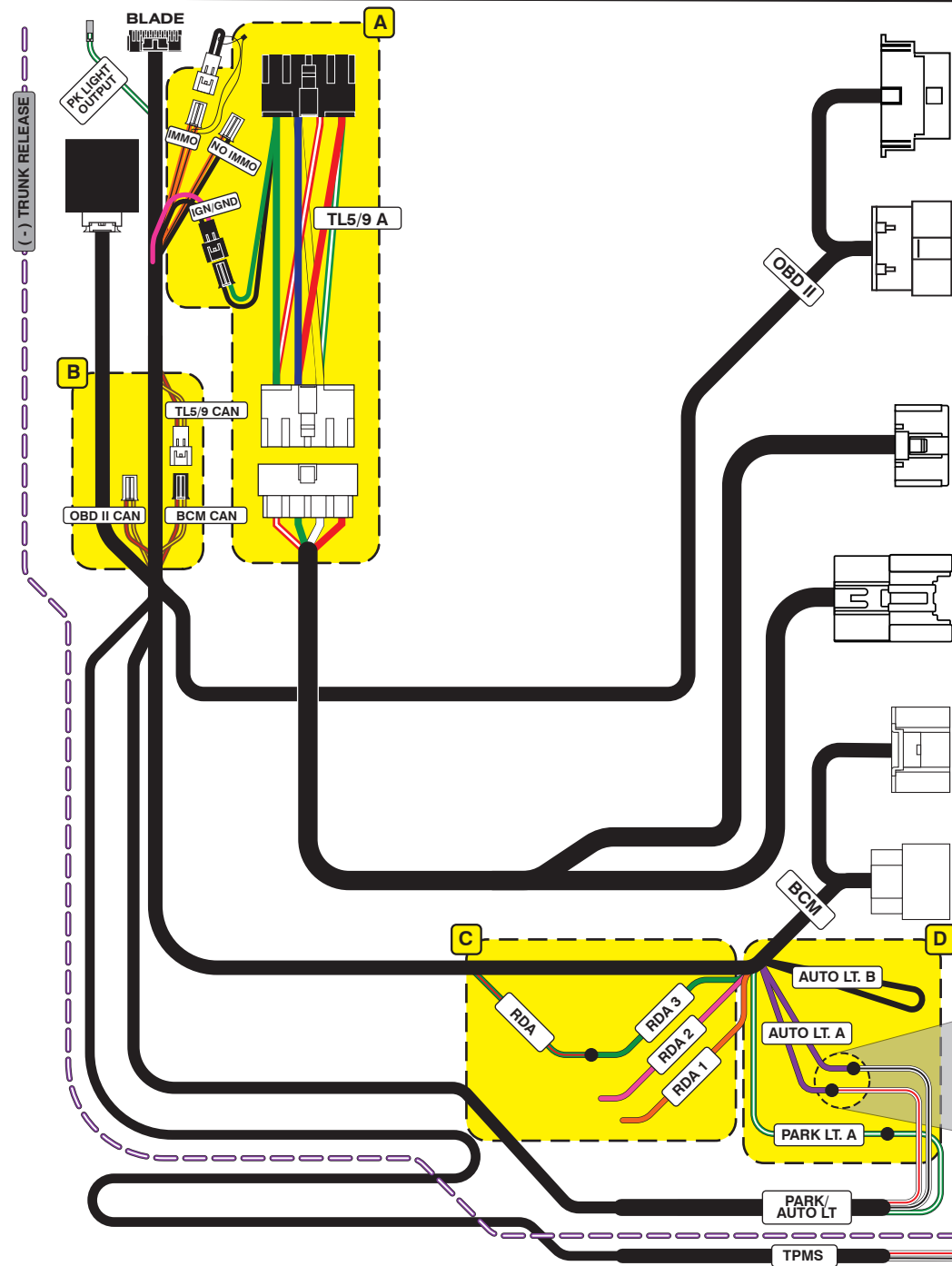

Module Programming Procedure

- Step 1 - Insert key into cylinder (Black key only, not gray)
- Step 2 - Activate ignition, LED will go solid red
- Step 3 - Wait for LED to go solid blue
- Step 4 - Deactivate ignition
- Step 5 - Programming complete

LED Programming Error Codes

Module LED flashing RED during programming

- 1x - Can error, confirm connections
- 2x - No IGN, check connections & adapter
- 3x - No IMMO, confirm connections and equipment level
- 4x - VIN error, contact engineering

IRSTECH, L.L.C.

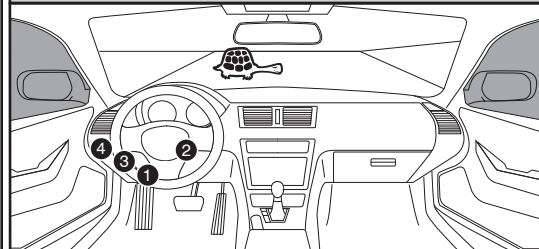

OBD-II Connector

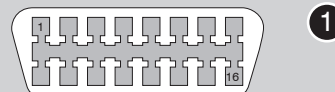

Ignition Switch

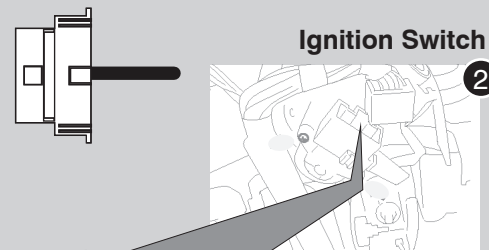

Main Body ECU

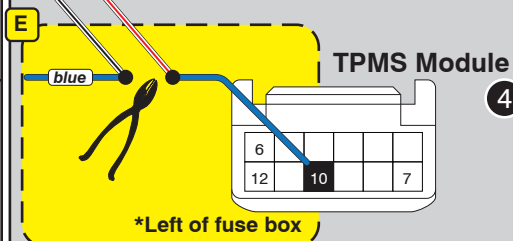
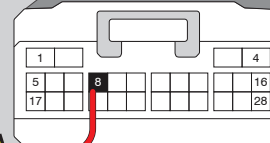
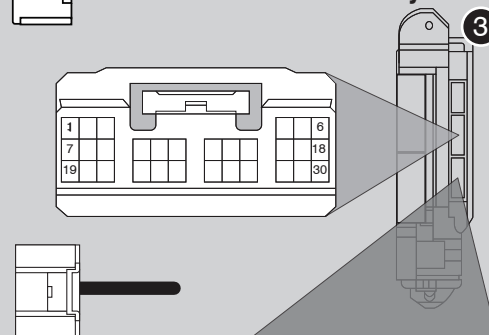

FTI-TLK1 Type 3A2

SUPPORT - 1(888) 820-3690, EXT. 203