

Make	Model	Year	Adapter/ RDA	CAN	Lights	TPMS	Trunk	I/O Changes
<b>DL-TL9</b> Toyota	Sequoia 80 bit H Key	2015-17	Type B violet (12)	OBD-II	Park / Auto Direct	GBX/10	BEUC/26	Green White/Blue NONE

**Type 5** installation requires **BLADE-AL(DL)-TL9**, flash module and update controller firmware before beginning the installation.

**Ignition Adapter:** Each installation in this firmware group requires the use of a specific adapter, use only the adapter listed above and illustrated on the next page, using any other adapter will result in malfunction and possible vehicle damage.

**CAN:** Vehicle CAN data can be gathered from either the OBD-II connector or the BCM 30-pin connector, proper configuration of the harness CAN selection jumpers is required. Configure as illustrated on the following page.

**Parking Lights:** Park light and auto-light control are handled using the pre-terminated **green/white** wire bundled with the BLADE connector. Remove the (-) pk light wire from the controller's gray I/O connector and replace it with the one specified, for status and diagnostic reporting.

**Door Locks (RDA):** Type 5 installation requires making a hardwired RDA connection to the **red (pin #12, 28-pin connector)** at the main body ECU, configure as illustrated on the next page. Make no alternate connections, and secure all unused wires for safety.

**Trunk/Hatch:** Trunk/hatch control is optional and requires additional wiring if desired (red, pin #26, 26-pin connector).

**I/O Changes:** If indicated above, change the controller output from **Parking Light** to **START:**

- CM7 controllers - move jumper 3 to STARTER position
- CMX controllers - change HCP #1 to 2ND START (setting 2)
- CM900 controllers - set feature option 1-6 to 2.

**If you encounter issues successfully disarming the OEM alarm during remote start, set option 1-01 to 2.**

## FTI-TLK80: Installation and Configuration Notes

- A** REQUIRED CONNECTION
- B** REQUIRED ADAPTER
- C** REQUIRED CONNECTIONS
- D** REQUIRED CONNECTION
- E** REQUIRED CONNECTION
- F** OPTIONAL CONNECTION



FEATURE COVERAGE																						
IMMOBILIZER DATA	PARKING LIGHTS	ARM OEM ALARM	DISARM OEM ALARM	DOOR LOCK	DOOR UNLOCK	PWR SLIDING DOOR (LEFT)	PWR SLIDING DOOR (RIGHT)	TRUNK/HATCH RELEASE	POWER SLIDING DOOR (R)	DOOR STATUS	TRUNK STATUS	HOOD STATUS	TACH OUTPUT	BRAKE STATUS	E-BRAKE STATUS	A/M ALARM CTRL FROM OEM REMOTE	A/M RS CONTROL FROM OEM REMOTE	SECURE TAKEOVER	AUTO-LIGHT CONTROL	3X LOCK REMOTE START FROM OEM	DISCO BALL	
○	○	○	○	○	○	○	○	○	○	○	○	○	○	○	○	○	○	○	○	○	○	○

•FT-DAS Required for manual transmission.  
•BOTH Red & Red/White MUST be connected with high current application.

**Jumper Setting**

Parking Light Accessory (Default)	Ignition (Default)	Trunk Starter (Default)	(+)Door Trigger In (Default)	(-)Door Trigger In (Default)	Starter Ignition	Accessory (Default)
-----------------------------------	--------------------	-------------------------	------------------------------	------------------------------	------------------	---------------------

**CM7000/7200** Cut loop for A/T

**CM900AS/900S Jumper**

START  
ACC  
IGN1

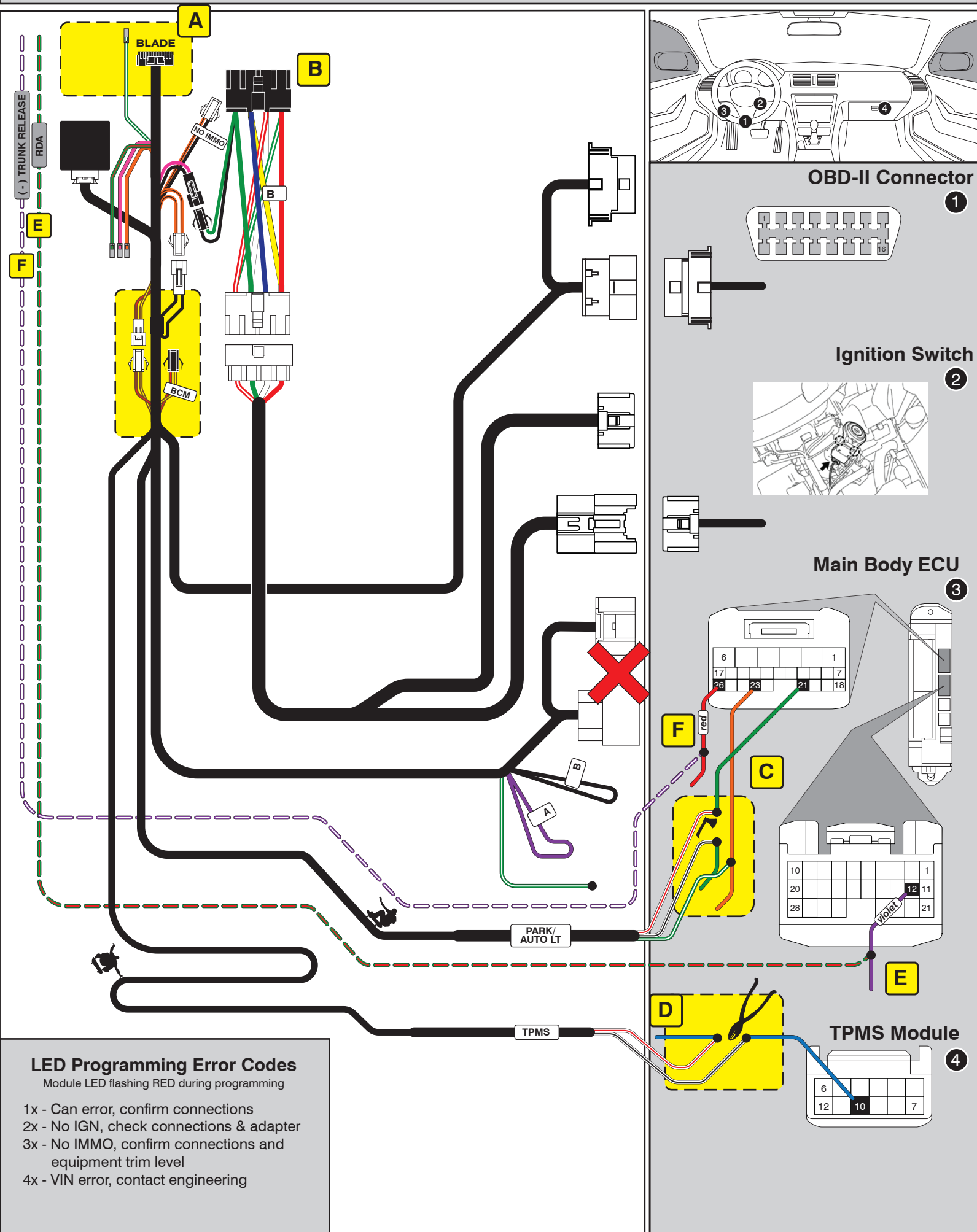

## CARTRIDGE INSTALLATION

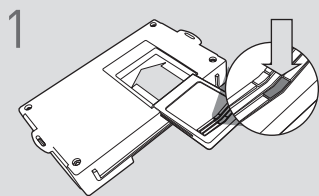

1 Slide cartridge into unit. Notice button under LED.

2

Ready for Module Programming Procedure.

## MODULE PROGRAMMING PROCEDURE

### NOTE

1 **IMPORTANT:** The hood must be closed.

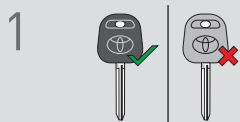

1 Use the BLACK key only. DO NOT use the GRAY valet key.

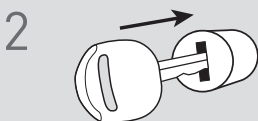

2 Insert key into ignition.



3 Turn key to ON position.

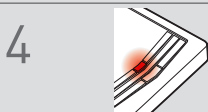

4 LED will turn solid RED.

5

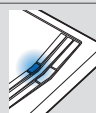

5 Wait, LED will turn solid BLUE for 2 seconds.

6

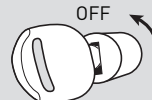

6 Turn key to OFF position.

7

7 Module Programming Procedure completed.



