

Make	Model	Year	Adapter/ RDA	CAN	Lights	TPMS	Trunk	I/O Changes
DL-TL9 Toyota	Highlander 80 bit H Key without Start Stop System	2019	Type C RDA 2	BCM	Park / Auto 1/B	NOTE	SW/4	Green White/Blue START 2

Type 2 installation requires **BLADE-AL(DL)-TL9**, flash module and update controller firmware before beginning the installation.

Ignition Adapter: Each installation in this firmware group requires the use of a specific adapter, use only the adapter listed above and illustrated on the next page, using any other adapter will result in malfunction and possible vehicle damage.

CAN: Vehicle CAN data can be gathered from either the OBD-II connector or the BCM 30-pin connector, proper configuration of the harness CAN selection jumpers is required. Configure as illustrated on the following page.

Parking Lights: Park light and auto-light control are handled using the pre-terminated **green/white** wire bundled with the BLADE connector. Remove the (-) pk light wire from the controller's gray I/O connector and replace it with the one specified, for status and diagnostic reporting.

Door Locks (RDA): Connections vary by vehicle equipment and trim level, refer to wiring diagram for specific connections. Make no alternate connections, and secure all unused wires for safety.

Trunk/Hatch: Trunk/hatch control is optional and requires additional wiring if feature control is desired. Connect as illustrated.

I/O Changes: If indicated above, change the controller output from **Parking Light** to **START**:

- CM7 controllers - move jumper 3 to STARTER position
- CMX controllers - change HCP #1 to 2ND START (setting 2)
- CM900 controllers - set feature option 1-6 to 2.

If you encounter issues successfully disarming the OEM alarm during remote start, set option 1-01 to 2.
IMPORTANT VEHICLE IDENTIFICATION INFORMATION
REGARDING START/STOP SYSEM, SEE PAGE 3.

FTI-TLK80: Installation and Configuration Notes

- A** REQUIRED CONNECTIONS
- B** REQUIRED ADAPTER
- C** REQUIRED CONFIGURATION
- D** OPTIONAL CONNECTION
- E** OPTIONAL CONNECTION



FEATURE COVERAGE																					
IMMOBILIZER DATA	PARKING LIGHTS	ARM OEM ALARM	DISARM OEM ALARM	DOOR LOCK	DOOR UNLOCK	PWR SLIDING DOOR (LEFT)	PWR SLIDING DOOR (RIGHT)	TRUNK/HATCH RELEASE	POWER SLIDING DOOR (R)	DOOR STATUS	TRUNK STATUS	HOOD STATUS	TACH OUTPUT	BRAKE STATUS	E-BRAKE STATUS	A/M ALARM CTRL FROM OEM REMOTE	A/M RS CONTROL FROM OEM REMOTE	SECURE TAKEOVER	AUTO-LIGHT CONTROL	3X LOCK REMOTE START FROM OEM	DISCO BALL

•FT-DAS Required for manual transmission.
•BOTH Red & Red/White MUST be connected with high current application.

Jumper Setting

CM7000/7200 Cut loop for A/T

CM900AS/900S Jumper

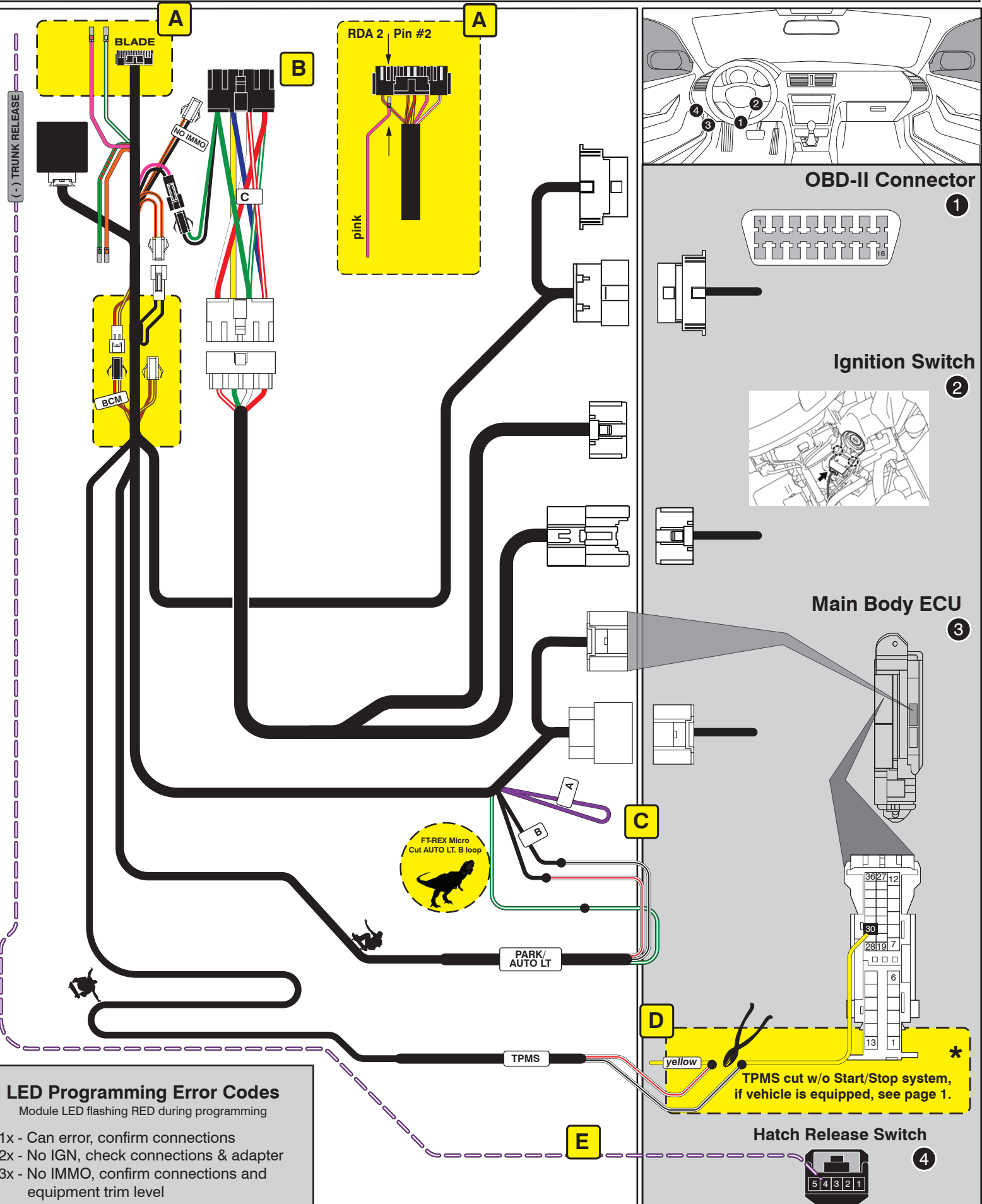

LED Programming Error Codes

Module LED flashing RED during programming

- 1x - Can error, confirm connections
- 2x - No IGN, check connections & adapter
- 3x - No IMMO, confirm connections and equipment trim level
- 4x - VIN error, contact engineering

OBD-II Connector

1

Ignition Switch

2

Main Body ECU

3

Hatch Release Switch

4

TPMS cut w/o Start/Stop system, if vehicle is equipped, see page 1.

CARTRIDGE INSTALLATION



1 Slide cartridge into unit. Notice button under LED.

2

Ready for Module Programming Procedure.

MODULE PROGRAMMING PROCEDURE

NOTE

1 **IMPORTANT:** The hood must be closed.

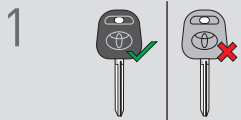

1 Use the BLACK key only. DO NOT use the GRAY valet key.

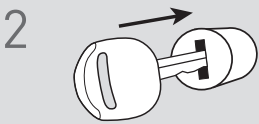

2 Insert key into ignition.



3 Turn key to ON position.

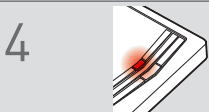

4 LED will turn solid RED.

5

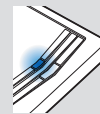

5 Wait, LED will turn solid BLUE for 2 seconds.

6

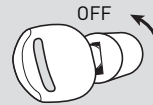

6 Turn key to OFF position.

7

7 Module Programming Procedure completed.

VEHICLES EQUIPPED WITH THE START/STOP SYSTEM

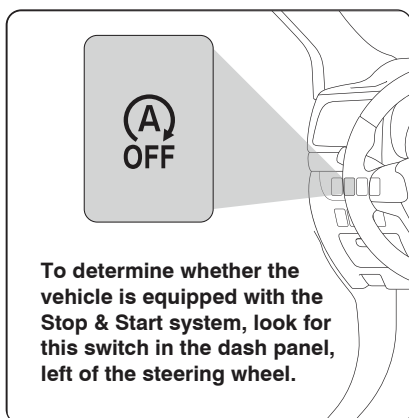

Without Stop & Start System:

Driver side, under dash, near BECU

If the vehicle is not equipped with the Stop & Start system, locate the white 36-pin connector near the BECU.

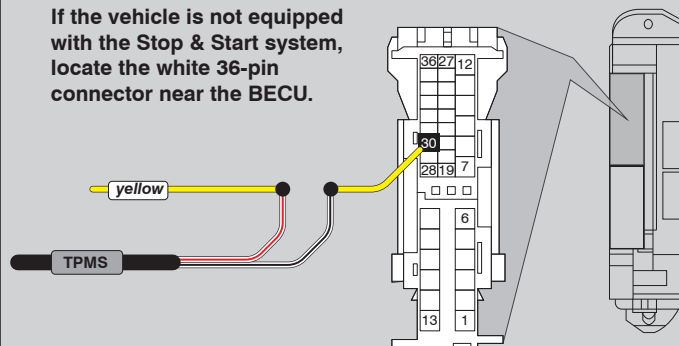

2017-18 Highlander without Stop & Start system, TPMS Ignition - Yellow, pin #30

