

Make	Model	Year	Install	CAN	Lights	BCM	Locks	Clutch
DL-NI6 Nissan	Juke PTS AT	2011-17	Type 1	CAN A	Optional VIO	NAP	Type A	Clutch Assembly

Firmware: esta instalación requiere **BLADE-AL (DL) -NI6**, módulo flash y actualizar el firmware del controlador antes de instalar.

Configuración del arnés NI-LOCK:

Las cerraduras de las puertas, la alarma OEM, las luces de emergencia y las conexiones del maletero son las que se muestran en la ilustración, no realice otras conexiones para evitar daños.

Precableado en arnés **NI-LOCK (verde / blanco)**. Los vehículos equipados con interruptor **MOMENTARY** usan POC1 configurado en la opción # 30 [Hazard1], los vehículos equipados con interruptor de **LATCHING** usan la opción # 23 [Peligro2]. Se requiere configuración de POC1, a menos que se utilicen luces de estacionamiento (+).

Parada de RAP: precableado en el arnés de la salida BLADE, conéctelo a la clavija de la puerta del conductor en el conector de 15 clavijas del BCM.

Luces de estacionamiento: (+) Las luces de estacionamiento (opcionales) están en el panel de protección del conductor, los colores de los cables varían según el modelo, las ubicaciones son las indicadas.

Lanzamiento NI-LOCK Trunk / Hatch: Conéctese solo cuando se indique, la mayoría de los vehículos NI6 incluyen cobertura de firmware de la función, solo cuando se indique específicamente, es necesario realizar una conexión analógica, o cuando la función está disponible pero el firmware falla para proporcionar el control necesario. **Característica no disponible en el Cube.**

FTI-NSP1: Notas de instalación y configuración

- A** SE REQUIERE CONEXIÓN - CONFIGURAR COMO SE ILUSTR
- B** CONEXION REQUERIDA
- C** CONEXION REQUERIDA
- D** CONEXION REQUERIDA
- E** CONEXION REQUERIDA



COBERTURA DE FUNCIONES																					
IMMOBILIZER DATA	SECURE TAKEOVER	DOOR LOCK	DOOR UNLOCK	DISARM OEM ALARM	A/M ALARM CTRL FROM OEM REMOTE	A/M RS CONTROL FROM OEM REMOTE	POWER LIFTGATE	POWER SLIDING DOOR (L)	POWER SLIDING DOOR (R)	TRUNK/HATCH RELEASE	DOOR STATUS	HOOD STATUS	TRUNK STATUS	BRAKE STATUS	TACH OUTPUT	E-BRAKE STATUS			PARKING LIGHTS	HAZARD LIGHTS	

- FT-DAS Required for manual transmission.
- BOTH Red & Red/White MUST be connected with high current application.

Jumper Setting

Parking Light	Accessory	Ignition (Default)	Trunk	Starter	Parking Light (Default)	(+)-Door Trigger In (Default)	(-)-Door Trigger In (Default)	Starter Ignition	Accessory (Default)
<input type="checkbox"/>	<input type="checkbox"/>	<input type="checkbox"/>	<input type="checkbox"/>	<input type="checkbox"/>	<input type="checkbox"/>	<input type="checkbox"/>	<input type="checkbox"/>	<input type="checkbox"/>	<input type="checkbox"/>

CM7000/7200

Cut loop for A/T

CM-900S/900AS

CM900AS/900S Jumper

START

ACC

IGN1

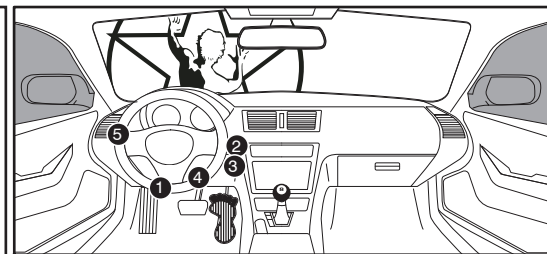
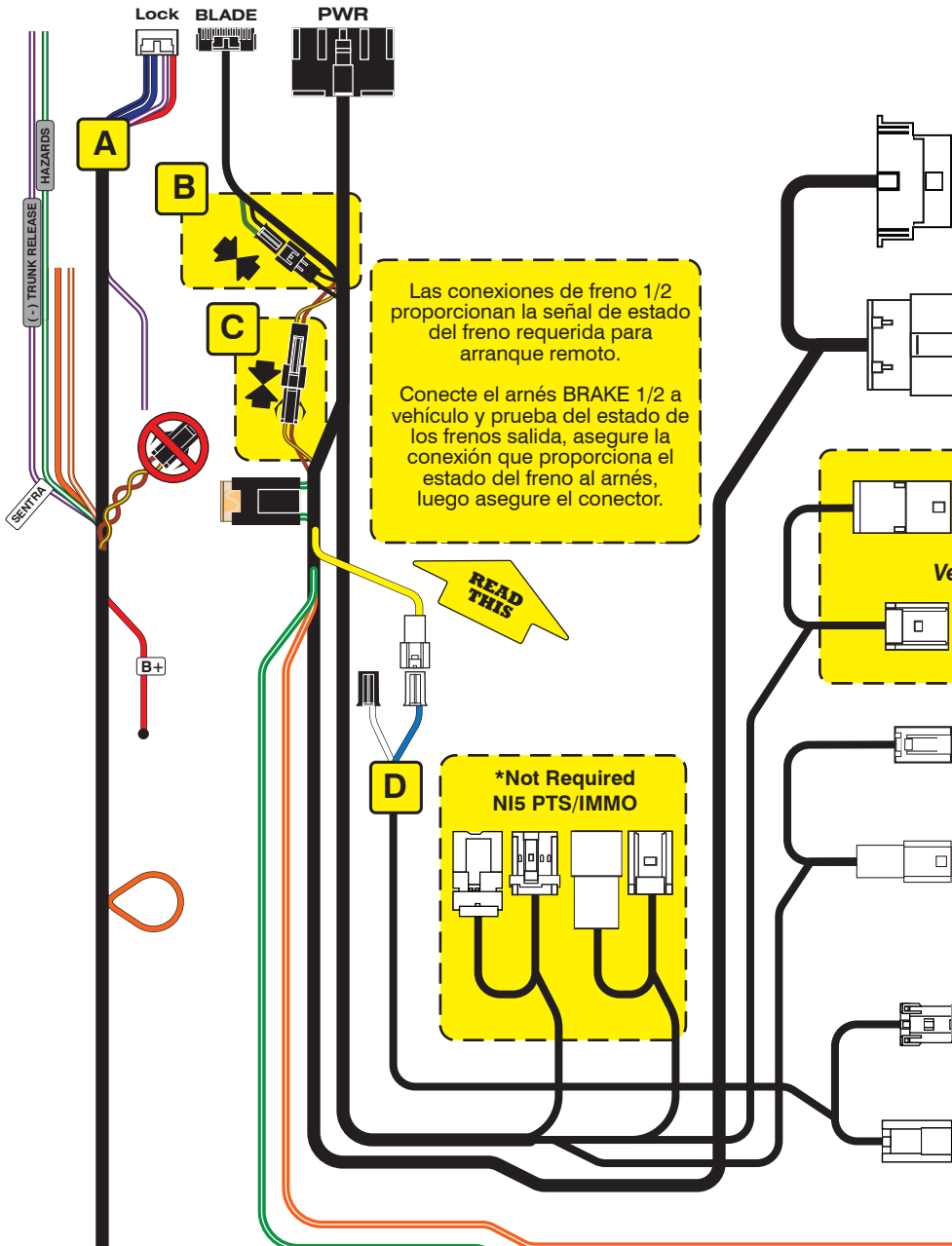

OBD-II Connector 1

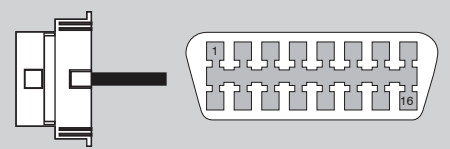

PTS Button 2



Immobilizer Connector 3



Brake Light Switch 4

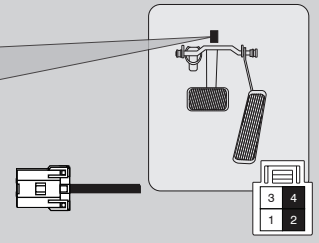

E

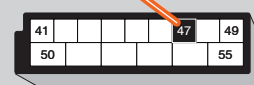

BCM 5

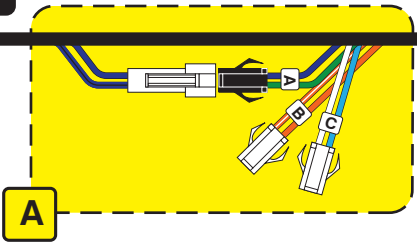
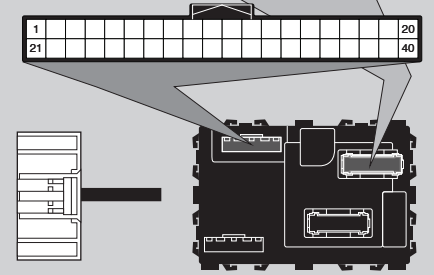

Códigos de error de programación de LED

El LED del módulo parpadea en ROJO durante la programación

- 1x - Error de CAN, confirmar conexiones
- 2x - No hay señal PTS, verifique las conexiones
- 3x - Sin IGN, verifique el voltaje en OBD-II
- 4x - Sin estado de freno, verifique las conexiones
- 5x - Sin datos del inmovilizador, solo una llave
- 6x - Sin freno, conexiones
- 7x - Sin freno, conexiones
- 8x - Sin datos del inmovilizador
- 9x - Llave diferente en uso
- 10x - Sin señal PTS
- 11x - Sin datos del inmovilizador
- 12x - Error de Klon, rehacer con las puertas cerradas
- 13x - Sin encendido

Las siguientes instalaciones de vehículos requieren modificar el FTI-NSP1 Conector PTS para realizar un arranque remoto exitoso:

- Nissan Cube 2009-14
- Nissan Juke 2011-17
- Nissan Sentra 2013-19
- Nissan Versa sedán 2013-19
- Nissan Versa Nota 2014-19

Paso 1 de la modificación (Figura 1) normal configuración del conector PTS, con el Cable de control PTS en la posición # 4 del conector de 8 pines. conector.

Esta instalación requiere una conexión al cable en la posición # 8 del conector, como se ilustra en la figura 4, a continuación. □

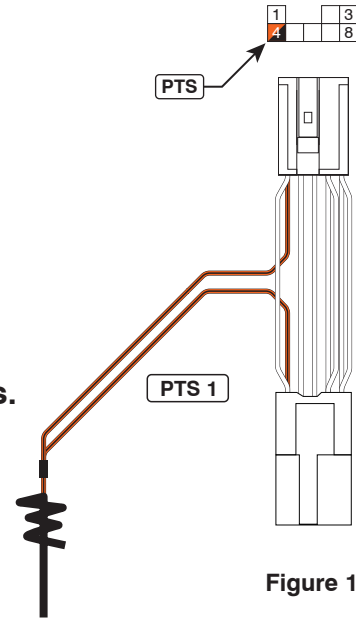

Figure 1

Paso 2 de la modificación (Figura 2), corte y pele la conexión PTS existente. Paso 3 vuelva a conectar el circuito PTS (se prefiere soldar) y aíse la conexión. Paso 4 conecte el circuito PTS del arnés al cable en el pin # 8 del botón PTS conector (se prefiere de nuevo la soldadura) y asegure las conexiones para evitar posibles daños o cortocircuitos.

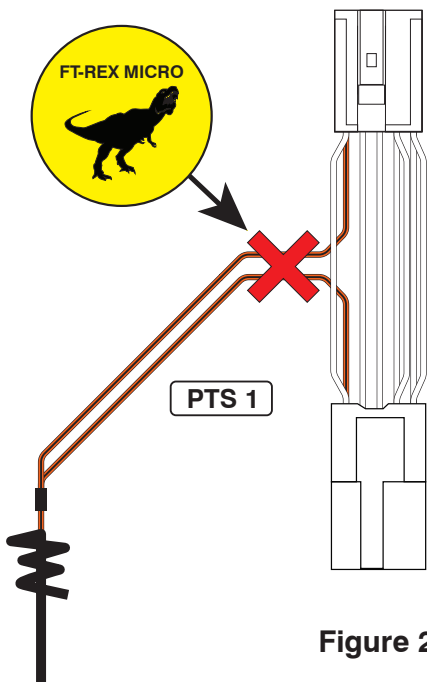

Figure 2

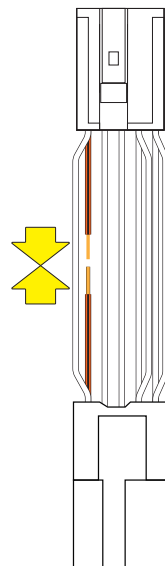

Figure 3

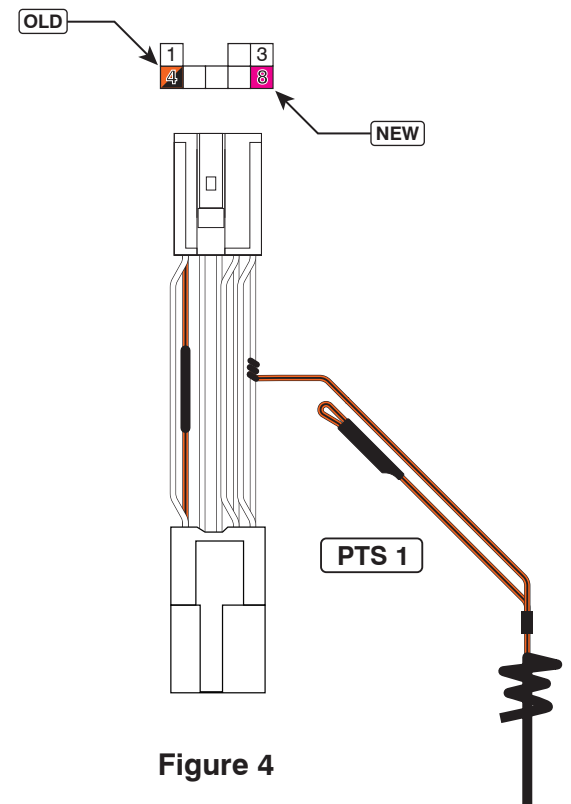
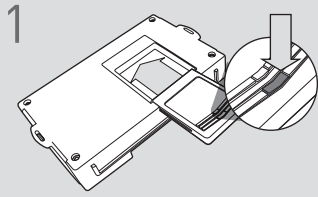

Figure 4

CARTRIDGE INSTALLATION



1 Slide cartridge into unit. Notice button under LED.

2

Ready for Module Programming Procedure.

MODULE PROGRAMMING PROCEDURE - WITH KLON - 1 OF 2

NOTE

- 1 When programming, only one key fob will be used. The other one must be located at least 10 feet away from the vehicle.

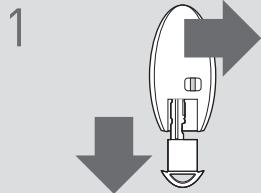

1 Remove valet key from keyfob 1.



2 Remove battery from keyfob 1.

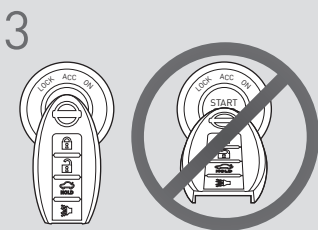

3 Place and hold keyfob 1 on push start button. (No battery)

Keyfob transponder is located behind keyfob logo.

! IMPORTANT: Place and hold keyfob 1 on push start button for steps 3 to 10.



Push start button twice [2x] to ON position.

5

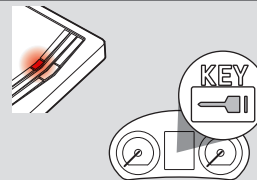

LED will turn solid RED. Wait 12 seconds or until the security light flashes. (The security light may not appear.)

6



AT: Press and release brake pedal once [1x].

MT: Press and release both brake and clutch pedals at the same time, once [1x].

7

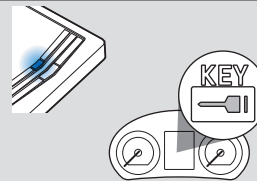

LED will turn solid BLUE. Wait 12 seconds or until the security light flashes. (The security light may not appear.)

8



AT: Press and release brake pedal once [1x].

MT: Press and release both brake and clutch pedals at the same time, once [1x].

9

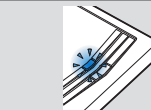

Wait, LED will flash BLUE rapidly.

10



Push start button once [1x] to OFF position.

11

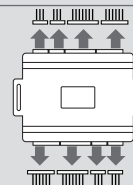

Disconnect all connectors from remote starter except the power connector.



IMPORTANT: READ NEXT PAGE !

MODULE PROGRAMMING PROCEDURE - WITH KLON - 2 OF 2

12

Disconnect the power connector.

13

Remove remote starter from vehicle.

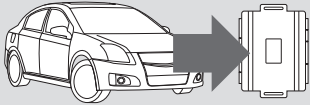

14

Connect remote starter to computer.



15

Proceed with extended programming.

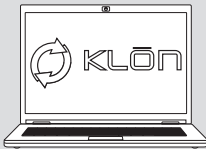

16

Connect remote starter to vehicle.



17

Place and hold keyfob 1 on push start button. (No battery)

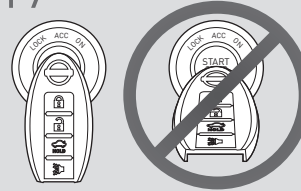

Keyfob transponder is located behind keyfob logo.

Wait until the security light turns OFF.



IMPORTANT: Place and hold keyfob 1 on push start button for steps 17 to 20.

18



Push start button twice [2x] to ON position.

19

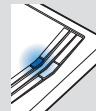

Wait, LED will turn solid BLUE for 2 seconds.

20



Push start button once [1x] to OFF position.

21

Module Programming Procedure completed.

WARNING: READ BEFORE REMOTE STARTING THE VEHICLE

IMPORTANT

- I All vehicle doors must be closed and locked prior to remote start sequence. Failure to comply will result in remote starter malfunction.

TAKE OVER PROCEDURE - PUSH TO START - TO THE VEHICLE OWNER

NOTE

- I All vehicle doors must be closed and locked prior to remote start sequence.



TIME RESTRICTION COMING UP !

1



Unlock vehicle door using OEM or after-market remote, or door request switch.

2

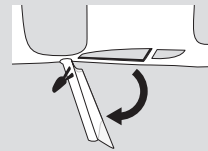

TIME RESTRICTION

Within 45 SECONDS from previous step:

Open vehicle door.
Enter vehicle.
Close vehicle door.

Press and release BRAKE pedal.

3

Take over procedure completed.



Failure to follow procedure will result in vehicle engine shutdown.