

CARTRIDGE INSTALLATION

1

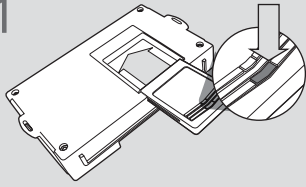

Slide cartridge into unit. Notice button under LED.

2

Ready for Module Programming Procedure.

MODULE PROGRAMMING PROCEDURE

NOTE

1 **IMPORTANT:** The hood must be closed.

1

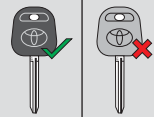

Use the BLACK key only. DO NOT use the GRAY valet key.

2

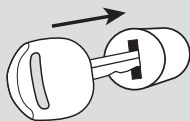

Insert key into ignition.

3

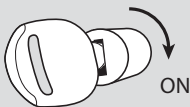

Turn key to ON position.

4

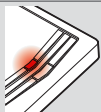

LED will turn solid RED.

5

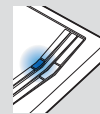

Wait, LED will turn solid BLUE for 2 seconds .

6

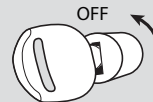

Turn key to OFF position.

7

Module Programming Procedure completed.