

Ignition Connector

1

Keysense

2

Main Body ECU

3

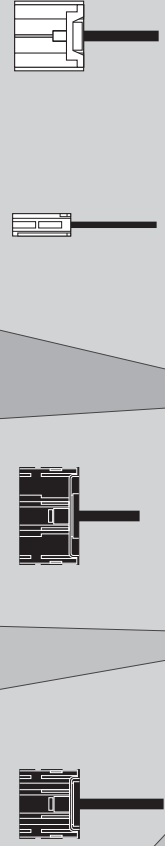

Códigos de error de programación de LED TL9

El LED del módulo parpadea en ROJO durante la programación

- 1x - No hay actividad CAN, verifique las conexiones del arnés.
- 2x - No hay encendido analógico, verifique las conexiones del mazo de cables.
- 3x - No hay datos del inmovilizador, verifique la conexión de SIL a OBD.
- 4x - VIN recibido pero no en la tabla, comuníquese con iDataLink.

CARTRIDGE INSTALLATION

1

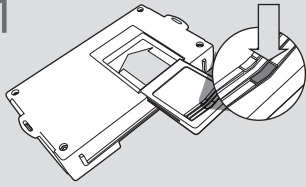

Slide cartridge into unit. Notice button under LED.

2

Ready for Module Programming Procedure.

MODULE PROGRAMMING PROCEDURE

NOTE

1 **IMPORTANT:** The hood must be closed.

1

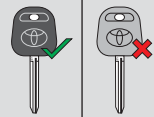

Use the BLACK key only. DO NOT use the GRAY valet key.

2

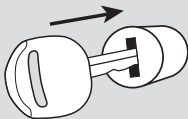

Insert key into ignition.

3

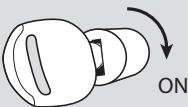

Turn key to ON position.

4

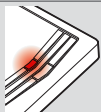

LED will turn solid RED.

5

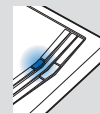

Wait, LED will turn solid BLUE for 2 seconds .

6

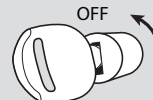

Turn key to OFF position.

7

Module Programming Procedure completed.