

FTI-TLK2: Vehicle Coverage and Preparation Notes

Make	Model	Year	Install	CAN	Lights	IMI/IMO	TPMS	I/O Changes
DL-TL9 Toyota	Camry STD Key (H)	2018-20	Type 5	ECU	Park / Auto DATA	SIL* OBD 7/16	Type 3 35/36	Green White/Blue N/A

This install requires **BLADE-AL(DL)-TL9** firmware, flash module and update the controller before beginning the installation.

CAN: CAN data connections are handled through connections at the ECU, no other connections are required.

SIL (immobilizer)/RDA: SIL data connection is made at the OBD-II connector, using the pre-terminated **orange/black** wire included with this kit. Additional modification of the harness BLADE connector is required:

Step 1.) Remove the existing orange/black wire from the harness BLADE connector, replace it with the pre-terminated wire, then connect to the **blue** SIL data wire located at pin #7 of the vehicle OBD-II connector.

Step 2.) The Camry RDA connection uses the **orange /black** wire that was removed in Step 1, by removing the **green/red** wire in the BLADE connector, and replacing it with the **orange/black**. See illustration on next page.

TPMS Ignition: The TPMS ignition wire, located in the 36-pin connector of the Main Body ECU, must be interrupted if 3X Lock control is required. If the feature is not required, and aftermarket remotes are being used, no connection is necessary.

Parking Lights: TL9 firmware handles parking lights through data, if issues arise the +parking light (green/white) can be used.

Keysense & RAP: The TLK2 harness includes pre-terminated connections for Keysense and RAP circuits.

Keysense (brown/white) is only required in manual transmission applications, insert CM I/O connector keysense position.

RAP (orange) connects to the driver door circuit, insert in any POC position and configure for RAP in the feature options.

I/O Changes: No changes are required.



FTI-TLK2: Installation and Configuration Notes

- A CONNECTIONS REQUIRED**
- B CONNECTION REQUIRED**
- C NOT REQUIRED**
- D OPTIONAL CONNECTION**
- E OPTIONAL CONNECTION**

* available only when ignition is off
** if equipped with factory hood pin switch



FEATURE COVERAGE														
<input type="checkbox"/>	<input type="checkbox"/>	<input type="checkbox"/>	<input type="checkbox"/>	<input type="checkbox"/>	<input type="checkbox"/>	<input type="checkbox"/>	<input type="checkbox"/>	<input type="checkbox"/>	<input type="checkbox"/>	<input type="checkbox"/>	<input type="checkbox"/>	<input type="checkbox"/>	<input type="checkbox"/>	<input type="checkbox"/>
IMMOBILIZER DATA	PRIORITY UNLOCK	ARM OEM ALARM	DISARM OEM ALARM	DOOR LOCK	DOOR UNLOCK	PARKING LIGHT CONTROL	POWER LIFTGATE	TRUNK/HATCH RELEASE*	DOOR STATUS	TRUNK STATUS	HOOD STATUS **	TACH OUTPUT	BRAKE STATUS	E-BRAKE STATUS

•FT-DAS Required for manual transmission.
•BOTH Red & Red/White MUST be connected with high current application.

Jumper Setting

CM7000/7200 Cut loop for A/T

CM900AS/900S Jumper

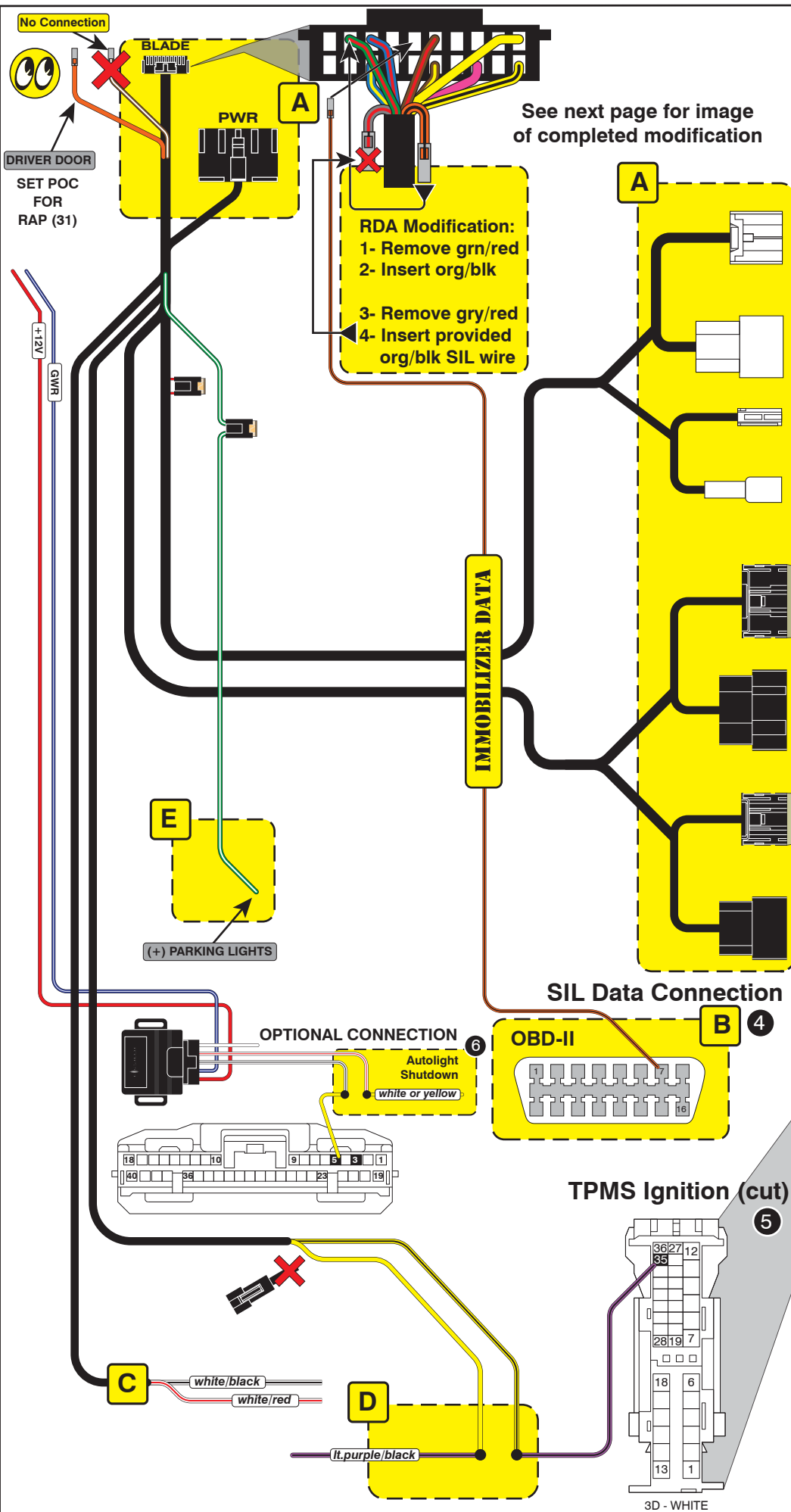

See next page for image of completed modification

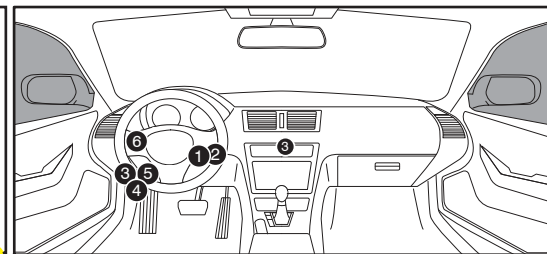

Ignition Connector ①

Keysense ②

Main Body ECU ③

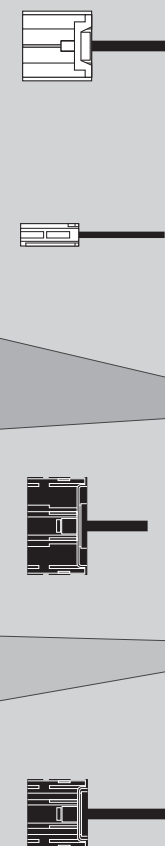

TL9 LED Programming Error Codes

- Module LED flashing RED during programming
- 1x - No CAN activity, check harness connections.
 - 2x - No analog Ignition, check harness connections.
 - 3x - No Immobilizer data, check SIL to OBD connection.
 - 4x - VIN received but not in table, contact iDataLink.

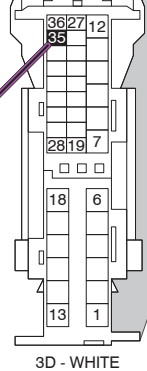

CARTRIDGE INSTALLATION

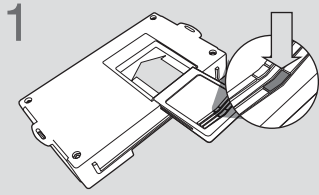

1 Slide cartridge into unit. Notice button under LED.

2

Ready for Module Programming Procedure.

MODULE PROGRAMMING PROCEDURE

NOTE

1 **IMPORTANT:** The hood must be closed.

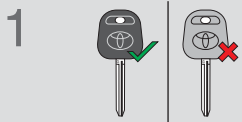

1 Use the **BLACK** key only. **DO NOT** use the **GRAY** valet key.

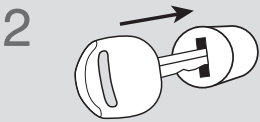

2 Insert key into ignition.



3 Turn key to ON position.

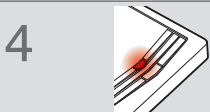

4 LED will turn solid RED.

5

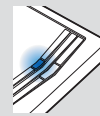

5 Wait, LED will turn solid BLUE for 2 seconds.

6

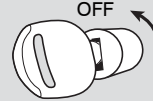

6 Turn key to OFF position.

7

7 Module Programming Procedure completed.

Completed Modification

