

Ignition Connector

1

Keysense

2

Main Body ECU

3

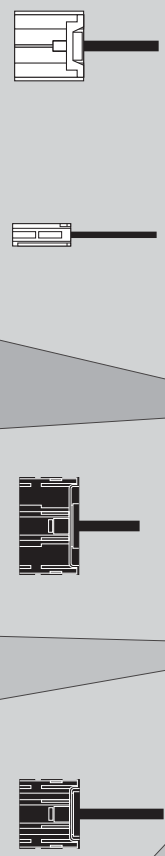

TL9 LED Programming Error Codes

- Module LED flashing RED during programming
- 1x - No CAN activity, check harness connections.
 - 2x - No analog Ignition, check harness connections.
 - 3x - No Immobilizer data, check SIL to OBD connection.
 - 4x - VIN received but not in table, contact iDataLink.

CARTRIDGE INSTALLATION

1

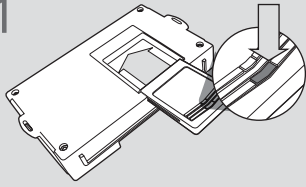

Slide cartridge into unit. Notice button under LED.

2

Ready for Module Programming Procedure.

MODULE PROGRAMMING PROCEDURE

NOTE

1 **IMPORTANT:** The hood must be closed.

1

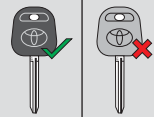

Use the BLACK key only.
DO NOT use the GRAY valet key.

2

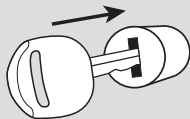

Insert key into ignition.

3

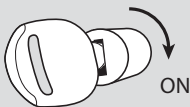

Turn key to ON position.

4

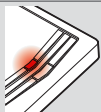

LED will turn solid RED.

5

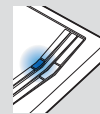

Wait, LED will turn solid BLUE for 2 seconds .

6

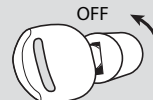

Turn key to OFF position.

7

Module Programming Procedure completed.