

Make	Model	Year	Install	IMMO	Lights	BCM	POC	I/O Changes
DL-HA3 Honda	Odyssey STD Key AT	2011-13	Type 1	Green	Park / Auto Type A	N/A	N/A	Green White/Blue N/A

Firmware:

This installation requires **BLADE-AL(DL)-HA3** firmware, flash module and update the controller firmware before the installation.

Install:

Type 1 vehicles use the **green 7-pin** immobilizer adapter. The gray immobilizer adapter and the 8-pin CN1 adapter are not used.

Lights:

(-) Parking lights and Auto-light shutoff using the included adapter requires modification of the CM I/O connector, removing the low current (-) negative status (black) and parking light (green/white) wires, replacing them with the pre-terminated wires of the adapter.

This installation uses the white **PRK LT A** connector, secure the unused PRK LT B connector.



FTI-HDK2: Installation and Configuration Notes

- A** CONNECTION REQUIRED
- B** CONNECTION REQUIRED
- C** CONNECTOR MODIFICATION REQUIRED
- D** CONFIGURATION REQUIRED
- E** NOT REQUIRED



FEATURE COVERAGE																
IMMOBILIZER DATA	AM CONTROL	DOOR LOCK	DOOR UNLOCK	ARM OEM ALARM	DISARM OEM ALARM	POWER LIFTGATE	POWER SLIDING DOOR (L)	POWER SLIDING DOOR (R)	DOOR STATUS	TRUNK STATUS	HOOD STATUS	BRAKE STATUS	E-BRAKE STATUS	TACH OUTPUT	AUTOLIGHT CTRL	PARKING LIGHTS
○	○	○	○	○	○	○	○	○	○	○	○	○	○	○	○	○

•FT-DAS Required for manual transmission.
•BOTH Red & Red/White MUST be connected with high current application.

Jumper Setting

CM7000/7200 Cut loop for A/T

CM-900S/900AS

CM900AS/900S Jumper

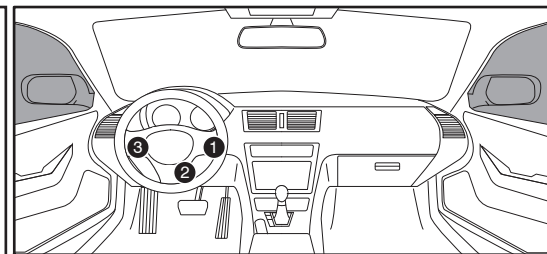
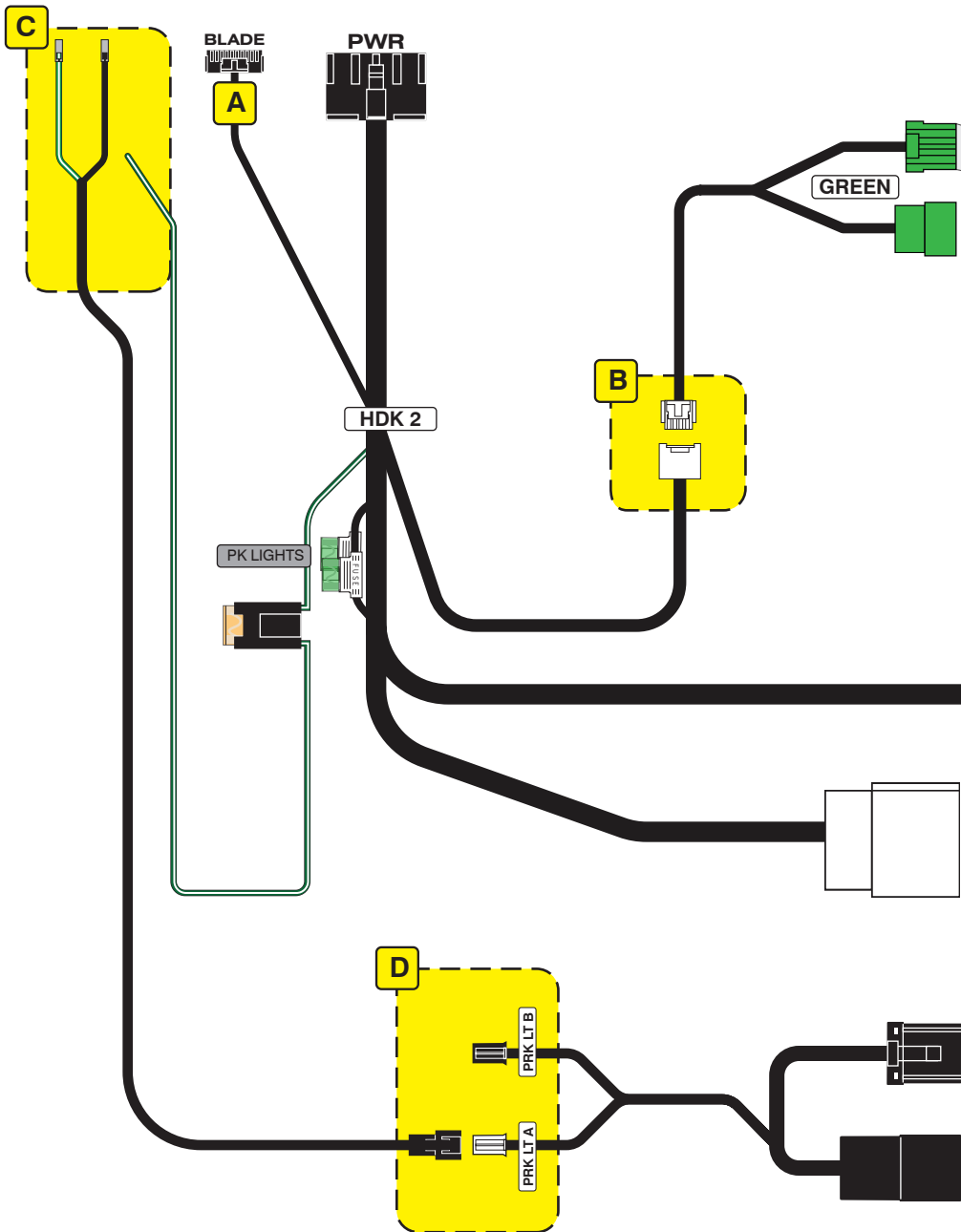

Immobilizer Connector

1

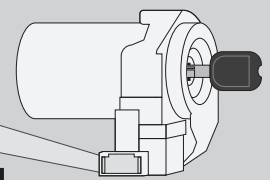

Ignition Switch

2

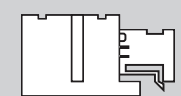

Headlight Switch Connector

3

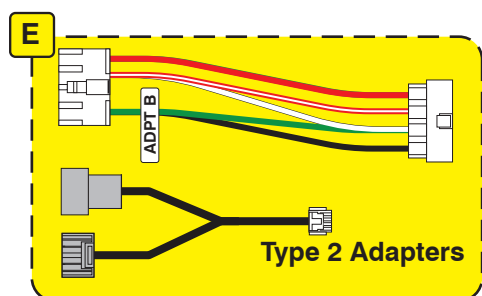
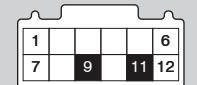

LED Programming Error Codes

Module LED flashing RED during programming
1x - CAN error, confirm connections to immobilizer adapter

CARTRIDGE INSTALLATION

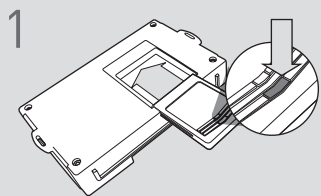

1 Slide cartridge into unit. Notice button under LED.

2

Ready for Module Programming Procedure.

MODULE PROGRAMMING PROCEDURE

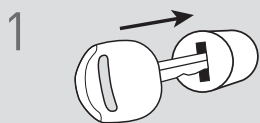

1 Insert key into ignition.



2 Turn key to ON position.



3 Wait, LED will turn solid BLUE for 2 seconds.



4 Turn key to OFF position.



5 Press UNLOCK on the OEM remote.



If the vehicle is equipped with a power liftgate: Open and close the power liftgate with the OEM keyfob.

6

Module Programming Procedure completed.