

Immobilizer Connector

1

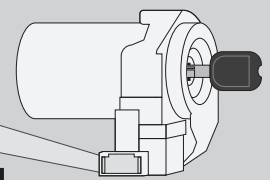

Ignition Switch

2

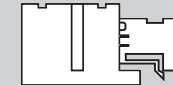

Headlight Switch Connector

3

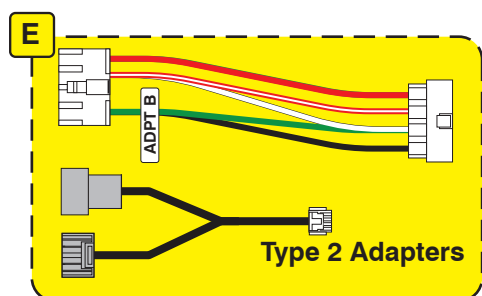
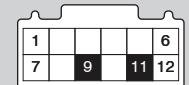

Type 2 Adapters

Códigos de error de programación de LED

El LED del módulo parpadea en ROJO durante la programación
1x - Error de CAN, confirme las conexiones al adaptador del inmovilizador

CARTRIDGE INSTALLATION

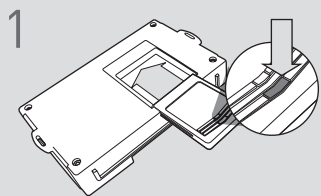

1 Slide cartridge into unit. Notice button under LED.

2

Ready for Module Programming Procedure.

MODULE PROGRAMMING PROCEDURE

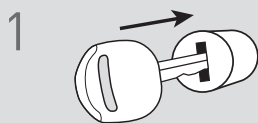

1 Insert key into ignition.



2 Turn key to ON position.



3 Wait, LED will turn solid BLUE for 2 seconds.



4 Turn key to OFF position.



5 Press UNLOCK on the OEM remote.



If the vehicle is equipped with a power liftgate: Open and close the power liftgate with the OEM keyfob.

6

Module Programming Procedure completed.