

Make	Model	Year	Install	Locks	Lights	IGN	POC	I/O Changes
DL-HA1 Honda	Odyssey STD Key	2005-10	Type 6	DATA	Park / Auto Red/Blk	Type A	N/A	Green White/Blue N/A

This installation requires **BLADE-AL(DL)-HA1**, flash module and update the controller firmware, before beginning the installation.

Lights: +12V parking light harness provision (**green/white**) connects to the vehicle at pin #19 of the green 21-pin connector, located at the front of fuse box, as illustrated.

3X Lock Remote Start Control: The HDK1 harness includes a relay to provide 3X lock control of the remote starter. The black wire labeled [STATUS] provides control of the harness relay connected to the white/red & white/black wires, which are used to interrupt the vehicle yellow keyless ignition wire during remote start. Select any POC in the CM 7/9 I/O connector, remove the original pin and replace it with the harness [STATUS] wire, set POC to STATUS (5) in the POC options.

Door Locks:

Door locks are covered via data, no additional connections required. Connect harness **orange** wire to **green/red** (pin #4, green 21-pin connector) located at the front of fuse box, connect as illustrated.

FTI-HDK1 - Installation and Configuration Notes

- A** CUT REQUIRED
- B** NOT REQUIRED
- C** CONNECTION REQUIRED
- D** CONNECTION REQUIRED FOR 3X LOCK START
- E** CONNECTION REQUIRED FOR 3X LOCK START



FEATURE COVERAGE															
IMMOBILIZER DATA															
DOOR LOCK															
DOOR UNLOCK															
ARM OEM ALARM															
DISARM OEM ALARM															
TRUNK/HATCH RELEASE															
POWER LIFTGATE															
POWER SLIDING DOOR (L)															
POWER SLIDING DOOR (R)															
DOOR STATUS															
TRUNK STATUS															
HOOD STATUS															
BRAKE STATUS															
E-BRAKE STATUS															
TACH OUTPUT															
A/M CONTROL															
AUTOLIGHT CTRL															
PARKING LIGHTS															

•FT-DAS Required for manual transmission.
•BOTH Red & Red/White MUST be connected with high current application.

Jumper Setting

CM7000/7200 Cut loop for A/T

CM-900S/900AS

CM900AS/900S Jumper

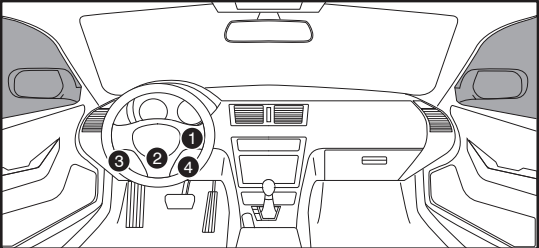
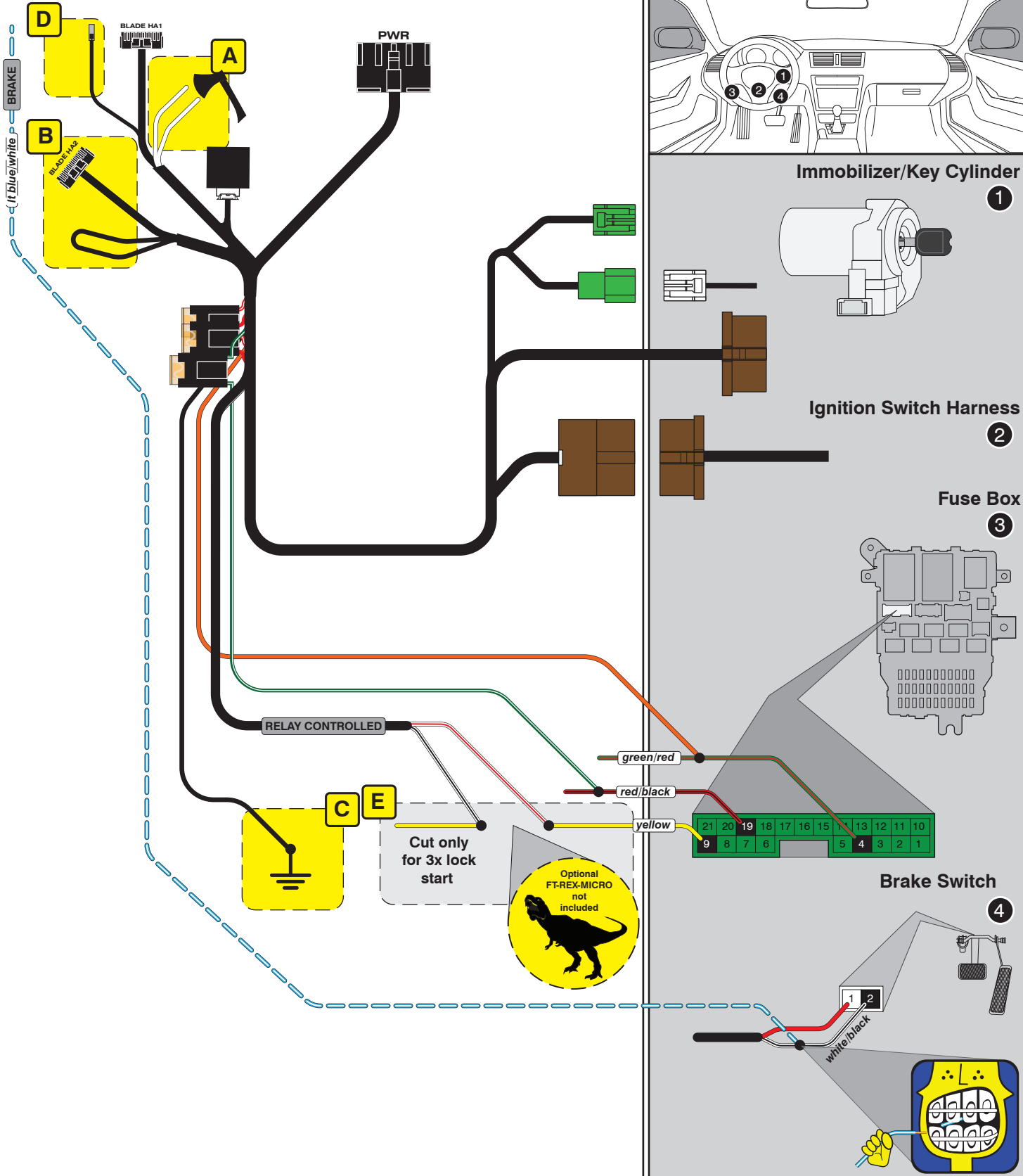

Immobilizer/Key Cylinder

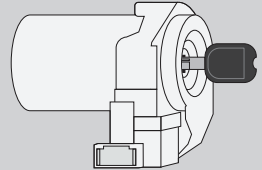

Ignition Switch Harness

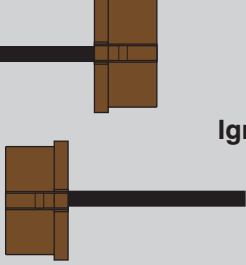

Fuse Box

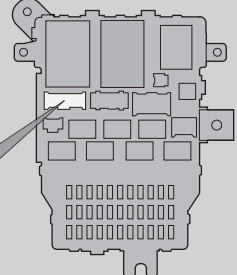

Brake Switch

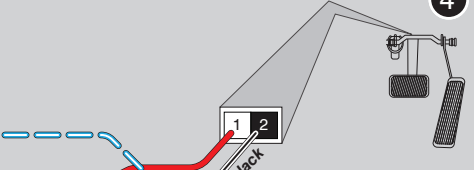

LED Programming Error Codes

- Module LED flashing RED during programming
- 1x - No SWC (doorlock) activity, check orange wire connection
 - 2x - IMMO error, check connection and harness configuration (jumpers)
 - 3x - Generic error, come on... it's a T-harness :)

CARTRIDGE INSTALLATION

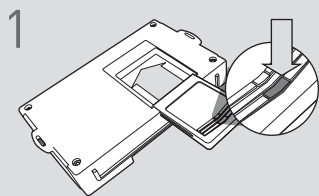

1 Slide cartridge into unit. Notice button under LED.

2

Ready for Module Programming Procedure.

MODULE PROGRAMMING PROCEDURE

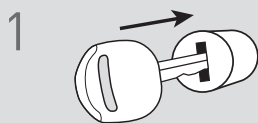

1 Insert key into ignition.



2 Turn key to ON position.

3

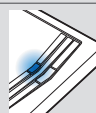

3 Wait, LED will turn solid BLUE for 2 seconds.

4

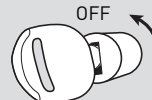

4 Turn key to OFF position.

5

5 Module Programming Procedure completed.