

**Immobilizer/Key Cylinder** 1

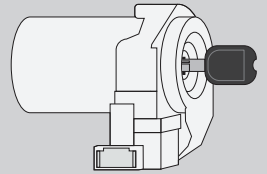

**Ignition Switch Harness** 2

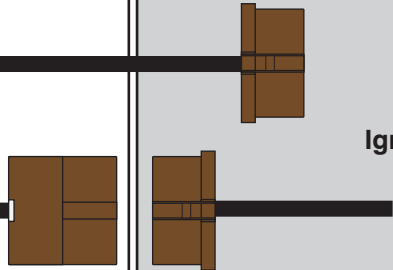

**16 Pin Connector (ADKP)** 3

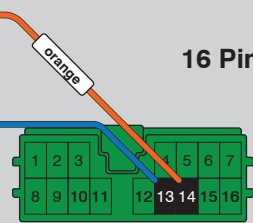

**Fuse Box** 4

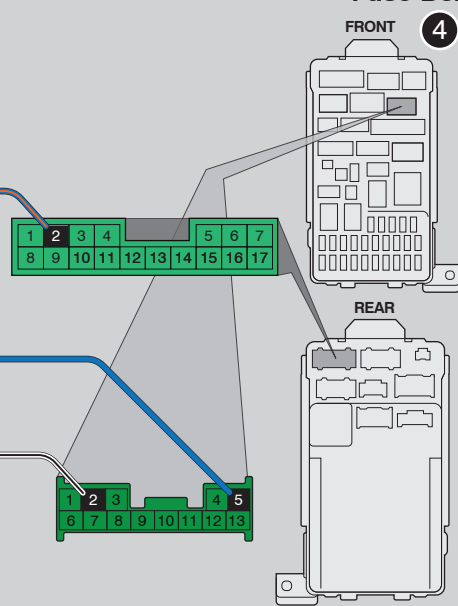

**LED Programming Error Codes**

- Module LED flashing RED during programming
- 1x - No SWC (doorlock) activity, check orange wire connection
  - 2x - IMMO error, check connection and harness configuration (jumpers)
  - 3x - Generic error, come on... it's a T-harness :)

## CARTRIDGE INSTALLATION

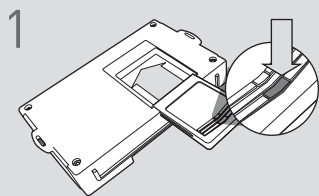

1 Slide cartridge into unit. Notice button under LED.

2

Ready for Module Programming Procedure.

## MODULE PROGRAMMING PROCEDURE

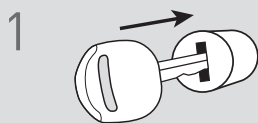

1 Insert key into ignition.



2 Turn key to ON position.

3

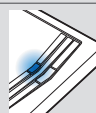

3 Wait, LED will turn solid BLUE for 2 seconds.

4

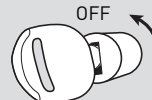

4 Turn key to OFF position.

5

5 Module Programming Procedure completed.