

Make	Model	Year	Install	Locks	Lights	IGN	POC	I/O Changes
DL-HA1 Honda	CR-V STD Key without OEM Alarm	2002-06	Type 4	Analog	Park / Auto Red/Yel	N/A	N/A	Green White/Blue N/A

This installation requires **BLADE-AL(DL)-HA1**, flash module and update the controller firmware before beginning the installation.

Lights: +12V parking light harness provision (**green/white**) connects directly to the vehicle at pin #9 of the green 10-pin connector, front of fuse box, as illustrated.

Tach: **Blue** (pin #5, green 8-pin connector) front of fuse box, connect as illustrated.

Brake: **White/black** (pin #2, green 13-pin connector) front of fuse box, connect as illustrated.

Door Locks: If the vehicle is not equipped with a factory alarm, additional wiring is required, door lock wires are as follows:

Lock: **white/blue** (pin #1, gray 22-pin connector) above driver kick panel.

Unlock: **white/green** (pin #12, gray 22-pin connector) above driver kick panel.

FTI-HDK1 - Installation and Configuration Notes

- A** CUT REQUIRED
- B** NOT REQUIRED
- C** CONNECTION REQUIRED
- D** NOT REQUIRED
- E** CONNECTIONS REQUIRED



FEATURE COVERAGE															
IMMOBILIZER DATA															
DOOR LOCK															
DOOR UNLOCK															
ARM OEM ALARM															
DISARM OEM ALARM															
TRUNK/HATCH RELEASE															
BRAKE STATUS															
TACH OUTPUT															
PARKING LIGHTS															

- FT-DAS Required for manual transmission.
- BOTH Red & Red/White MUST be connected with high current application.

Jumper Setting					
Parking Light				(+)Door Trigger In	
Accessory				(-)Door Trigger In	
Ignition (Default)					
Trunk				Starter	
Starter				Ignition	
Parking Light (Default)				Accessory (Default)	

CM7000/7200

Cut loop for A/T

CM-900S/900AS

CM900AS/900S Jumper

START
ACC
IGN1

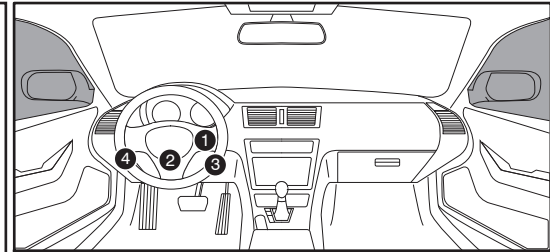
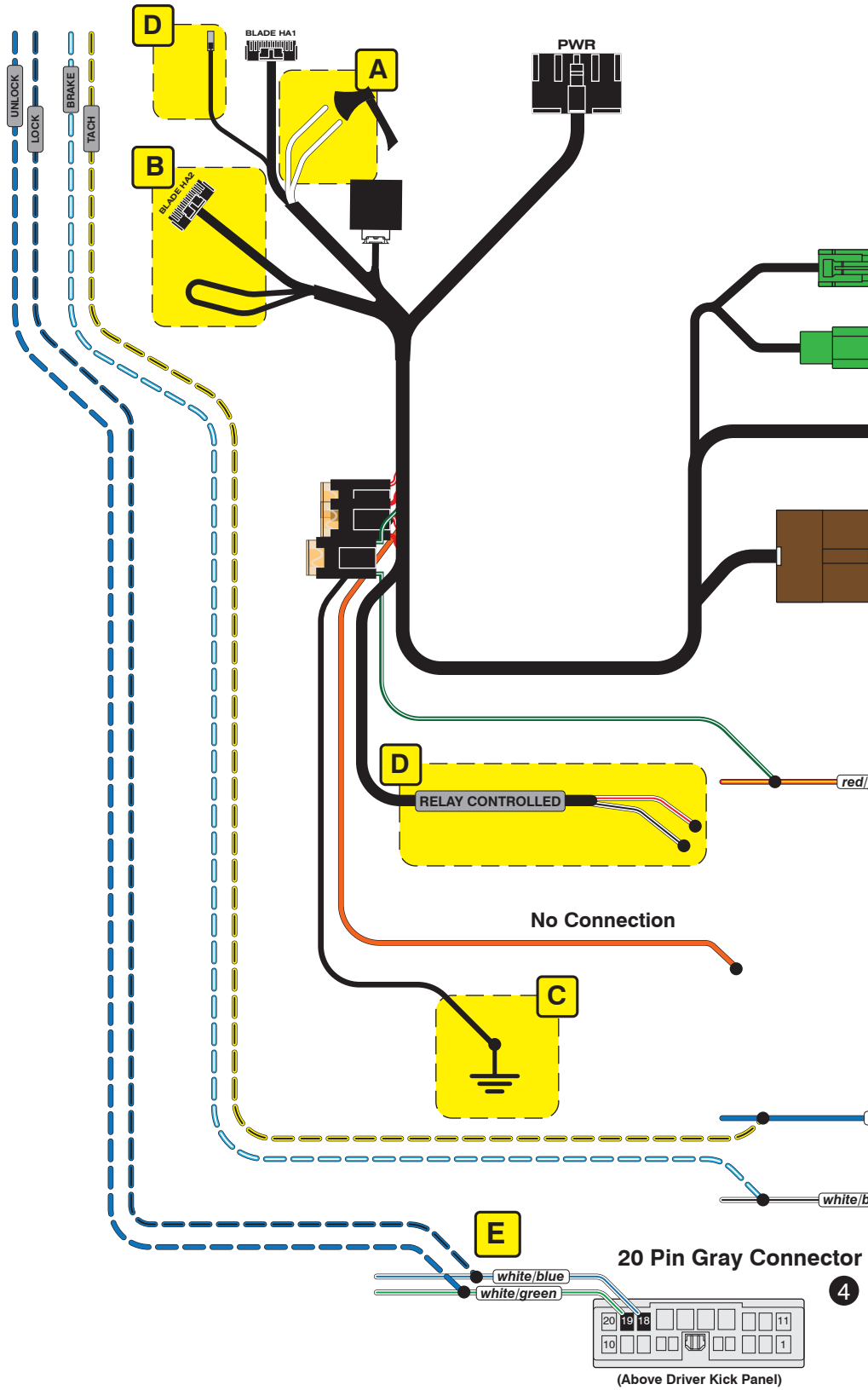

Immobilizer/Key Cylinder

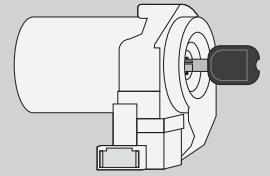

Ignition Switch Harness



Fuse Box

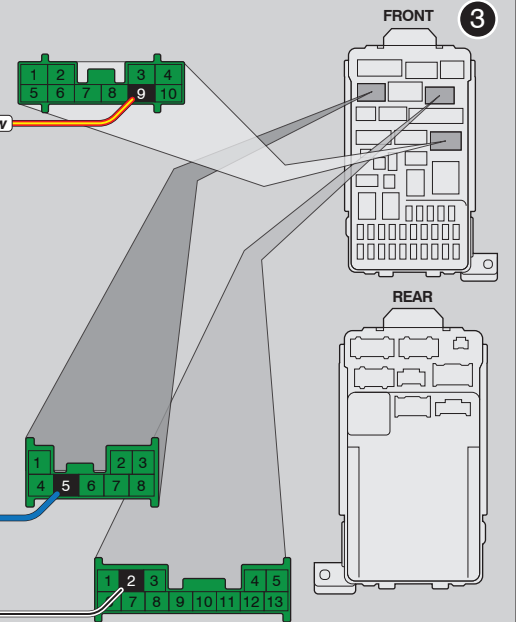

20 Pin Gray Connector

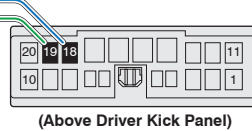

LED Programming Error Codes

Module LED flashing RED during programming

- 1x - No SWC (doorlock) activity, check orange wire connection
- 2x - IMMO error, check connection and harness configuration (jumpers)
- 3x - Generic error, come on... it's a T-harness :)

CARTRIDGE INSTALLATION

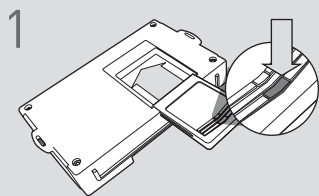

1 Slide cartridge into unit. Notice button under LED.

2

Ready for Module Programming Procedure.

MODULE PROGRAMMING PROCEDURE

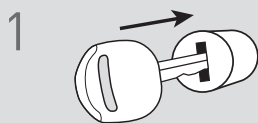

1 Insert key into ignition.



2 Turn key to ON position.

3

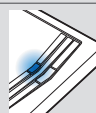

Wait, LED will turn solid BLUE for 2 seconds.

4

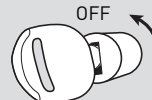

Turn key to OFF position.

5

Module Programming Procedure completed.