

# FTI-HDK1: Vehicle Coverage and Preparation Notes

Make	Model	Year	Install	Locks	Lights	IGN	POC	I/O Changes
<b>DL-HA1</b>					<b>Park / Auto</b>			<b>Green White/Blue</b>
Honda	Accord STD Key	2003-07	Type 5	DATA	Red/Blk	Type A	N/A	N/A

This installation requires **BLADE-AL(DL)-HA1**, flash module and update the controller firmware before beginning the installation.

**Lights:** +12V parking light harness provision (**green/white**) connects to the vehicle at pin #31 of the white 45-pin connector, located at the front of fuse box, as illustrated.

**3X Lock Remote Start Control:** The HDK1 harness includes a relay to provide 3X lock control of the remote starter. The black wire labeled [STATUS] provides control of the harness relay connected to the white/red & white/black wires, which are used to interrupt the vehicle yellow keyless ignition wire during remote start. Select any POC in the CM 7/9 I/O connector, remove the original pin and replace it with the harness [STATUS] wire, set POC to STATUS (5) in the POC options.

**Door Locks:**

Door locks are covered via data, no additional connections required. Connect harness **orange** wire to **brown/red** (pin #4, green 21-pin connector) front of fuse box, as illustrated.

## FTI-HDK1 - Installation and Configuration Notes

- A** CUT REQUIRED
- B** NOT REQUIRED
- C** REQUIRED CONNECTION
- D** REQUIRED CONNECTION FOR 3X LOCK START
- E** REQUIRED CONNECTION FOR 3X LOCK START



FEATURE COVERAGE															
IMMOBILIZER DATA															
DOOR LOCK															
DOOR UNLOCK															
ARM OEM ALARM															
DISARM OEM ALARM															
TRUNK/HATCH RELEASE															
DOOR STATUS															
TRUNK STATUS															
HOOD STATUS															
BRAKE STATUS															
E-BRAKE STATUS															
TACH OUTPUT															
A/M CONTROL															
AUTOLIGHT CTRL															
PARKING LIGHTS															

•FT-DAS Required for manual transmission.  
•BOTH Red & Red/White MUST be connected with high current application.

**Jumper Setting**

Parking Light Accessory	Ignition (Default)	Trunk Starter	Parking Light (Default)	(+)Door Trigger In (Default)	(-)Door Trigger In (Default)	Starter Ignition	Accessory (Default)
-------------------------	--------------------	---------------	-------------------------	------------------------------	------------------------------	------------------	---------------------

CM7000/7200 **Cut loop for A/T**

CM-900S/900AS

**CM900AS/900S Jumper**

START  
ACC  
IGN1

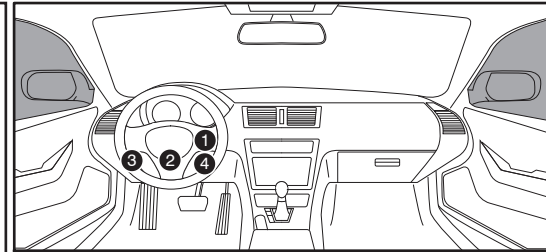
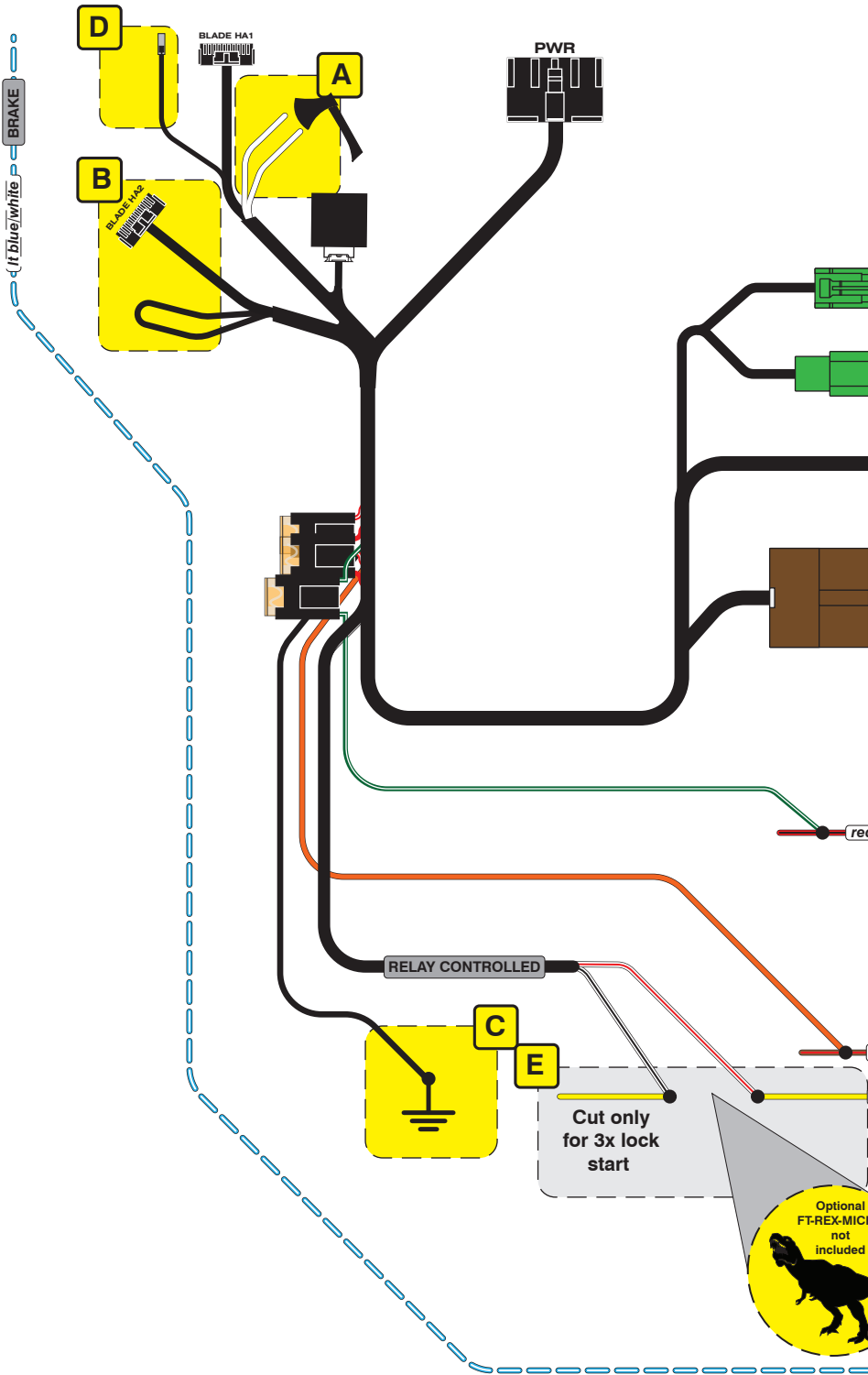

**Immobilizer/Key Cylinder**

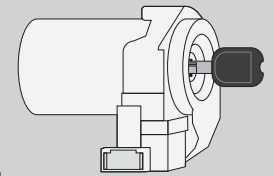

**Ignition Switch Harness**

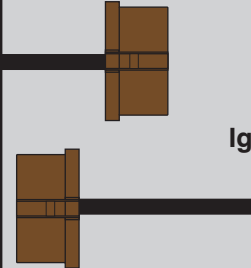

**Fuse Box**

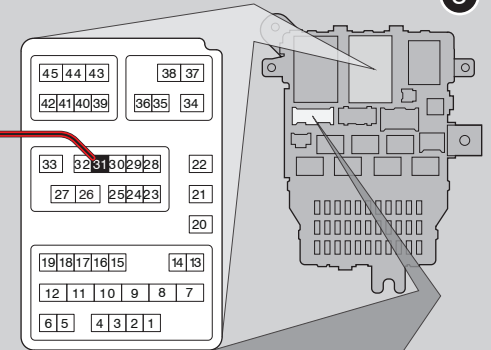

**Brake Switch**

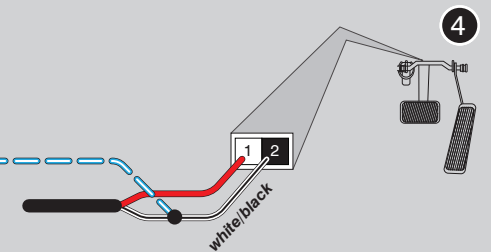

**LED Programming Error Codes**

Module LED flashing RED during programming

- 1x - No SWC (doorlock) activity, check orange wire connection
- 2x - IMMO error, check connection and harness configuration (jumpers)
- 3x - Generic error, come on... it's a T-harness :)

## CARTRIDGE INSTALLATION

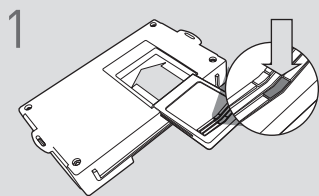

1 Slide cartridge into unit. Notice button under LED.

2

Ready for Module Programming Procedure.

## MODULE PROGRAMMING PROCEDURE

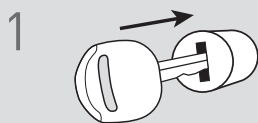

1 Insert key into ignition.



2 Turn key to ON position.

3

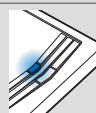

3 Wait, LED will turn solid BLUE for 2 seconds.

4

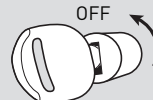

4 Turn key to OFF position.

5

5 Module Programming Procedure completed.