

Make	Model	Year	Install	CAN	Lights	Type	BCM	Configuration
DL-GM8 GMC	Terrain PTS AT	2018-20	Type 1	Type A	Park / Auto Type A	PTS	CCPS	Feature Option None

Firmware: Esta instalación utiliza **BLADE-AL(DL)-GM8**, módulo flash y actualiza el firmware del controlador antes de la instalación.

Instalación: Las fuentes de instalación de **Tipo 1** pueden obtener datos del conector **azul** del BCM, lo que requiere el uso del **conector A**, el conector marcado con "B" no se utiliza.

Luces: Se proporcionan luces de **tipo A** (luces de estacionamiento estándar), al igual que las de **tipo H** (luces de emergencia), ambas incorporadas en el arnés para visualización del estado de ejecución/diagnóstico. Es necesario volver a fijar el arnés CM I/O (gris), independientemente del tipo que elija utilizar, se han proporcionado ambas opciones para su selección. Si elige peligros, también deberá configurar el POC seleccionado para una de las siguientes opciones de control de peligros, **Hazard1 (opción de POC #30 (momentáneo)) o Hazard2 (opción de POC #23 (enclavamiento))**, dependiendo de la operación del interruptor de peligro.

Cerraduras: el conector de cerradura CM no es necesario para este tipo de instalación. Asegure según sea necesario.

NO SE REQUIERE conector de bloqueo para este tipo de instalación. :)

FTI-GMT3 - Notas de instalación y configuración

- A** CONEXIÓN REQUERIDA, VER NOTA ARRIBA
- B** CONEXIÓN NO REQUERIDA
- C** CONFIGURACIÓN REQUERIDA - CAN TIPO 'A'
- D** CONFIGURACIÓN REQUERIDA - TIPO DE CLAVE 'PTS'



COBERTURA DE FUNCIONES																					
IMMOBILIZER DATA	PRIORITY UNLOCK	DOOR LOCK	DOOR UNLOCK	ARM OEM ALARM	DISARM OEM ALARM	TRUNK/HATCH RELEASE	3X LOCK START			DOOR STATUS	TRUNK STATUS	RAP SHUTDOWN	BRAKE STATUS	E-BRAKE STATUS	TACH OUTPUT	DATA/MUX IGN/ST	HOOD STATUS	SECURE TAKEOVER	PARKING LIGHTS	HAZARD LIGHTS	
○	○	○	○	○	○	○	○			○	○	○	○	○	○	○	○	○	○	○	●

•FT-DAS Required for manual transmission.
•BOTH Red & Red/White MUST be connected with high current application.

Jumper Setting

Parking Light	Accessory	Ignition (Default)	(+)Door Trigger In (Default)	(-)Door Trigger In (Default)
Trunk	Starter	Parking Light (Default)	Starter	Ignition
			Accessory (Default)	

CM7000/7200 Cut loop for A/T

CM-900S/900AS

CM900AS/900S Jumper

START
ACC
IGN1

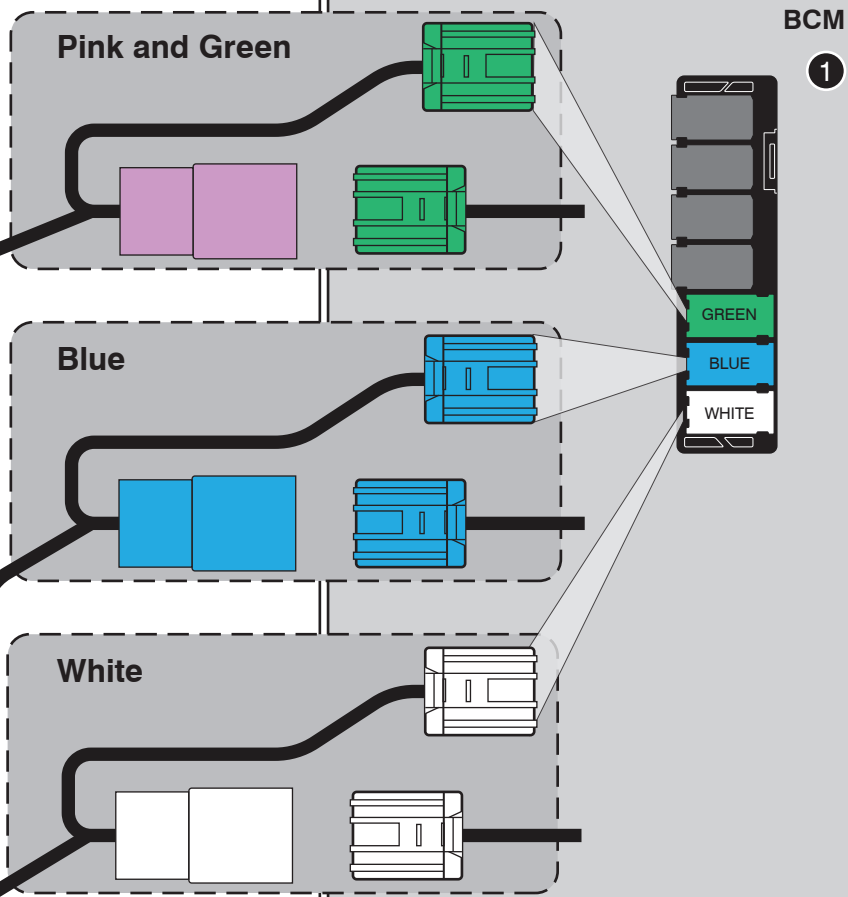
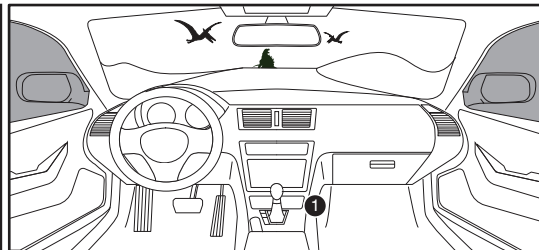
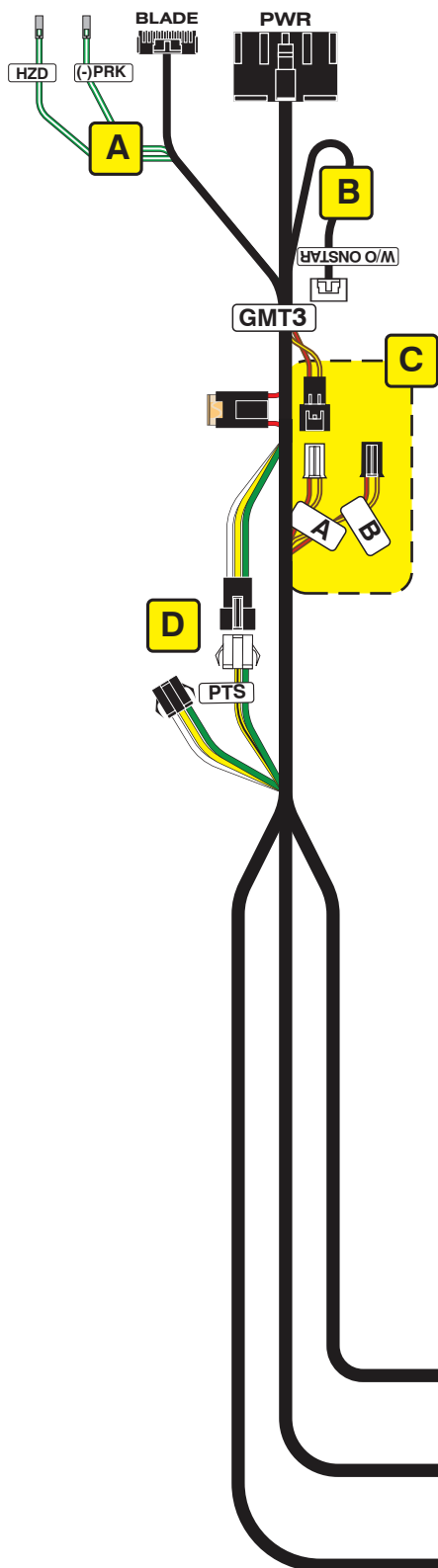

Códigos de error de programación de LED

El LED del módulo parpadea en ROJO durante la programación

- 1x - Sin datos SWC, verifique el conector AZUL y la selección CAN
- 2x - Sin datos del inmovilizador, confirme los conectores VERDE y BLADE
- 3x - Sin HS CAN
- 4x - Sin encendido, verifique el conector AZUL y la selección CAN
- 5x - el VIN no coincide con los datos del enlace web
- 6x - Sin datos del inmovilizador, verifique el conector VERDE o mantenga IGN
- 7x - error de datos del inmovilizador, confirme solo con una tecla
- 8x - Sin datos del inmovilizador, verifique los conectores VERDE y BLADE
- 9x - Error de datos del inmovilizador, ver arriba
- 10x - Error de datos de Klon, restablecer módulo y repetir programación
- 11x - Sin encendido, verifique el conector AZUL y la selección CAN

CARTRIDGE INSTALLATION

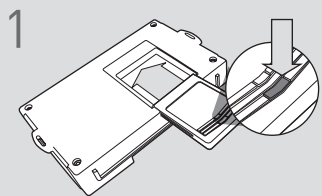

1 Slide cartridge into unit. Notice button under LED.

2

Ready for Module Programming Procedure.

MODULE PROGRAMMING PROCEDURE

NOTE

- 1 When programming, only one key fob will be used. The other one must be located at least 10 feet away from the vehicle.

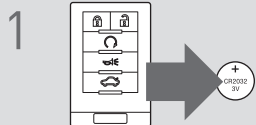
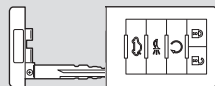

1 Remove battery from key fob.

Place key fob on key reader in armrest or center console.

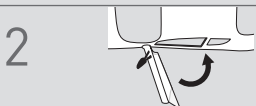

2 Close driver door.



Re-open driver door to wake up data bus.



3 Push start button twice [2x] (or press start button 5 seconds) to ON position.

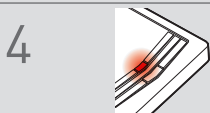

4 Wait, LED will turn solid RED.

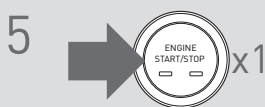

5 Push start button once [1x] to OFF position.

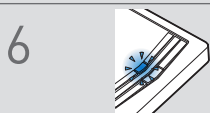

6 Wait, LED will flash BLUE rapidly.

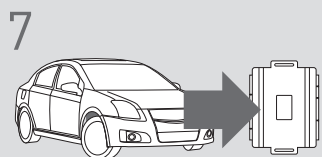

7 **WARNING:**
Disconnect power last.
Disconnect RS from vehicle.

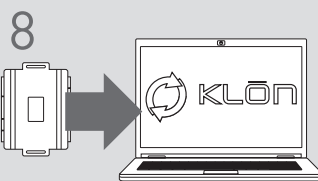

8

Connect RS to computer and proceed with extended programming.

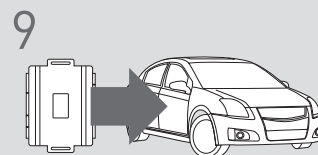

9

WARNING: Do not press RS programming button.
Connect power first.
Connect RS to vehicle.



10

Push start button twice [2x] (or press start button 5 seconds) to ON position.



11

Wait, LED will turn solid BLUE for 2 seconds.

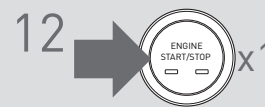

12

Push start button once [1x] to OFF position.

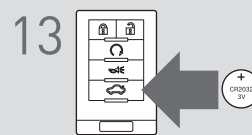

13

Remove key fob from key reader.



Insert battery in key fob.



If the vehicle is equipped with a power liftgate:
Open and close the power liftgate with the OEM keyfob.

14

Module Programming Procedure completed.

WARNING: READ BEFORE REMOTE STARTING THE VEHICLE

IMPORTANT

- I All vehicle doors must be closed and locked prior to remote start sequence. Failure to comply will result in remote starter malfunction.

TAKE OVER PROCEDURE - TO THE VEHICLE OWNER

NOTE

- I All vehicle doors must be closed and locked prior to remote start sequence.



TIME RESTRICTION COMING UP !

1



Press unlock on OEM or aftermarket remote or request switch.

2

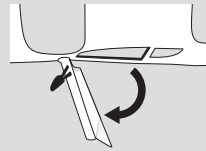

TIME RESTRICTION

Within 45 SECONDS from previous step:

Open vehicle door.
Enter vehicle.
Close vehicle door.

Press and release BRAKE pedal.

3

Take over procedure completed.



Failure to follow procedure within time restriction will result in vehicle engine shutdown.