

FIRSTECH, LLC.
SUPPORT • 1(888) 820-3690, EXT. 203

| FEATURE COVERAGE | |
|---------------------|---|
| IMMOBILIZER DATA | ● |
| PRIORITY UNLOCK | ● |
| DOOR LOCK | ● |
| DOOR UNLOCK | ● |
| ARM OEM ALARM | ● |
| DISARM OEM ALARM | ● |
| TRUNK/HATCH RELEASE | ● |
| XX LOCK START | ● |
| | |
| | |
| DOOR STATUS | ● |
| TRUNK STATUS | ● |
| TRAP SHUTDOWN | ● |
| BRAKE STATUS | ● |
| E-BRAKE STATUS | ● |
| HATCH OUTPUT | ● |
| DATA/MUX IGN/ST | ● |
| HOOD STATUS | ● |
| SECURE TAKEOVER | ● |
| PARKING LIGHTS | ● |
| HAZARD LIGHTS | ● |
| | |

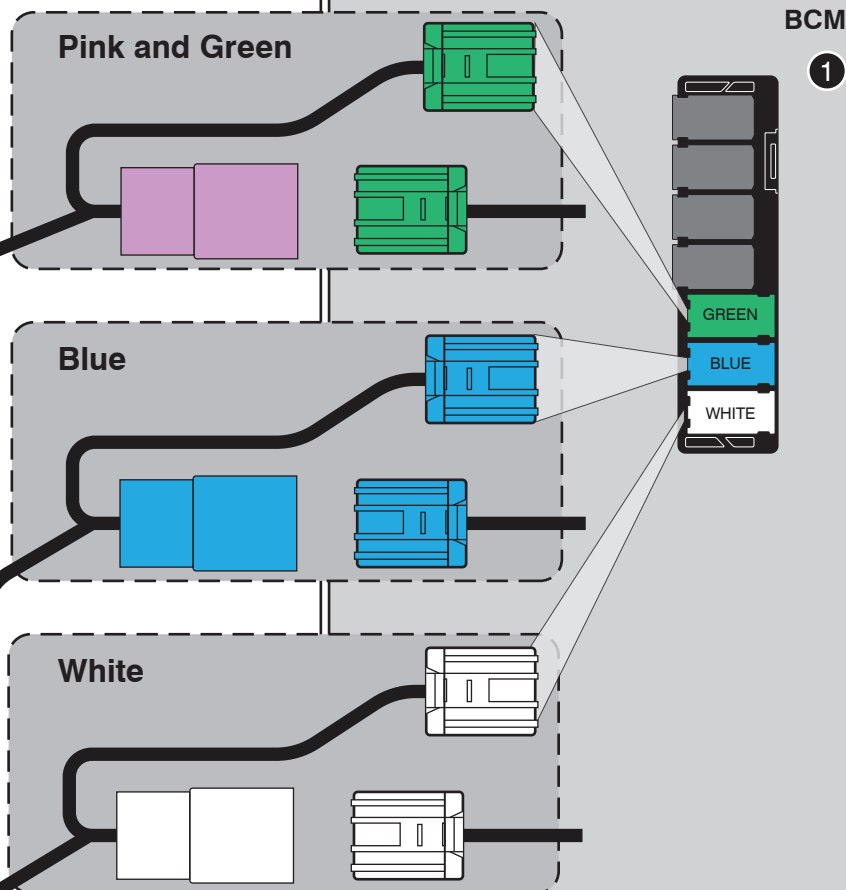
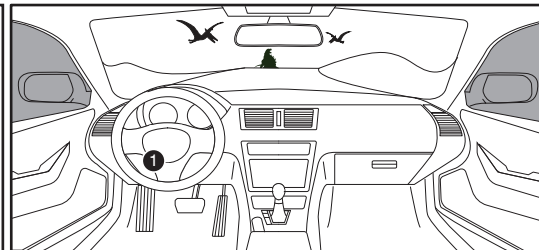
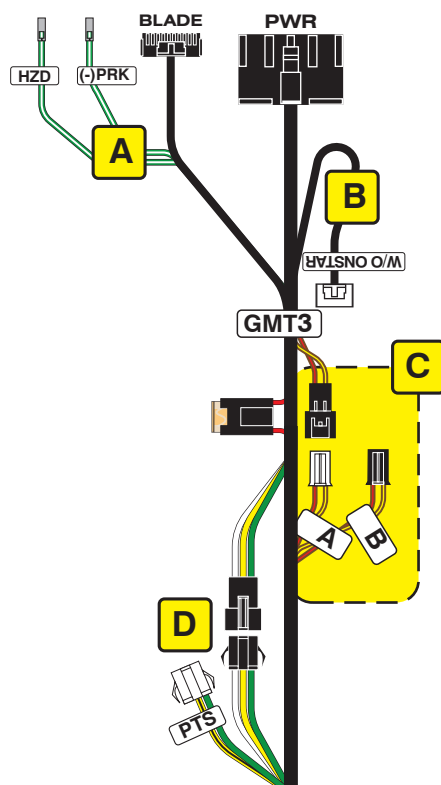

LED Programming Error Codes

Module LED flashing RED during programming

- 1x - No ACC power, check GREEN connector
- 2x - MUX status not detected, check GREEN connector
- 3x - No IGN, check GREEN connector
- 4x - No HSCAN activity, check BLUE connector
- 5x - No SWC activity, check BLUE connector
- 6x - Wrong SWC message, confirm key has been removed
- 7x - No ACC power, check GREEN connector
- 8x - No immobilizer data, check GREEN & BLADE connectors
- 9x - IGN ON, confirm key has been removed
- 10x - Keysense active, confirm key has been removed
- 11x - No ACC, confirm key is on
- 12x - No IGN, confirm key is on
- 13x - VIN not matching Weblink data, contact engineering

CARTRIDGE INSTALLATION

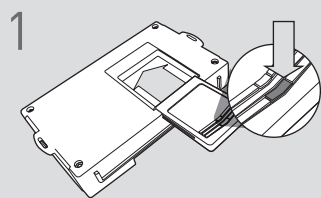

Slide cartridge into unit. Notice button under LED.

2

Ready for Module Programming Procedure.

MODULE PROGRAMMING PROCEDURE - WITH KLON

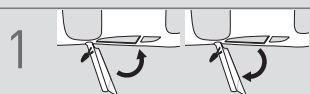

Close driver door.
Re-open driver door to wake up data bus.

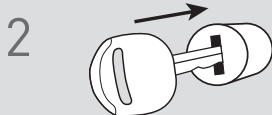

Insert key into ignition.



Turn key to ON position.

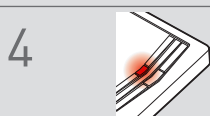

Wait, LED will turn solid RED.



Turn key to OFF position.

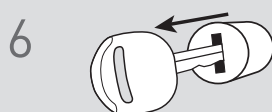

Remove key.



LED will turn OFF.

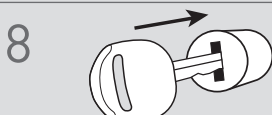

Insert key into ignition.



Turn key to ON position.



Wait, LED will flash BLUE rapidly.



Turn key to OFF position.

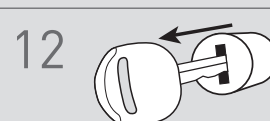

Remove key.

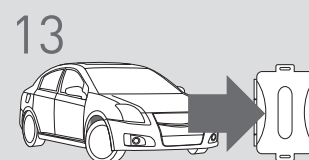

WARNING:
Disconnect power last.
Disconnect module from vehicle.

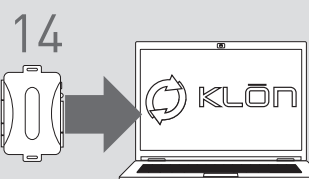

Connect module to computer
and proceed with extended
programming.

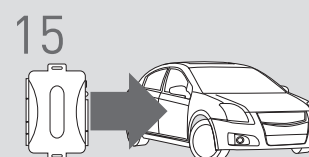

WARNING: Do not press module
programming button.
Connect power first.
Connect module to vehicle.

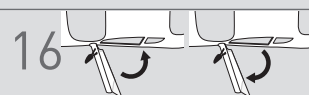

Close driver door.
Re-open driver door to wake up
data bus.



Turn key to ON position.



Wait, LED will turn solid BLUE
for 2 seconds.



Turn key to OFF position.

20

Module Programming
Procedure completed.