

Códigos de error de programación de LED

El LED del módulo parpadea en ROJO durante la programación

- 1x - Sin alimentación ACC, verifique el conector VERDE
- 2x - Estado MUX no detectado, verificar conector VERDE
- 3x - Sin IGN, verifique el conector VERDE
- 4x - Sin actividad HSCAN, verifique el conector AZUL
- 5x - Sin actividad SWC, verifique el conector AZUL
- 6x - mensaje SWC incorrecto, se ha eliminado la clave de confirmación
- 7x - Sin alimentación ACC, verifique el conector VERDE
- 8x - Sin datos del inmovilizador, verifique los conectores VERDE Y BLADE
- 9x - IGN ENCENDIDO, la clave de confirmación ha sido eliminada
- 10x - Keysense activo, confirmar clave ha sido eliminada
- 11x - Sin ACC, la tecla de confirmación está activada
- 12x - Sin IGN, la tecla de confirmación está activada
- 13x - VIN no coincide con los datos del enlace web, póngase en contacto con el departamento de ingeniería

CARTRIDGE INSTALLATION



1 Slide cartridge into unit. Notice button under LED.

2

Ready for Module Programming Procedure.

MODULE PROGRAMMING PROCEDURE - WITH KLON



1 Close driver door. Re-open driver door to wake up data bus.



2 Insert key into ignition.



3 Turn key to ON position.



4 Wait, LED will turn solid RED.



5 Turn key to OFF position.

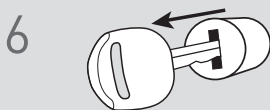

6 Remove key.



7 LED will turn OFF.

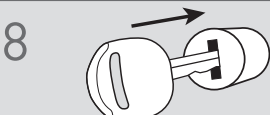

8 Insert key into ignition.



9 Turn key to ON position.

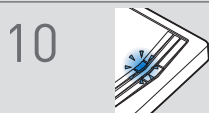

10 Wait, LED will flash BLUE rapidly.



11 Turn key to OFF position.



12 Remove key.



13 **WARNING:**
Disconnect power last.
Disconnect module from vehicle.

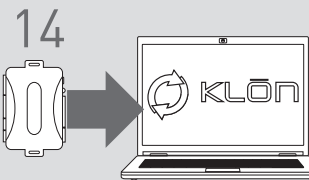

14 Connect module to computer and proceed with extended programming.



15 **WARNING:** Do not press module programming button.
Connect power first.
Connect module to vehicle.

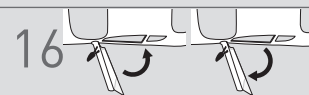

16 Close driver door. Re-open driver door to wake up data bus.



17 Turn key to ON position.



18 Wait, LED will turn solid BLUE for 2 seconds.

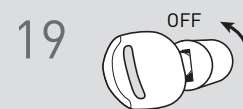

19 Turn key to OFF position.

20

Module Programming Procedure completed.