





## CARTRIDGE INSTALLATION



1 Slide cartridge into unit. Notice button under LED.

2

Ready for Module Programming Procedure.

## MODULE PROGRAMMING PROCEDURE - WITH KLON



1 Close driver door. Re-open driver door to wake up data bus.



2 Insert key into ignition.



3 Turn key to ON position.



4 Wait, LED will turn solid RED.



5 Turn key to OFF position.

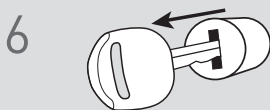

6 Remove key.



7 LED will turn OFF.

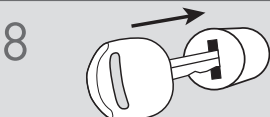

8 Insert key into ignition.



9 Turn key to ON position.

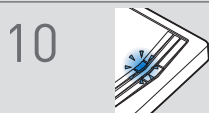

10 Wait, LED will flash BLUE rapidly.



11 Turn key to OFF position.



12

Remove key.

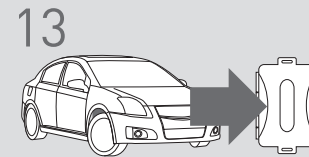

13

**WARNING:**  
Disconnect power last.  
Disconnect module from vehicle.

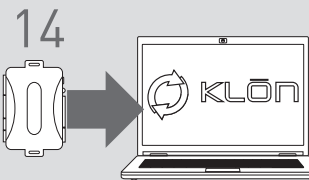

14

Connect module to computer and proceed with extended programming.

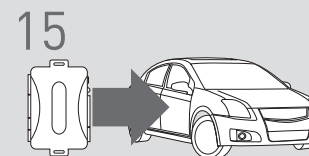

15

**WARNING:** Do not press module programming button.  
Connect power first.  
Connect module to vehicle.

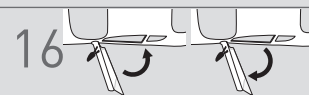

16

Close driver door. Re-open driver door to wake up data bus.



17

Turn key to ON position.



18

Wait, LED will turn solid BLUE for 2 seconds.



19

Turn key to OFF position.

20

Module Programming Procedure completed.