

# FTI-GMT3: Vehicle Coverage and Preparation Notes

Make	Model	Year	Install	CAN	Lights	Type	BCM	Configuration
<b>DL-GM12</b> Chevrolet	Silverado 1500 LD Key AT (old body style) w/o OnStar with OEM Alarm	2019	Type 1 + Locks	Type A	Park / Auto Type A	Key	LSC	Feature Option Opt 1-11 to 3

**Firmware:** This installation uses **BLADE-AL(DL)-GM12**, flash module and update the controller firmware before installing.

**Install:** **Type 1** installation sources CAN data from the blue connector of the BCM, requiring the use of the '**A-connector**', the connector marked 'B' is not used.

**Lights:** **Type A** lights (standard parking lights) are provided, as are **Type H** (hazard lights), both incorporated in the harness for visual display of runtime status/diagnostics. Re-pinning of the CM I/O (gray) harness is required, regardless of which type you choose to use, both options have been provided for your selection. If you choose hazards you will also need to configure the selected POC for one of the following hazard control options, **Hazard1** (POC option #30 (momentary) **or** **Hazard2** (POC option #23 (latching)), depending on hazard switch operation.

**Locks:** The CM lock connector is mandatory for this installation type. The harness assembly is pre-wired provide the necessary analog control.

**ACC configuration:** **No Onstar/OEM Alarm** install requires an ACC pulse with disarm, to properly control the equipped OEM alarm system. **Set feature option 1-11 to option 3 (ACC pulse, same timing as disarm pulse)**

**Lock connector is REQUIRED for this installation type. :)**

**Configuration of feature option 3-11 to option 3 (ACC pulse, same timing as disarm) is REQUIRED. :)**

## FTI-GMT3 - Installation and Configuration Notes

- A** REQUIRED CONNECTION, SEE NOTE ABOVE
- B** REQUIRED CONNECTION
- C** REQUIRED CONFIGURATION - TYPE A
- D** REQUIRED CONFIGURATION - KEY TYPE
- E** REQUIRED SETTINGS CHANGE



FEATURE COVERAGE														
IMMOBILIZER DATA														
DOOR LOCK														
DOOR UNLOCK														
ARM OEM ALARM														
DISARM OEM ALARM														
3X LOCK START														
DOOR STATUS														
RAP SHUTDOWN														
BRAKE STATUS														
E-BRAKE STATUS														
TACH OUTPUT														
DATA/MUX IGN/ST														
HOOD STATUS														
SECURE TAKEOVER														
PARKING LIGHTS														
HAZARD LIGHTS														

•FT-DAS Required for manual transmission.  
•BOTH Red & Red/White MUST be connected with high current application.

Jumper	Setting
Parking Light	(+)Door Trigger In
Accessory	(-)Door Trigger In
Ignition (Default)	(Default)
Trunk	Starter
Starter	Ignition
Parking Light (Default)	Accessory (Default)

**CM7000/7200** **Cut loop for A/T**

**CM-900S/900AS**

**CM900AS/900S Jumper**

**START**  
**ACC**  
**IGN1**

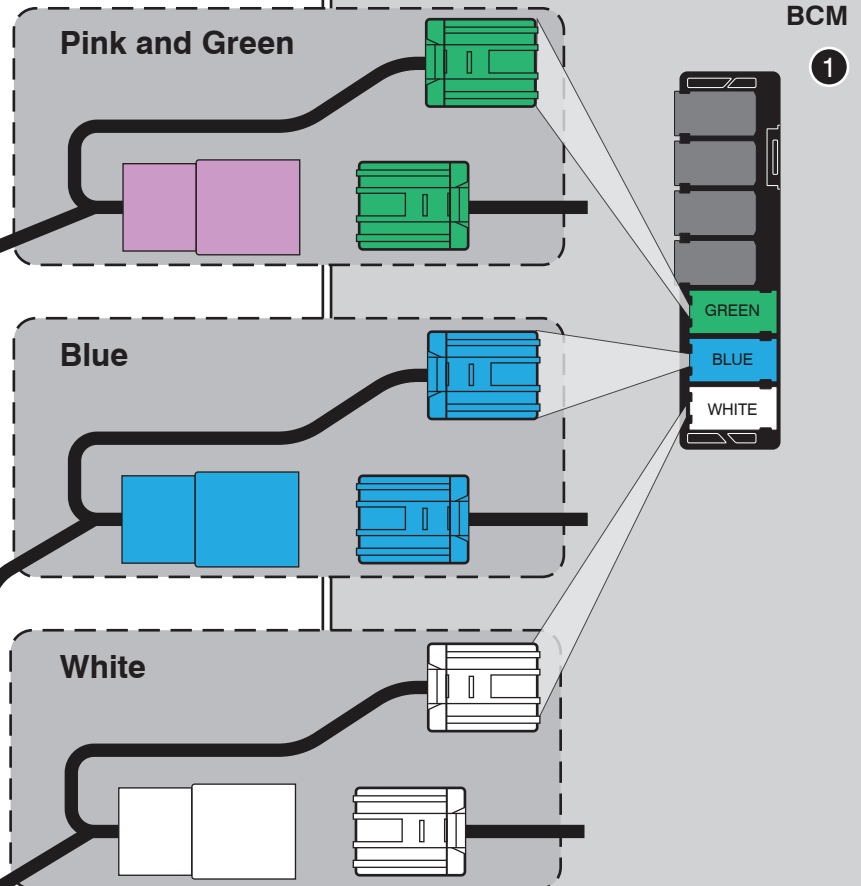
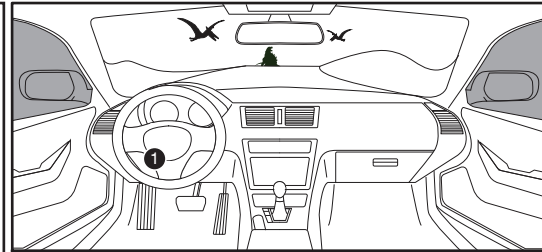
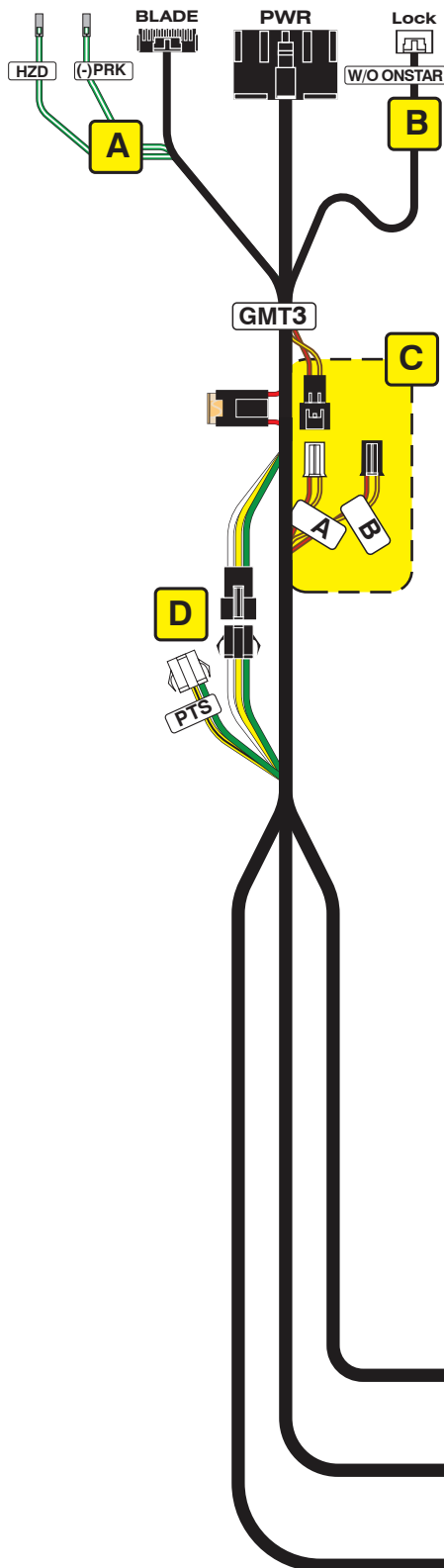
**E**

**No Onstar/OEM Alarm** install requires an ACC pulse with disarm to properly control the OEM alarm system. **Set feature option 1-11 to option 3 (ACC pulse, same timing as disarm pulse)**

### LED Programming Error Codes

Module LED flashing RED during programming

- 1x - No ACC power, check GREEN connector
- 2x - MUX status not detected, check GREEN connector
- 3x - No IGN, check GREEN connector
- 4x - No HSCAN activity, check BLUE connector
- 5x - No SWC activity, check BLUE connector
- 6x - Wrong SWC message, confirm key has been removed
- 7x - No ACC power, check GREEN connector
- 8x - No immobilizer data, check GREEN & BLADE connectors
- 9x - IGN ON, confirm key has been removed
- 10x - Keysense active, confirm key has been removed
- 11x - No ACC, confirm key is on
- 12x - No IGN, confirm key is on
- 13x - VIN not matching Weblink data, contact engineering

## CARTRIDGE INSTALLATION

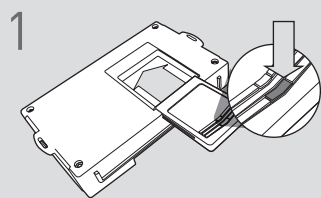

Slide cartridge into unit. Notice button under LED.

2

Ready for Module Programming Procedure.

## MODULE PROGRAMMING PROCEDURE - WITH KLON

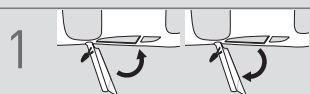

Close driver door. Re-open driver door to wake up data bus.

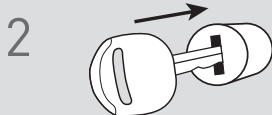

Insert key into ignition.



Turn key to ON position.

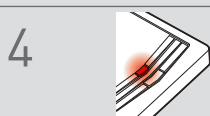

Wait, LED will turn solid RED.



Turn key to OFF position.

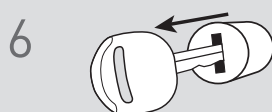

Remove key.



LED will turn OFF.

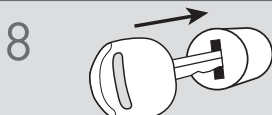

Insert key into ignition.

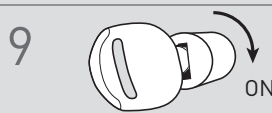

Turn key to ON position.



Wait, LED will flash BLUE rapidly.



Turn key to OFF position.

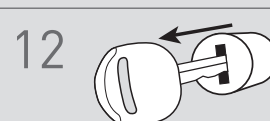

Remove key.

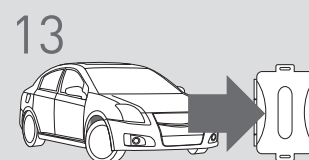

**WARNING:**  
Disconnect power last.  
Disconnect module from vehicle.

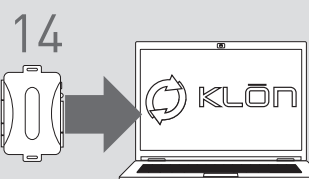

Connect module to computer and proceed with extended programming.

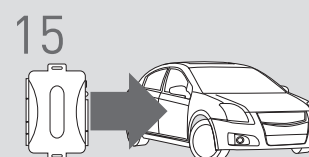

**WARNING:** Do not press module programming button.  
Connect power first.  
Connect module to vehicle.

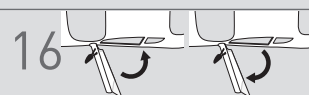

Close driver door. Re-open driver door to wake up data bus.



Turn key to ON position.

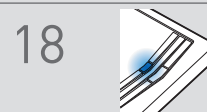

Wait, LED will turn solid BLUE for 2 seconds.

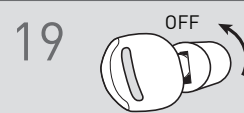

Turn key to OFF position.

20

Module Programming Procedure completed.