

FTI-GMT3: Vehicle Coverage and Preparation Notes

Make	Model	Year	Install	CAN	Lights	Type	BCM	Configuration
DL-GM12 Chevrolet	Cruze Flip-Key MT	2019	Type 2 + Clutch	Type B	Park / Auto Type A	Key	ADKP	Feature Option None

Firmware: This installation uses **BLADE-AL(DL)-GM12**, flash module and update the controller firmware before installing.

Install: **Type 2** installation sources CAN data from the white connector of the BCM, requiring the use of the '**B-connector**', the connector marked 'A' is not used.

Lights: **Type A** lights (standard parking lights) are provided, as are **Type H** (hazard lights), both incorporated in the harness for visual display of runtime status/diagnostics. Re-pinning of the CM I/O (gray) harness is required, regardless of which type you choose to use, both options have been provided for your selection. If you choose hazards you will also need to configure the selected POC for one of the following hazard control options, **Hazard1** (POC option #30 (momentary) **or** **Hazard2** (POC option #23 (latching)), depending on hazard switch operation.

Locks: The CM lock connector is not required for this installation type. Door locks are handled via OnStar data signals so analog connections are not necessary. Secure the harness connector as needed.

Clutch Bypass Required: Installation requires additional wiring and a resistor to provide a clutch bypass. See note below and illustration for required wiring.

Lock connector is NOT REQUIRED for this installation type. :)

Manual transmission equipped vehicles: **Type 2** installation requires additional wiring and a resistor to provide a clutch bypass. Extend the CM7 negative start output (red/black) to the vehicle clutch switch and connect to the yellow wire in position #2, through a 180 Ohm resistor, as illustrated.

FTI-GMT3 - Installation and Configuration Notes

- A** REQUIRED CONNECTION, SEE NOTE ABOVE
- B** CONNECTION NOT REQUIRED
- C** REQUIRED CONFIGURATION - TYPE B
- D** REQUIRED CONFIGURATION - KEY TYPE
- E** REQUIRED CONNECTION - CLUTCH



FEATURE COVERAGE														
IMMOBILIZER DATA														
DOOR LOCK														
DOOR UNLOCK														
ARM OEM ALARM														
DISARM OEM ALARM														
TRUNK/HATCH RELEASE														
DOOR STATUS														
TRUNK STATUS														
RAP SHUTDOWN														
BRAKE STATUS														
E-BRAKE STATUS														
TACH OUTPUT														
DATA/MUX IGN/ST														
HOOD STATUS														
SECURE TAKEOVER														
PARKING LIGHTS														
HAZARD LIGHTS														

•FT-DAS Required for manual transmission.
•BOTH Red & Red/White MUST be connected with high current application.

Jumper Setting			
Parking Light			(+)Door Trigger In
Accessory			(-)Door Trigger In
Ignition (Default)			(Default)
Trunk			Starter
Starter			Ignition
Parking Light (Default)			Accessory (Default)

CM7000/7200 **Cut loop for A/T**

CM-900S/900AS

CM900AS/900S Jumper

START
ACC
IGN1

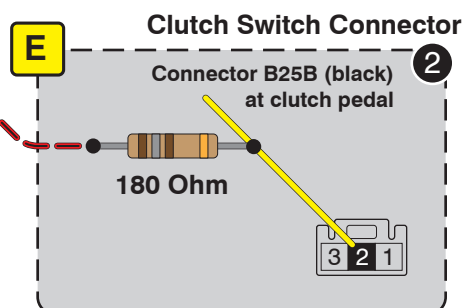
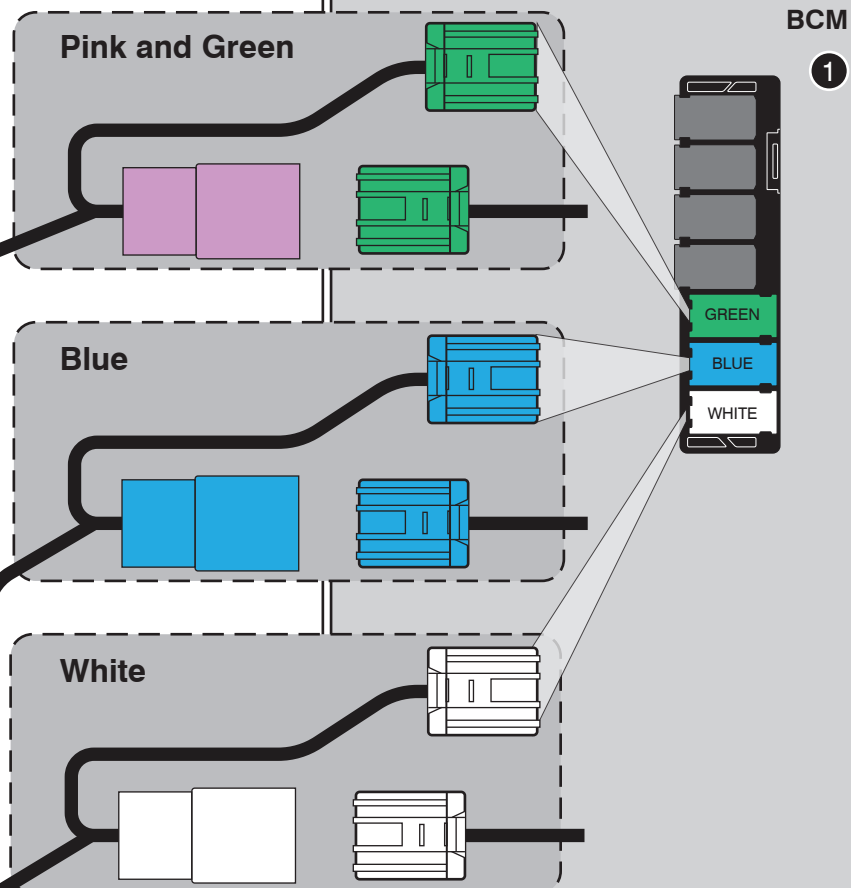
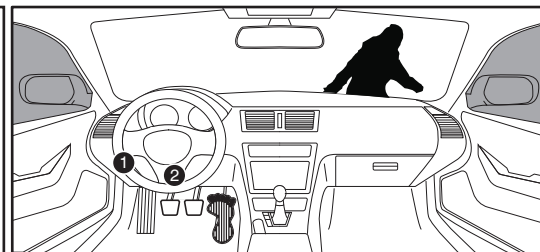
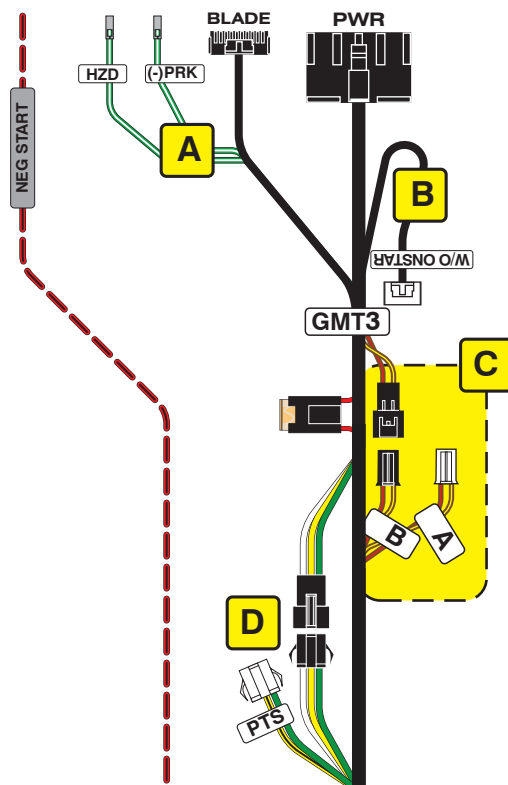

LED Programming Error Codes

Module LED flashing RED during programming

- 1x - No ACC power, check GREEN connector
- 2x - MUX status not detected, check GREEN connector
- 3x - No IGN, check GREEN connector
- 4x - No HSCAN activity, check BLUE connector
- 5x - No SWC activity, check BLUE connector
- 6x - Wrong SWC message, confirm key has been removed
- 7x - No ACC power, check GREEN connector
- 8x - No immobilizer data, check GREEN & BLADE connectors
- 9x - IGN ON, confirm key has been removed
- 10x - Keysense active, confirm key has been removed
- 11x - No ACC, confirm key is on
- 12x - No IGN, confirm key is on
- 13x - VIN not matching Weblink data, contact engineering

CARTRIDGE INSTALLATION

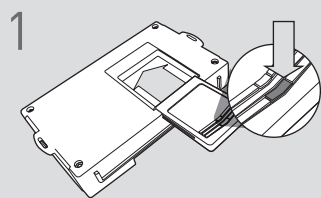

Slide cartridge into unit. Notice button under LED.

2

Ready for Module Programming Procedure.

MODULE PROGRAMMING PROCEDURE - WITH KLON

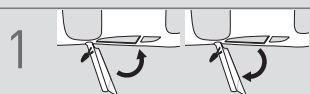

Close driver door. Re-open driver door to wake up data bus.

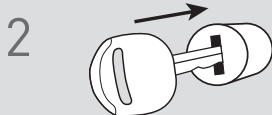

Insert key into ignition.



Turn key to ON position.

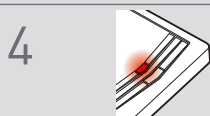

Wait, LED will turn solid RED.



Turn key to OFF position.

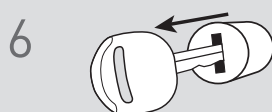

Remove key.



LED will turn OFF.

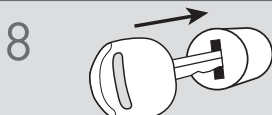

Insert key into ignition.

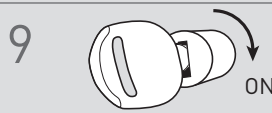

Turn key to ON position.



Wait, LED will flash BLUE rapidly.



Turn key to OFF position.

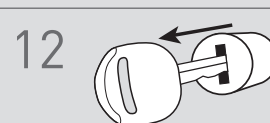

Remove key.

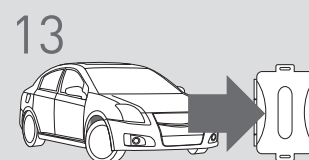

WARNING:
Disconnect power last.
Disconnect module from vehicle.

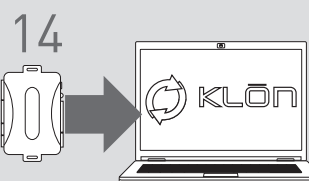

Connect module to computer and proceed with extended programming.

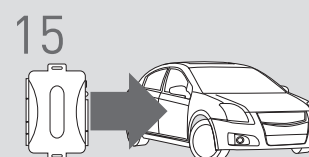

WARNING: Do not press module programming button.
Connect power first.
Connect module to vehicle.

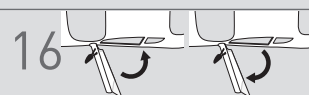

Close driver door. Re-open driver door to wake up data bus.



Turn key to ON position.

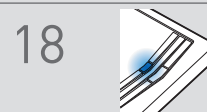

Wait, LED will turn solid BLUE for 2 seconds.

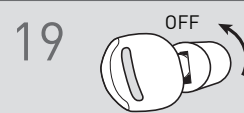

Turn key to OFF position.

20

Module Programming Procedure completed.