

Headlight Switch

1



Gateway Module

2



LED Programming Error Codes

Module LED flashing RED during programming

- 1x - No CAN activity, confirm BLADE 1 or BLADE 2 connector
- 2x - No ignition, confirm BLADE 1 or BLADE 2 connector
- 3x - No communication with BCM, confirm compatibility
- 4x - Unable to activate OEM RS, confirm compatibility
- 5x - Unable to activate OEM RS, firmware will not work
- Fast Blink - CAN connection, reverse BLADE 1/2 connector

CARTRIDGE INSTALLATION



1 Slide cartridge into unit. Notice button under LED.

2

Ready for Module Programming Procedure.

MODULE PROGRAMMING PROCEDURE



1 CONNECT BLADE connector 'A', proceed with Step 1 programming

2 OFF ACC ON START

Set ignition to ON position.

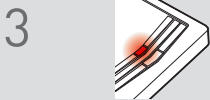
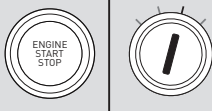

3 Wait, LED 1 will turn solid RED.

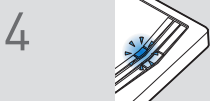

4 Wait, LED 1 will flash BLUE once [1x].

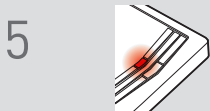

5 Wait, LED 1 will turn solid RED.

6 OFF ACC ON START

Set ignition to OFF position.

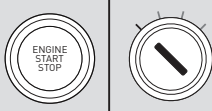

7 DISCONNECT BLADE connector 'A', CONNECT BLADE connector 'B', proceed with Step 2 programming

8 OFF ACC ON START

Set ignition to ON position.

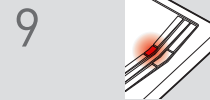
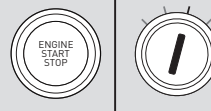

9 Wait, LED 1 will turn solid RED.



10 Wait, LED 1 will flash BLUE rapidly.

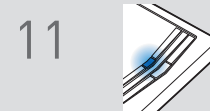

11 Wait, LED 1 will turn solid BLUE for 2 seconds.

12 OFF ACC ON START

Set ignition to OFF position.

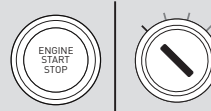

13

Module Programming Procedure completed.

TAKE OVER PROCEDURE - TO THE VEHICLE OWNER

NOTE

- I All vehicle doors must be closed and locked prior to remote start sequence.

1



Press unlock on OEM or aftermarket remote or request switch.

2



DO NOT PRESS BRAKE PEDAL. Set ignition to ON position. Wait 2 seconds for key validation.

3



Press and release BRAKE pedal.

4

Take over procedure completed.



Failure to follow procedure will result in vehicle engine shutdown.