

Make	Model	Year	Install	CAN	Lights	OEM RS	POC	I/O Changes
DL-FM8 Ford	Explorer PTS AT	2020-21	Type 6	GTWY	Park / Auto A	N/A	N/A	Green White/Blue N/A

Firmware: This installation requires **BLADE-AL(DL)-FM8** firmware, flash module and update the controller firmware before beginning the installation. This firmware requires the use of tach monitoring, please ensure that tach is programmed to avoid malfunction.

Confirm vehicle compatibility on the module flashing site before proceeding with installation.

See compatibility note below.

Compatibility requirements: In order to confirm firmware compatibility, please confirm vehicle is equipped with active hood pin switch. Hood ajar warning must be displayed in instrument cluster when hood is open and ignition is on. Additional dealer programming and switch installation or hood ajar circuit manipulation* is required if hood ajar warning is not displayed when confirming.

FTI-FDK2: Installation and Configuration Notes

- A** REQUIRED FOR PART 1 PROGRAMMING
- B** REQUIRED FOR PART 2 PROGRAMMING
- C** SECURE BLADE CONNECTOR 'A' TO MAIN HARNESS
- D** HOOD SWITCH MODIFICATION (Required if vehicle is not equipped with hood switch)



FEATURE COVERAGE														
IMMOBILIZER DATA														
DOOR LOCK														
DOOR UNLOCK														
ARM OEM ALARM														
DISARM OEM ALARM														
TRUNK/HATCH RELEASE														
POWER LIFTGATE														
DOOR STATUS														
TRUNK STATUS														
RAP SHUTDOWN														
BRAKE STATUS														
HOOD STATUS														
TACH OUTPUT														
HEATED MIRRORS														
HEATED SEATS														
SECURE TAKEOVER														
PARKING LIGHTS														
REAR DEFROST														
AFTERMARKET CTRL														

- FT-DAS Required for manual transmission.
- BOTH Red & Red/White MUST be connected with high current application.

Jumper Setting

Parking Light	Accessory	Ignition (Default)	(+)Door Trigger In (Default)	(-)Door Trigger In (Default)
Trunk	Starter	Parking Light (Default)	Starter Ignition	Accessory (Default)

CM7000/7200

CM-900S/900AS

CM900AS/900S Jumper

**START
ACC
IGN1**

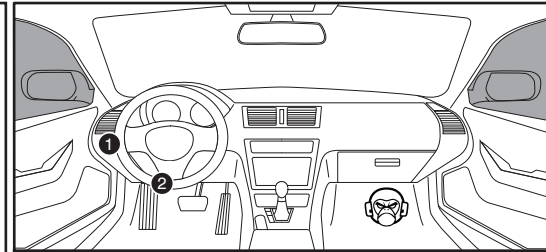
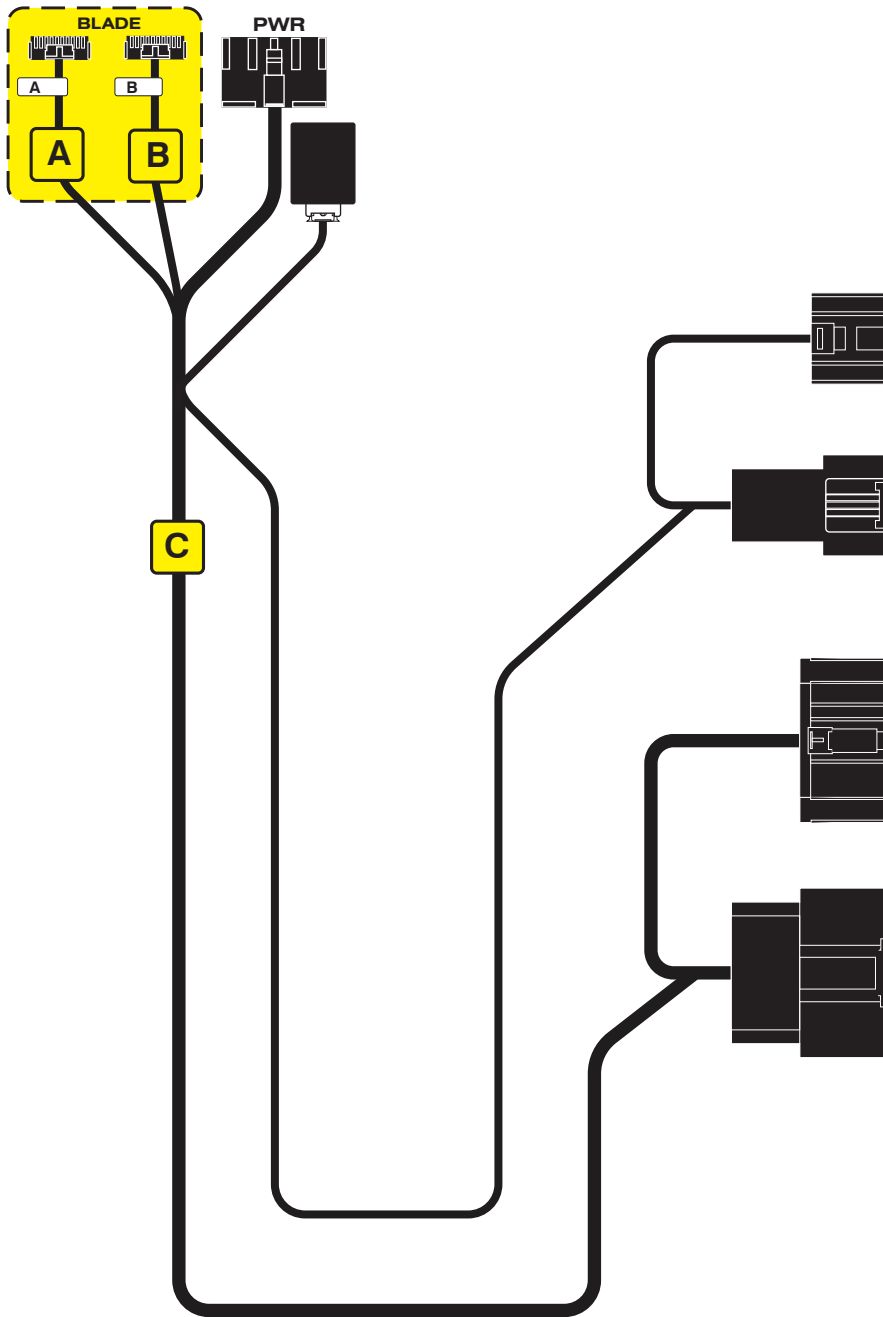

Headlight Switch

1



Gateway Module

2

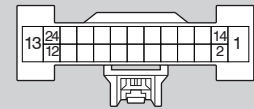

D

IF THE VEHICLE IS NOT EQUIPPED WITH AN OEM HOOD SWITCH: CONNECT HOOD PIN WIRE TO GROUND. WIRE MAY NOT BE PRESENT. IF SO, VERIFY PIN POSITION AND INSERT ALTERNATE WIRE THEN INSTALL AN AFTERMARKET HOOD SWITCH.

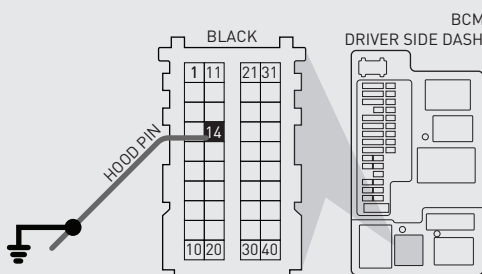

LED Programming Error Codes

Module LED flashing RED during programming

- 1x - No CAN activity, confirm BLADE 1 or BLADE 2 connector
- 2x - No ignition, confirm BLADE 1 or BLADE 2 connector
- 3x - No communication with BCM, confirm compatibility
- 4x - Unable to activate OEM RS, confirm compatibility
- 5x - Unable to activate OEM RS, firmware will not work
- Fast Blink - CAN connection, reverse BLADE 1/2 connector

CARTRIDGE INSTALLATION



1 Slide cartridge into unit. Notice button under LED.

2

Ready for Module Programming Procedure.

MODULE PROGRAMMING PROCEDURE



1 CONNECT BLADE connector 'A', proceed with Step 1 programming



2 Set ignition to ON position.



3 Wait, LED 1 will turn solid RED.



4 Wait, LED 1 will flash BLUE once [1x].



5 Wait, LED 1 will turn solid RED.



6 Set ignition to OFF position.



7 DISCONNECT BLADE connector 'A', CONNECT BLADE connector 'B', proceed with Step 2 programming



8 Set ignition to ON position.



9 Wait, LED 1 will turn solid RED.



10 Wait, LED 1 will flash BLUE rapidly.



11 Wait, LED 1 will turn solid BLUE for 2 seconds.



12 Set ignition to OFF position.

13

Module Programming Procedure completed.

TAKE OVER PROCEDURE - TO THE VEHICLE OWNER

NOTE

- I All vehicle doors must be closed and locked prior to remote start sequence.

1



Press unlock on OEM or aftermarket remote or request switch.

2



DO NOT PRESS BRAKE PEDAL. Set ignition to ON position. Wait 2 seconds for key validation.

3



Press and release BRAKE pedal.

4

Take over procedure completed.



Failure to follow procedure will result in vehicle engine shutdown.