

SKREEM Module Connector

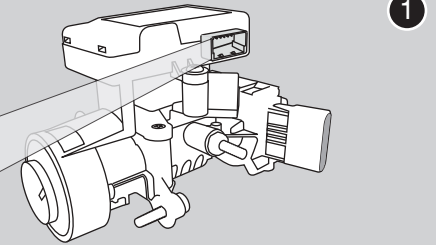

Driver kick panel harness

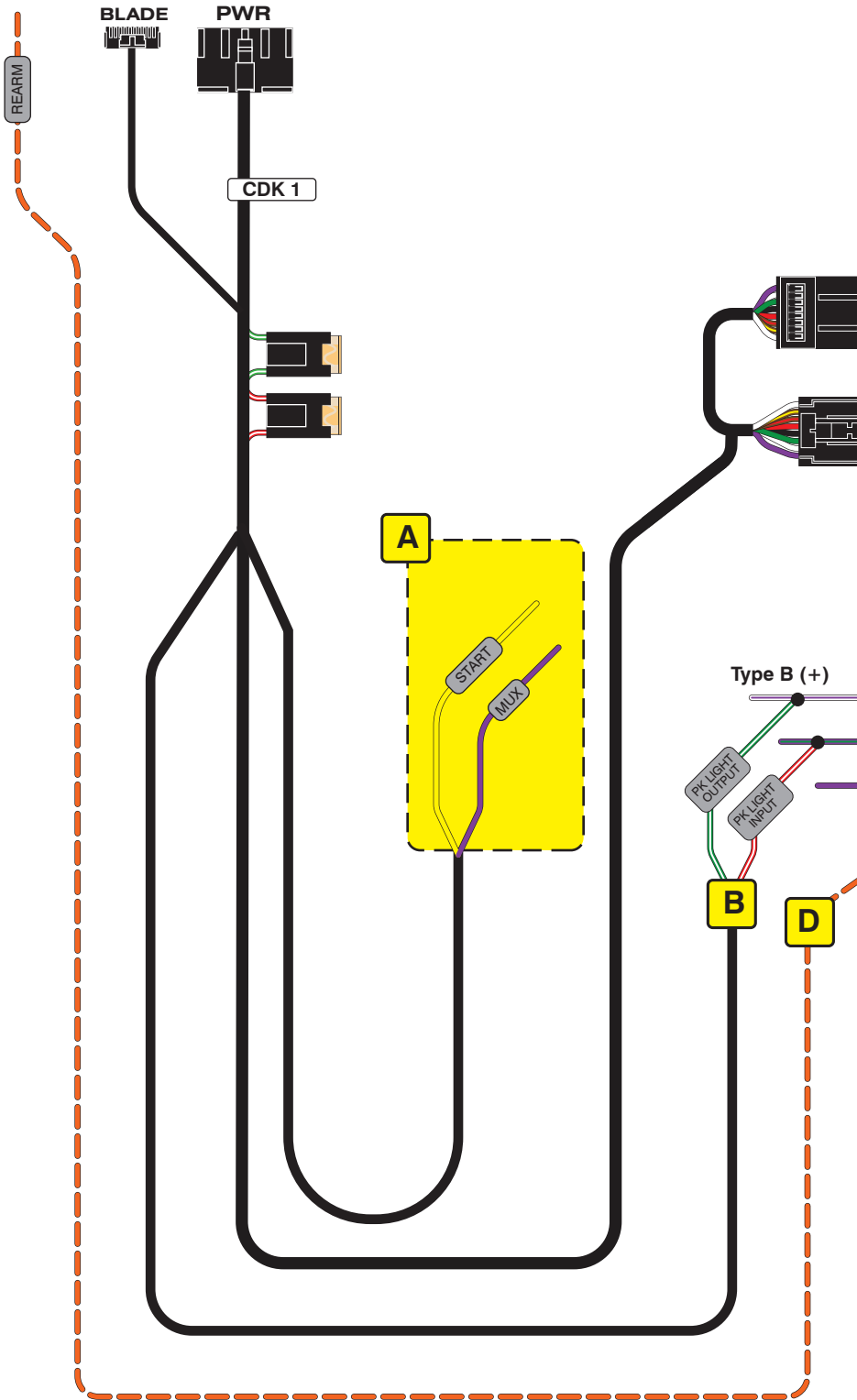
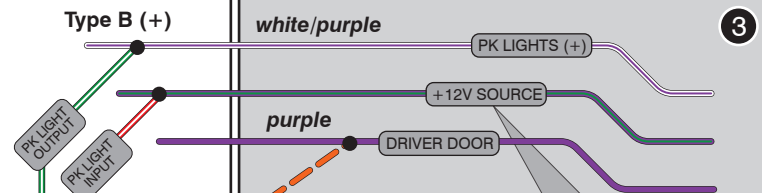

+12V Power Source
The CH5 solution is a low current draw solution. Suitable power sources for the **PK LIGHT INPUT** can be found throughout the vehicle, usually in close proximity to the location at which you choose to make the parking light connection, common +12VDC circuits are **RED** or **YELLOW/RED**, typically fused at 15A or greater. Commonly used circuit locations are at the OBD-II connector (pin #16), audio system amplifier, harness above the glove box, and in the kick panel harnesses. All of which are suitable.

C

LED Programming Error Codes

- Module LED flashing RED during programming
- 1x - CAN Error, check CAN wiring and voltages
 - 2x - Immobilizer, check wiring, press button to skip
 - 3x - Immobilizer, check wiring, contact support
 - 4x - VIN, Check CAN wiring
 - 5x - VIN invalid, contact support
 - 6x - VIN mismatch, confirm firmware and vehicle entry

CARTRIDGE INSTALLATION

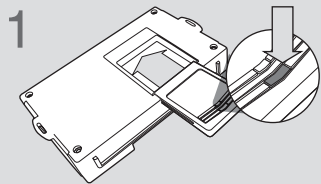

1 Slide cartridge into unit. Notice button under LED.

2

Ready for Module Programming Procedure.

MODULE PROGRAMMING PROCEDURE



1 Insert key into ignition.



2 Turn key to ON position.

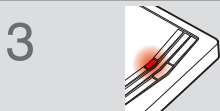

3 LED will turn solid RED.



4 Within 5 seconds, LED will flash BLUE rapidly.



5 Turn key to OFF position.

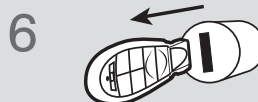

6 Remove key.

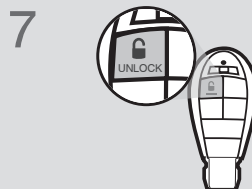

7 Press UNLOCK on the OEM remote.

If vehicle is not equipped with OEM remote, press module programming button.

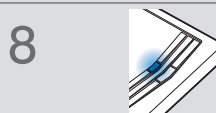

8 Wait, LED will turn solid BLUE for 2 seconds

9

Module Programming Procedure completed.