

FTI-CDK1: Vehicle Coverage and Preparation Notes

Make	Model	Year	Install	CAN	Lights	BCM	POC	I/O Changes
DL-CH5 Dodge	Ram 1500	2007-08	Type 3	SKREEM	Park / Auto A-MUX			Green White/Blue

Firmware:

Covered vehicles utilize the **BLADE-AL(DL)-CH5** firmware, flash module and update the controller firmware before installing.

Warning:

SKREEM damage may result from excess pressure placed upon the SKREEM connector and harness during disassembly. Fully exposing the SKREEM so that the connector release can be fully depressed will help avoid damaging the module.

This install does not use the included START and MUX connections, please ensure that the unused connections are properly insulated and secured for safety.

Lights:

Type A (MUX) parking light connections are located at the 10-pin headlight switch, an additional relay and 1K Ohm resistor are required to complete the circuit interface.

Type B (+) parking light connections are not required for this installation type. Please ensure that the unused wires are properly insulated and secured for safety.

RAP:

Type D (-) retained accessory power (RAP) handling requires connecting controller rearm output to the driver's door pin wire, **purple** in the driver kick panel harness.

FTI-CDK1 - Installation and Configuration Notes

- A** Connections not required.
- B** Connections not required.
- C** MUX parking lights require an additional relay and 1K Ohm resistor.
- D** RAP shutdown connection, configure POC for RAP (option #31).

•FT-DAS Required for manual transmission.
•BOTH Red & Red/White MUST be connected with high current application.

Jumper Setting

CM7000/7200 Cut loop for A/T

CM-900S/900AS

CM900AS/900S Jumper



FEATURE COVERAGE																						
IMMOBILIZER DATA	PRIORITY UNLOCK	DOOR LOCK	DOOR UNLOCK	ARM OEM ALARM	DISARM OEM ALARM						DOOR STATUS	RAP SHUTDOWN	BRAKE STATUS	E-BRAKE STATUS	TACH OUTPUT	DATA/MUX IGNITION			PARKING LIGHTS			

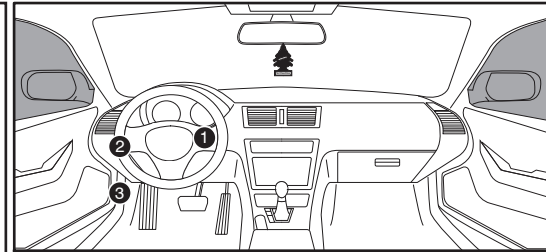

SKREEM Module Connector ①

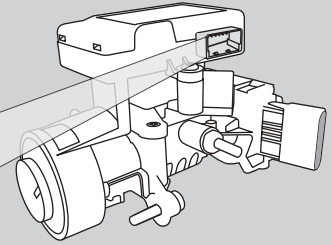

Headlight Switch Connector ②

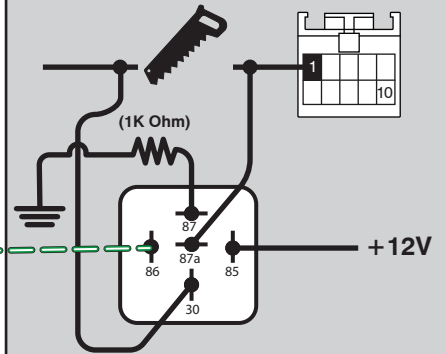

Driver's Kick Panel ③

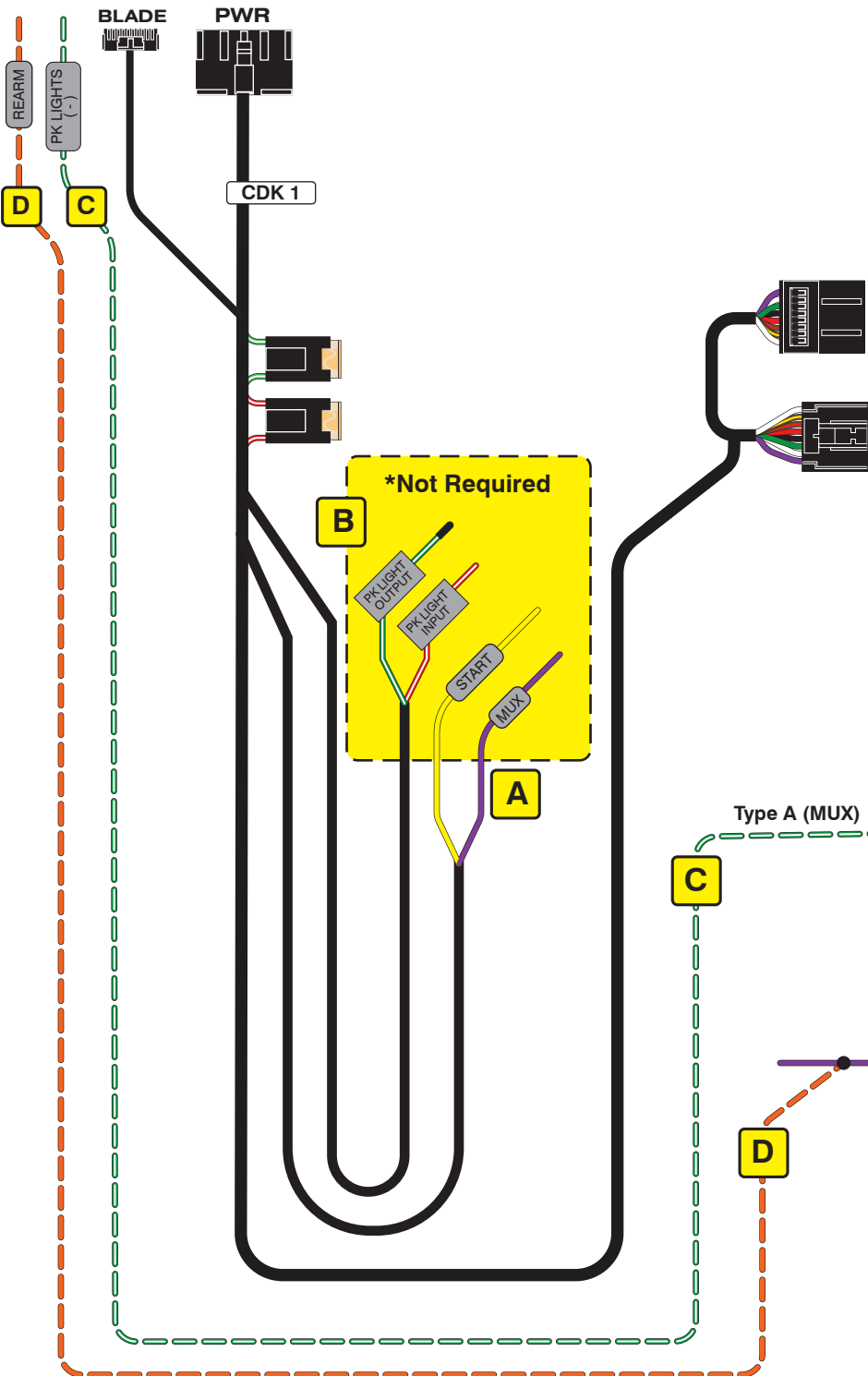

LED Programming Error Codes

Module LED flashing RED during programming

- 1x - CAN Error, check CAN wiring and voltages
- 2x - Immobilizer, check wiring, press button to skip
- 3x - Immobilizer, check wiring, contact support
- 4x - VIN, Check CAN wiring
- 5x - VIN invalid, contact support
- 6x - VIN mismatch, confirm firmware and vehicle entry

CARTRIDGE INSTALLATION

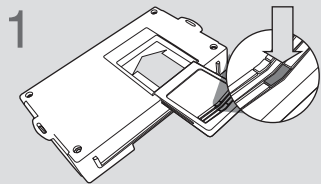

1 Slide cartridge into unit. Notice button under LED.

2

Ready for Module Programming Procedure.

MODULE PROGRAMMING PROCEDURE



1 Insert key into ignition.



2 Turn key to ON position.

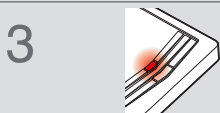

3 LED will turn solid RED.



4 Within 5 seconds, LED will flash BLUE rapidly.



5 Turn key to OFF position.

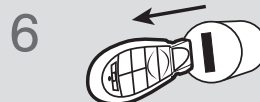

6 Remove key.



7 Press UNLOCK on the OEM remote.

If vehicle is not equipped with OEM remote, press module programming button.

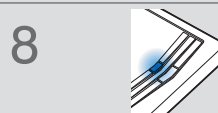

8 Wait, LED will turn solid BLUE for 2 seconds

9

Module Programming Procedure completed.