

Make	Model	Year	Install	CAN	Lights	BCM	POC	I/O Changes
DL-CH5 Dodge	Avenger	2008-14	Type 3	SKREEM	Park / Auto B-DKP			Green White/Blue

Firmware:

Covered vehicles utilize the **BLADE-AL(DL)-CH5** firmware, flash module and update the controller firmware before installing.

Warning:

SKREEM damage may result from excess pressure placed upon the SKREEM connector and harness during disassembly. Fully exposing the SKREEM so that the connector release can be fully depressed will help avoid damaging the module.

This install does not use the included START and MUX connections, please ensure that the unused connections are properly insulated and secured for safety.

Lights:

Type B (+) parking light connections located in driver kick panel (DKP)

RAP:

Type D (-) retained accessory power (RAP) handling requires connecting the controller rearm output to the driver's door pin wire, **purple** in the driver kick panel harness.

FTI-CDK1 - Installation and Configuration Notes

- A** Connections not required.
- B** Green/white to parking light, red/white to +12V constant.
- C** [This space intentionally left blank]
- D** RAP shutdown connection, configure POC for RAP (option #31).



FEATURE COVERAGE																							
IMMOBILIZER DATA	PRIORITY UNLOCK	DOOR LOCK	DOOR UNLOCK	ARM OEM ALARM	DISARM OEM ALARM	TRUNK/HATCH RELEASE					DOOR STATUS	TRUNK STATUS	RAP SHUTDOWN	BRAKE STATUS	E-BRAKE STATUS	TACH OUTPUT	DATA/MUX IGNITION			PARKING LIGHTS			

•FT-DAS Required for manual transmission.
•BOTH Red & Red/White MUST be connected with high current application.

Jumper Setting

Parking Light	Accessory	Ignition (Default)	(+)Door Trigger In (Default)	(-)Door Trigger In (Default)
Trunk	Starter	Parking Light (Default)	Starter	Ignition
			Accessory (Default)	

CM7000/7200 **Cut loop for A/T**

CM-900S/900AS

CM900AS/900S Jumper

START
ACC
IGN1

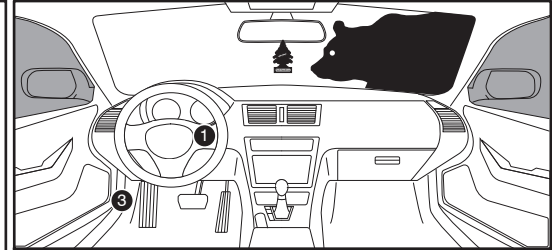
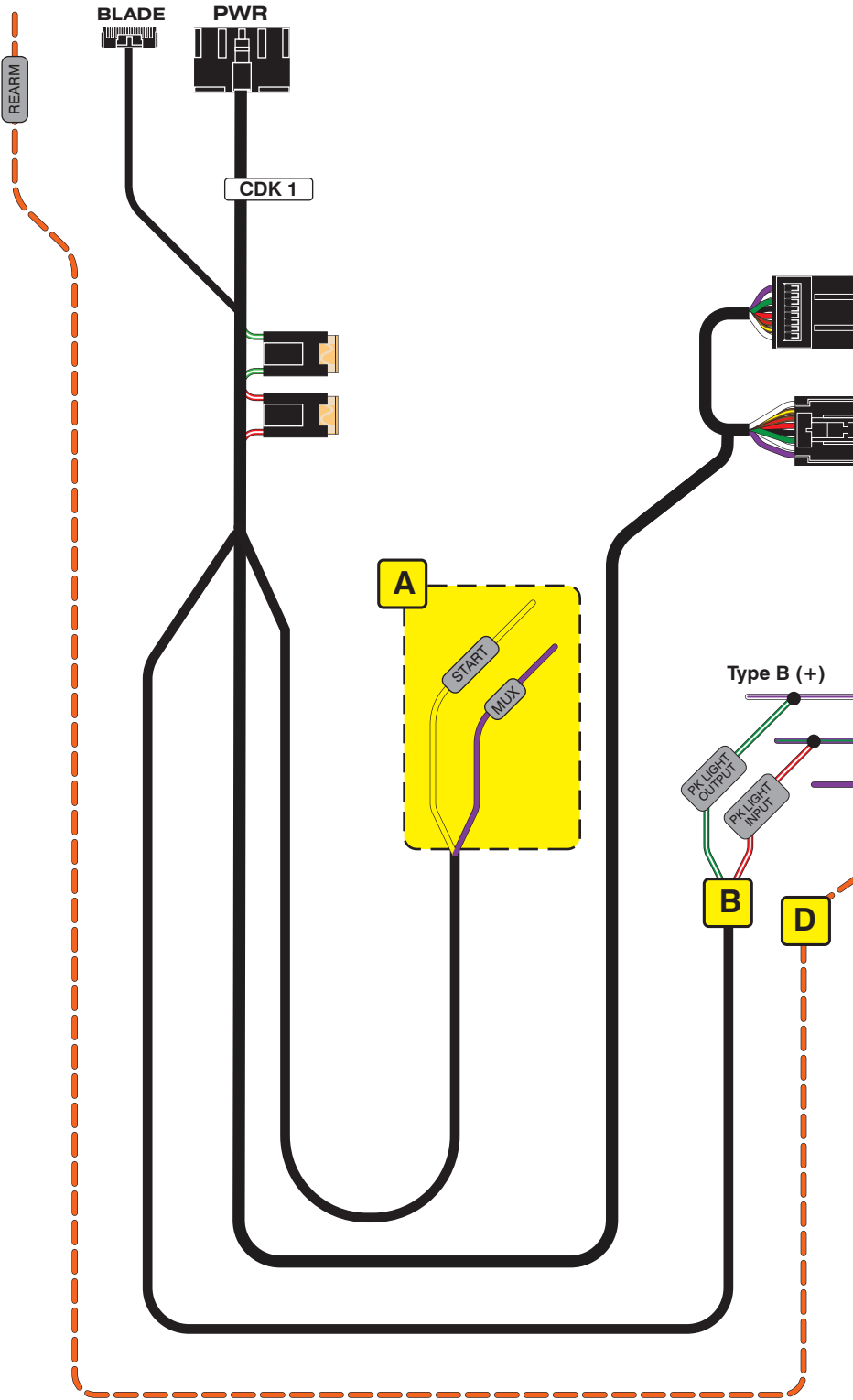

SKREEM Module Connector

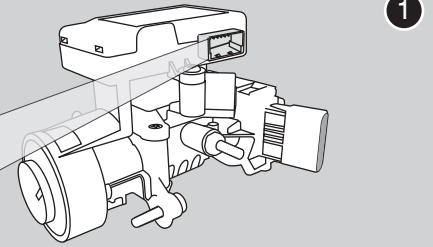

Driver kick panel harness

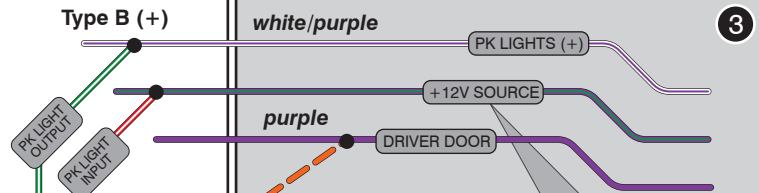

+12V Power Source

The CH5 solution is a low current draw solution. Suitable power sources for the PK LIGHT INPUT can be found throughout the vehicle, usually in close proximity to the location at which you choose to make the parking light connection, common +12VDC circuits are RED or YELLOW/RED, typically fused at 15A or greater. Commonly used circuit locations are at the OBD-II connector (pin #16), audio system amplifier, harness above the glove box, and in the kick panel harnesses. All of which are suitable.

C

LED Programming Error Codes

- Module LED flashing RED during programming
- 1x - CAN Error, check CAN wiring and voltages
 - 2x - Immobilizer, check wiring, press button to skip
 - 3x - Immobilizer, check wiring, contact support
 - 4x - VIN, Check CAN wiring
 - 5x - VIN invalid, contact support
 - 6x - VIN mismatch, confirm firmware and vehicle entry

CARTRIDGE INSTALLATION

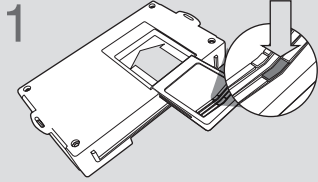

1 Slide cartridge into unit. Notice button under LED.

2

Ready for Module Programming Procedure.

MODULE PROGRAMMING PROCEDURE



1 Insert key into ignition.



2 Turn key to ON position.

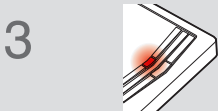

3 LED will turn solid RED.



4 Within 5 seconds, LED will flash BLUE rapidly.



5 Turn key to OFF position.

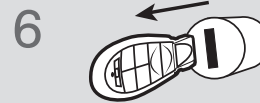

6 Remove key.



7 Press UNLOCK on the OEM remote.

If vehicle is not equipped with OEM remote, press module programming button.

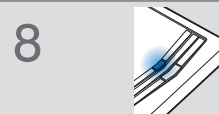

8 Wait, LED will turn solid BLUE for 2 seconds

9

Module Programming Procedure completed.