

SKREEM Module Connector ①

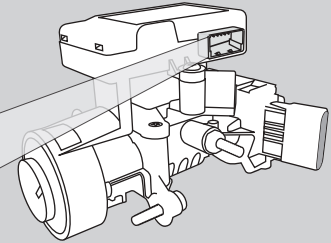

Headlight Switch Connector ②

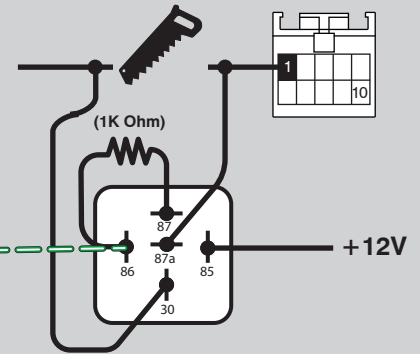

Driver's Kick Panel ③



Códigos de error de programación de LED

El LED del módulo parpadea en ROJO durante la programación

- 1x - Error de CAN, verifique el cableado y los voltajes de CAN
- 2x - Inmovilizador, verifique el cableado, presione el botón para saltar
- 3x - Inmovilizador, verificar el cableado, contactar con soporte
- 4x - VIN, Verifique el cableado de CAN
- 5x: VIN no válido, contacto con el soporte
- 6x - VIN no coincide, confirma el firmware y vehículo

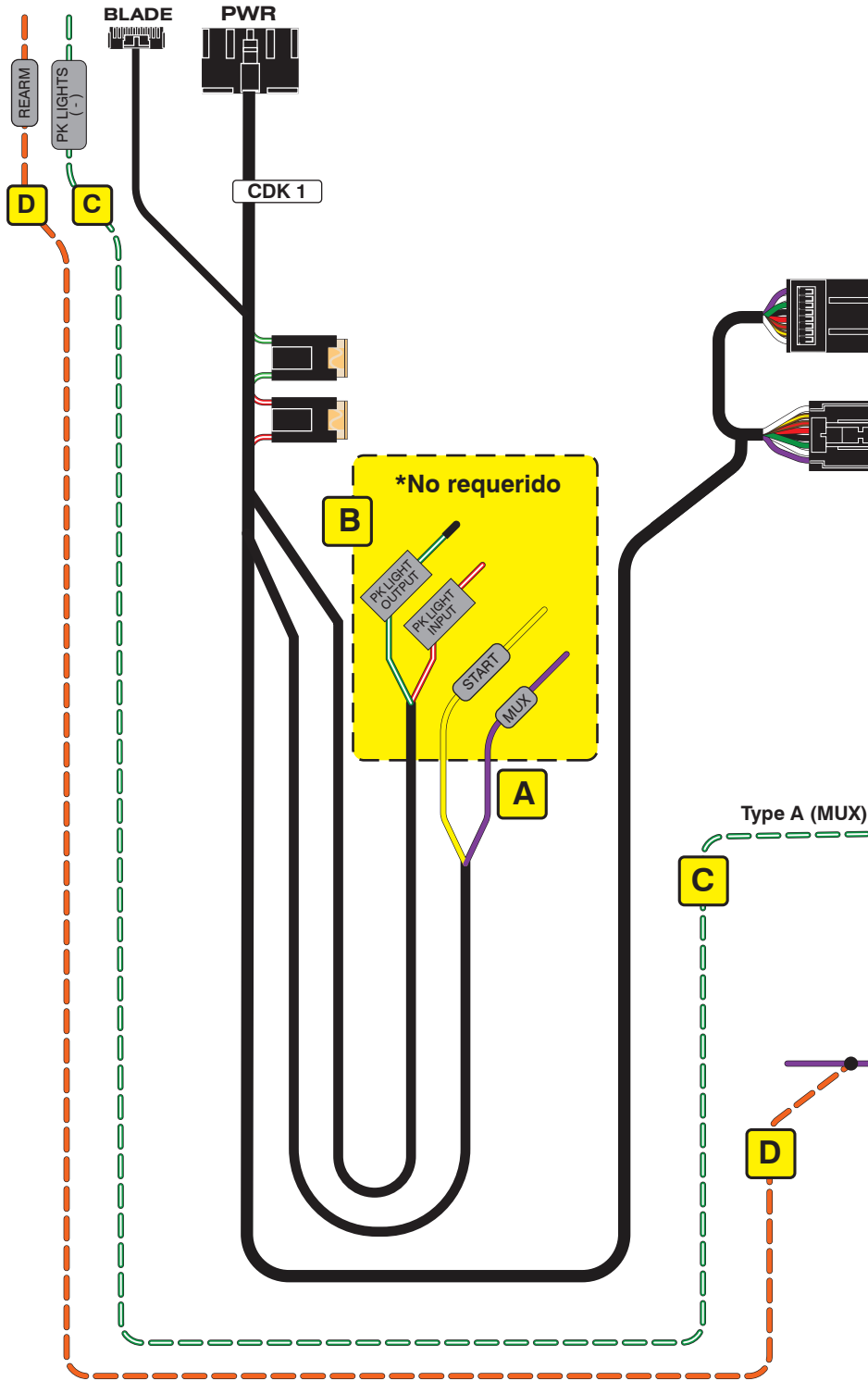

CARTRIDGE INSTALLATION

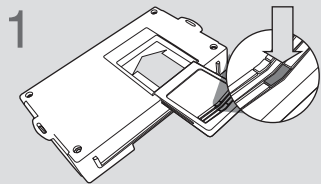

1 Slide cartridge into unit. Notice button under LED.

2

Ready for Module Programming Procedure.

MODULE PROGRAMMING PROCEDURE



1 Insert key into ignition.



2 Turn key to ON position.

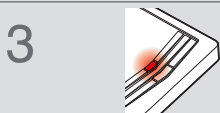

3 LED will turn solid RED.



4 Within 5 seconds, LED will flash BLUE rapidly.



5 Turn key to OFF position.

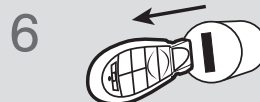

6 Remove key.



7 Press UNLOCK on the OEM remote.

If vehicle is not equipped with OEM remote, press module programming button.

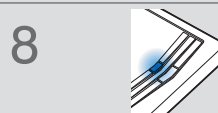

8 Wait, LED will turn solid BLUE for 2 seconds

9

Module Programming Procedure completed.