

**FIRSTECH, LLC.**  
SUPPORT - 1(888) 820-3690, EXT. 203

**Idle Mode is not a supported feature of the FTI-TLP4 Harness:** The Idle Mode feature which allows the user to exit a running has been excluded from the FTI-TLP4 harness wiring. ***If this feature is desired, please refer to the full BLADE installation diagram for the applicable wiring and make the required connection to the vehicle PTS button.***

• FT-DAS Required for manual transmission.  
 • BOTH Red & Red/White MUST be connected with high current application.

Jumper Setting			
Parking Light			(+)Door Trigger In
Accessory			(-)Door Trigger In (Default)
Trunk			Starter
Starter			Ignition
Parking Light (Default)			Accessory (Default)

CM7000/7200

Cut loop for A/T

CM-900S/900AS

CM900AS/900S Jumper

START  
ACC  
IGN1

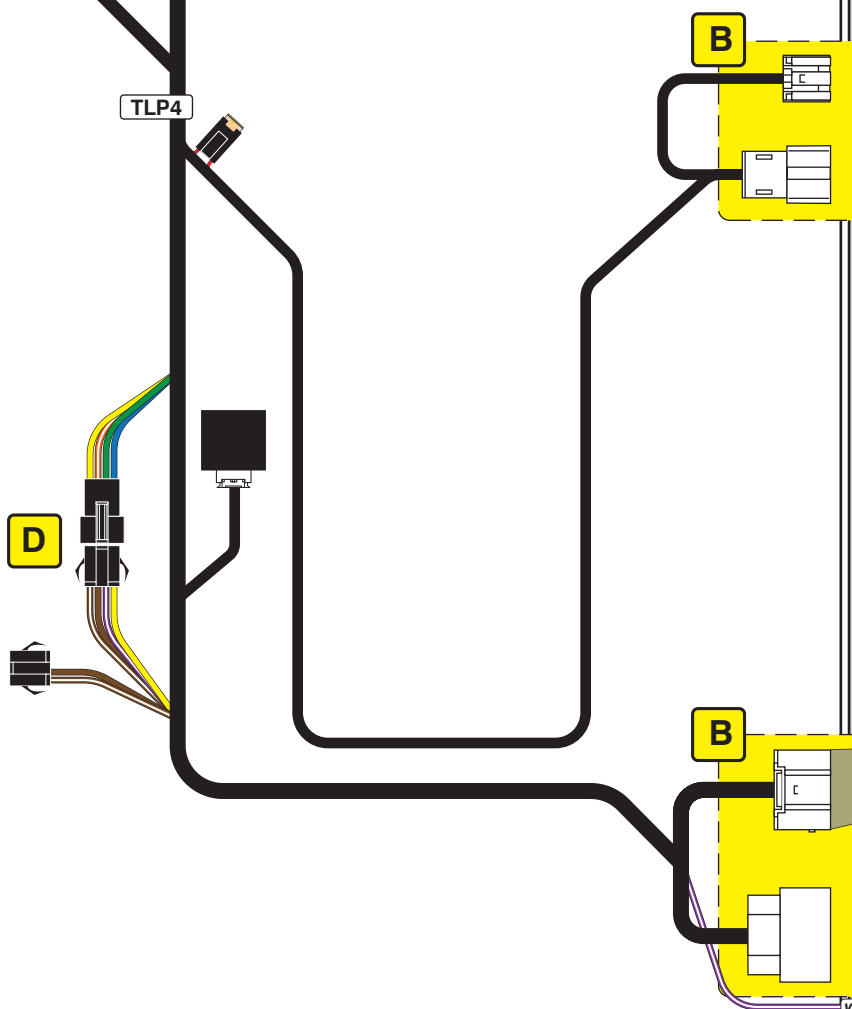
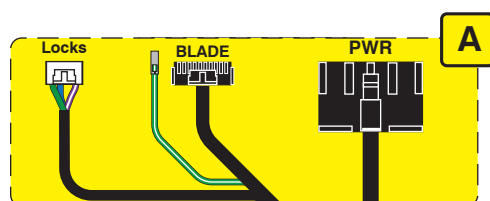
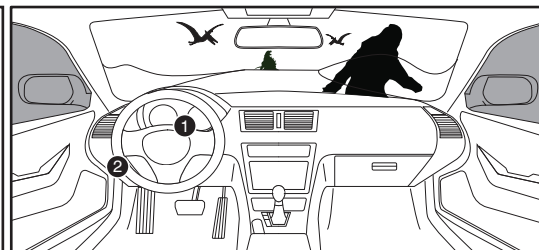
**D**
**D**

Steering Lock Connector

**1**

Main Body ECU

**2**
**C**



### LED Programming Error Codes

Module LED flashing RED during programming

- 1x - No CAN detected, check connections
- 2x - VIN not read, check connections
- 3x - VIN unknown, force platform
- 4x - No IMMO
- 5x - OEM remote starter detected, remove
- 6x - Key platform detected, check connections
- 7x - No RX detected, check connections
- 8x - No TX detected, check connections

**TAKEOVER NOT SUPPORTED: THE VEHICLE WILL SHUT DOWN UPON OPENING DRIVER'S DOOR**

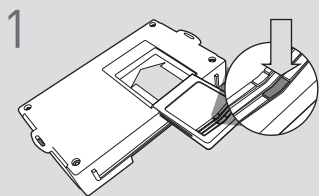
## CARTRIDGE INSTALLATION



1 Slide cartridge into unit. Notice button under LED.

2

Ready for Module Programming Procedure.

## MODULE PROGRAMMING PROCEDURE

### NOTE

I Between each step, LED will turn solid RED, this is the default standby mode.



1 Push start button twice [2x] to ON position.

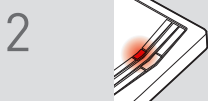

2 LED will turn solid RED.

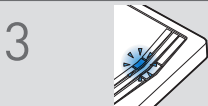

3 Within 5 seconds, LED will flash BLUE rapidly.



4 Push start button once [1x] to OFF position.

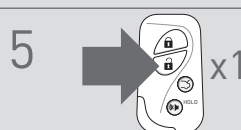

5 Press unlock button once [1x] on OEM keyfob.

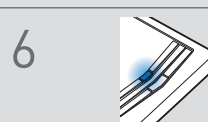

6 Wait, LED will turn solid BLUE for 2 seconds.

7

Module Programming Procedure completed.

## TAKEOVER NOT AVAILABLE