











FIRSTECH, LLC.
SUPPORT • 1(888) 820-3690, EXT. 203



Idle Mode is not a supported feature of the FTI-TLP4 Harness: The **Idle Mode** feature which allows the user to exit a running has been excluded from the **FTI-TLP4** harness wiring. *If this feature is desired, please refer to the full **BLADE** installation diagram for the applicable wiring and make the required connection to the vehicle PTS button.*

• FT-DAS Required for manual transmission.
 • BOTH Red & Red/White must be connected with high current application.

Jumper Setting	
 Parking Light  Accessory  Ignition (Default)	 (+)Door Trigger In  (-)Door Trigger In (Default)
 Trunk  Starter  Parking Light (Default)	 Starter  Ignition  Accessory (Default)

CM7000/7200

Cut loop for A/T





CM-900S/900AS

CM900AS/900S Jumper

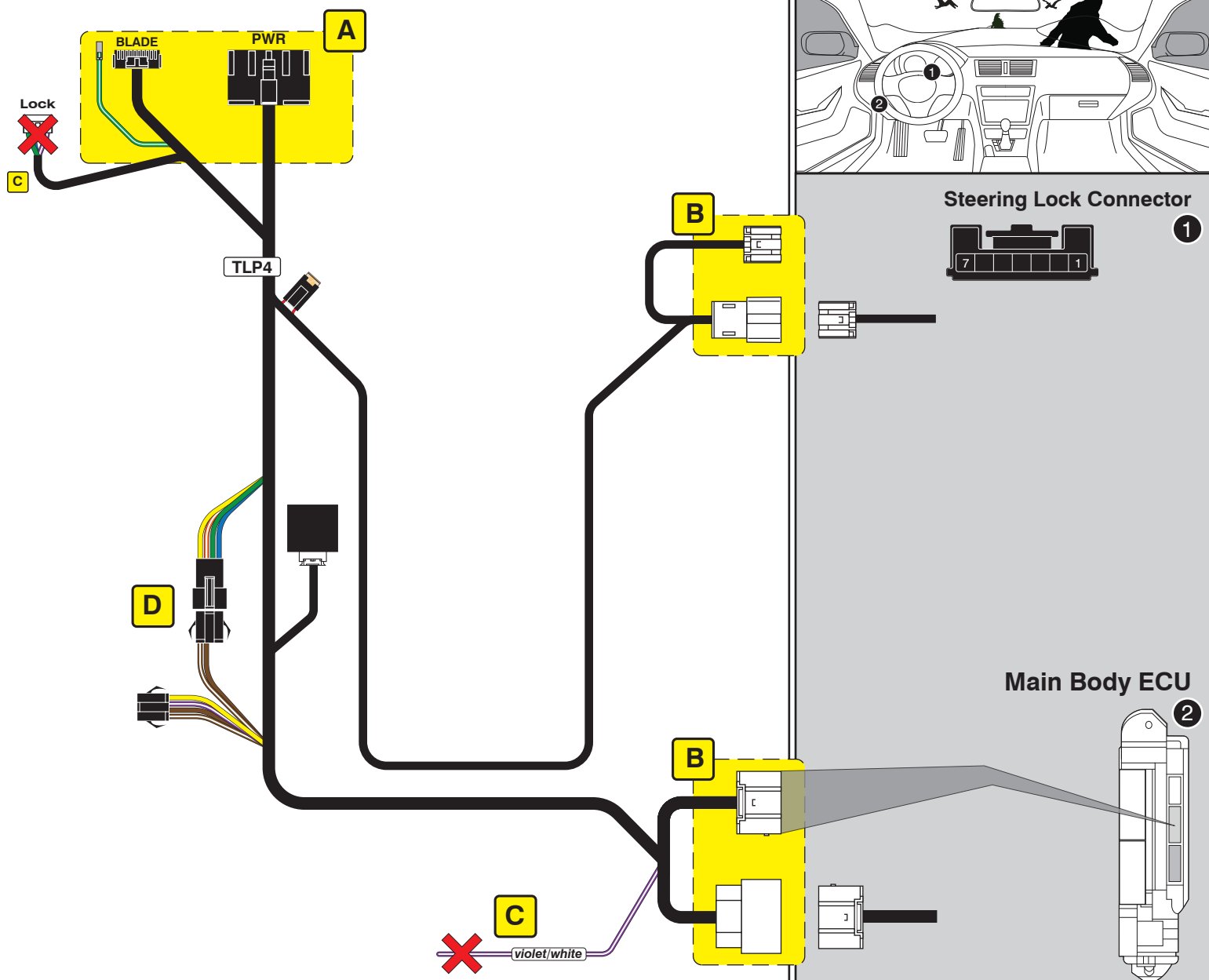

START
ACC
IGN1



LED Programming Error Codes

Module LED flashing RED during programming

- 1x - No CAN detected, check connections
- 2x - VIN not read, check connections
- 3x - VIN unknown, force platform
- 4x - No IMMO
- 5x - OEM remote starter detected, remove
- 6x - Key platform detected, check connections
- 7x - No RX detected, check connections
- 8x - No TX detected, check connections

CARTRIDGE INSTALLATION

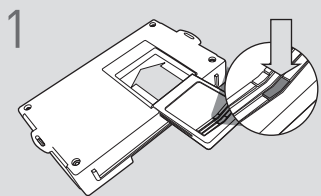

1 Slide cartridge into unit. Notice button under LED.

2

Ready for Module Programming Procedure.

MODULE PROGRAMMING PROCEDURE

NOTE

I Between each step, LED will turn solid RED, this is the default standby mode.



1 Push start button twice [2x] to ON position.

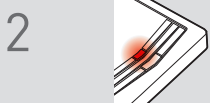

2 LED will turn solid RED.

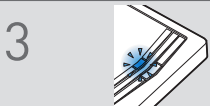

3 Within 5 seconds, LED will flash BLUE rapidly.



4 Push start button once [1x] to OFF position.

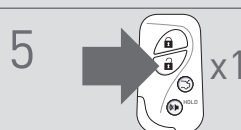

5 Press unlock button once [1x] on OEM keyfob.

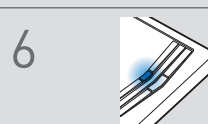

6 Wait, LED will turn solid BLUE for 2 seconds.

7

Module Programming Procedure completed.

TAKEOVER NOT AVAILABLE