

**FIRSTECH, LLC.**  
SUPPORT • 1(888) 820-3690, EXT. 203

**Idle Mode is not a supported feature of the FTI-TLP3 Harness:** The Idle Mode feature which allows the user to exit a running has been excluded from the FTI-TLP3 harness wiring. ***If this feature is desired, please refer to the full BLADE installation diagram for the applicable wiring and make the required connection to the vehicle PTS button.***

**TAKEOVER NOT SUPPORTED: THE VEHICLE WILL SHUT DOWN  
UPON OPENING DRIVER'S DOOR**

- A** CONNECTION REQUIRED
- B** CONNECTIONS REQUIRED
- C** OPTIONAL CONNECTION
- D** CONNECTION REQUIRED
- E** REQUIRED MODIFICATION



• FT-DAS Required for manual transmission.  
 • BOTH Red & Red/White must be connected with high current application.

Jumper Setting	
Parking Light  Accessory Ignition (Default)	(+)Door Trigger In (-)Door Trigger In (Default)
Trunk Starter Parking Light (Default)	Starter Ignition Accessory (Default)







CM7000/7200

Cut loop for A/T



CM-900S/900AS

CM900AS/900S Jumper

START	ACC	IGN1
		
		

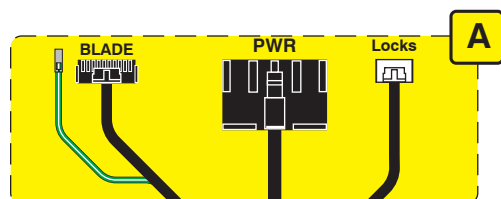

- 1 Remove female housing
- 2 Connect +12V, IGN, GND
- 3 Insulate unused wires
- 4 Connect to harness

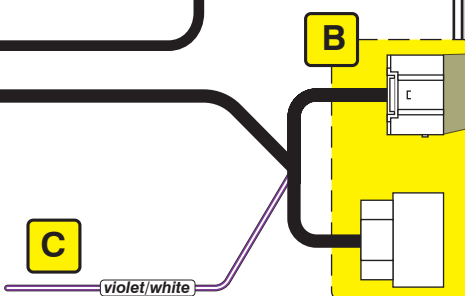
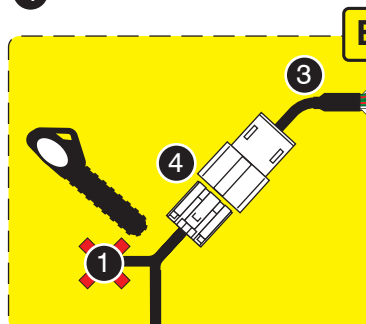

C

violet/white

D

white/black  
white/red

DCM +12V

pink

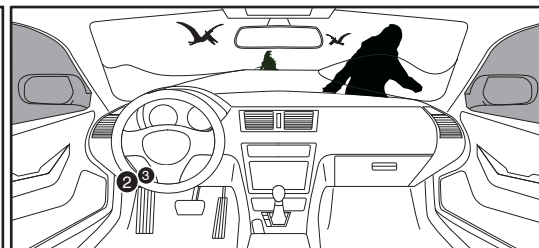

32-Pin Connector  
Main Body Ecu

VEHICLE WITHOUT STEERING LOCK

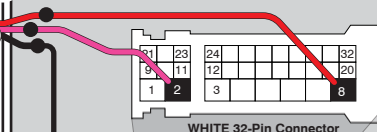

Main Body ECU

2

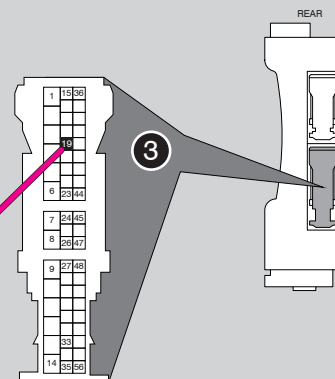
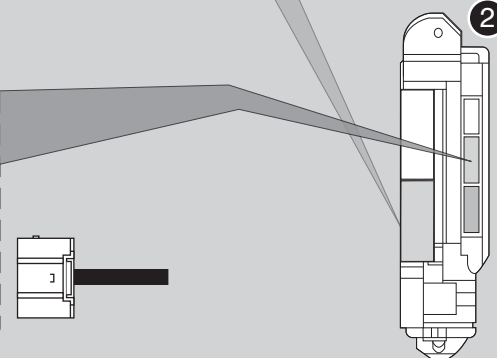

### LED Programming Error Codes

Module LED flashing RED during programming

- 1x - CAN error, confirm harness configuration
- 2x - No IGN, confirm IGN power and harness configuration
- 3x - IMMO/CAN error, confirm harness configuration
- 4x - No VIN, module may default to base platform #2
- 5x - Unknown VIN, module may default to base platform #2
- 6x - OEM starter detected, cycle IGN, if issue persists, remove and reprogram

**TAKEOVER NOT SUPPORTED: THE VEHICLE WILL SHUT DOWN UPON OPENING DRIVER'S DOOR**

## CARTRIDGE INSTALLATION

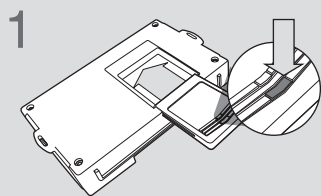

Slide cartridge into unit. Notice button under LED.

2

Ready for Module Programming Procedure.

## MODULE PROGRAMMING PROCEDURE

### NOTE

I IMPORTANT: The hood must be closed.



Push start button twice [2x] to ON position.

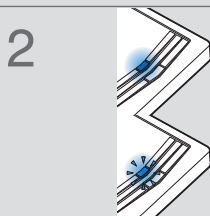

Wait, if LED turns solid BLUE for 2 seconds, proceed to step 7.

If LED flashes BLUE rapidly, proceed to step 3.



Push start button once [1x] to OFF position.

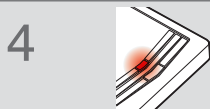

Wait, LED will turn solid RED. (This may take up to 5 minutes.)



Push start button twice [2x] to ON position.



Wait, LED will turn solid BLUE for 2 seconds

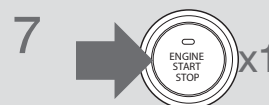

Push start button once [1x] to OFF position.

8

Module Programming Procedure completed.