

Make	Model	Year	Install	CAN	Lights	Trunk	POC	I/O Changes
DL-TL1 Toyota	Yaris 40 bit STD Key AT	2006-10	Type 1	OBD-II	Park / Auto Type 3	N/A	N/A	Green White/Blue START2/NONE

Firmware: This installation requires **BLADE-AL(DL)-TL1**, flash module and update the controller firmware before installing.

Install Type 1: Ignition harness connections are hardwired using either the high current or low current **CN1 harness**, an inspection of the vehicle wiring will indicate which version is required, but if you are unsure of which, use the high current version.

CAN: CAN data connections are located at the OBD-II connector, the OBD-II connection is mandatory.

Lights: Parking light negative and auto-light control (if equipped) are located at the parking light switch 20-pin connector of the headlight switch. The applicable lighting connections are illustrated. Replace the **green/white** wire in the gray CM I/O connector with the harness pre-terminated **green/white** wire for parking lights, and use the provided **white/red & white/black** wires to interrupt the auto-light wire, if equipped.

I/O Changes: *This install requires changing the controller output from Parking Light to START 2.*

- CM7 Series controllers: Move jumper 3 to **STARTER** position
- CMX controllers: Configure HCP#1 for 2ND START (setting 2)
- CM900 controllers: Set **Feature Option 1-6 to setting 2.**

If issues arise disarming the OEM alarm during remote start, set option 1-01 to 2.



Hood Switch Jumper: The FTL-TLK40 harness is equipped with a jumper for bypassing module detection of hood switch status. If the vehicle is not equipped with a hood switch, connect the jumper before programming the module to the vehicle.

FTI-TLK40: Installation and Configuration Notes

- A** INSPECT VEHICLE WIRING - USE APPROPRIATE HARNESS
- B** CONNECTION REQUIRED
- C** OPTIONAL CONNECTION - (CONNECT JUMPER IF NOT EQUIPPED FACTORY HOOD SWITCH)
- D** CONNECTION REQUIRED
- E** CONNECTIONS REQUIRED

- FT-DAS Required for manual transmission.
- BOTH Red & Red/White MUST be connected with high current application.

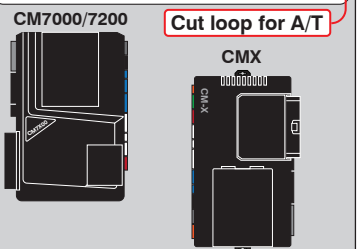
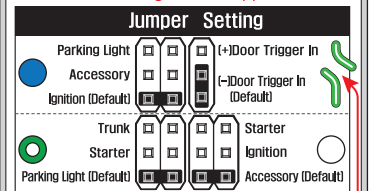

FEATURE COVERAGE														
IMMOBILIZER DATA	ARM OEM ALARM	DISARM OEM ALARM	DOOR LOCK	DOOR UNLOCK	TRUNK RELEASE (IF EQUIPPED)	LIFTGATE GLASS RELEASE	TACH OUTPUT	BRAKE STATUS	E-BRAKE STATUS	DOOR STATUS	TRUNK STATUS	HOOD STATUS	LOW CURRENT IGN HARNESS	AUTOLIGHT CONTROL

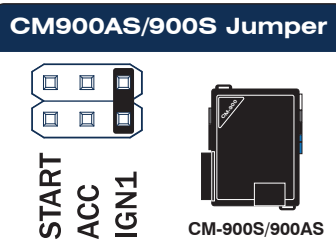

- CMX High Current Programmable (+) Output Channels**
- HCP #1 - Parking Light
 - HCP #2 - Accessory
 - HCP #3 - Ignition
- [2] 2ND START
[3] 2ND IGNITION
[4] 2ND ACCESSORY

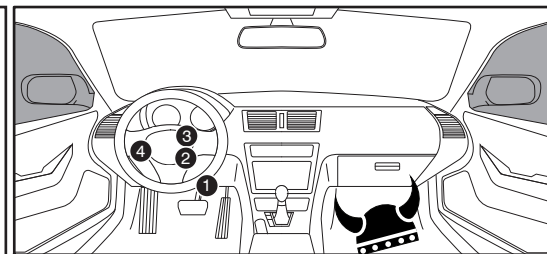
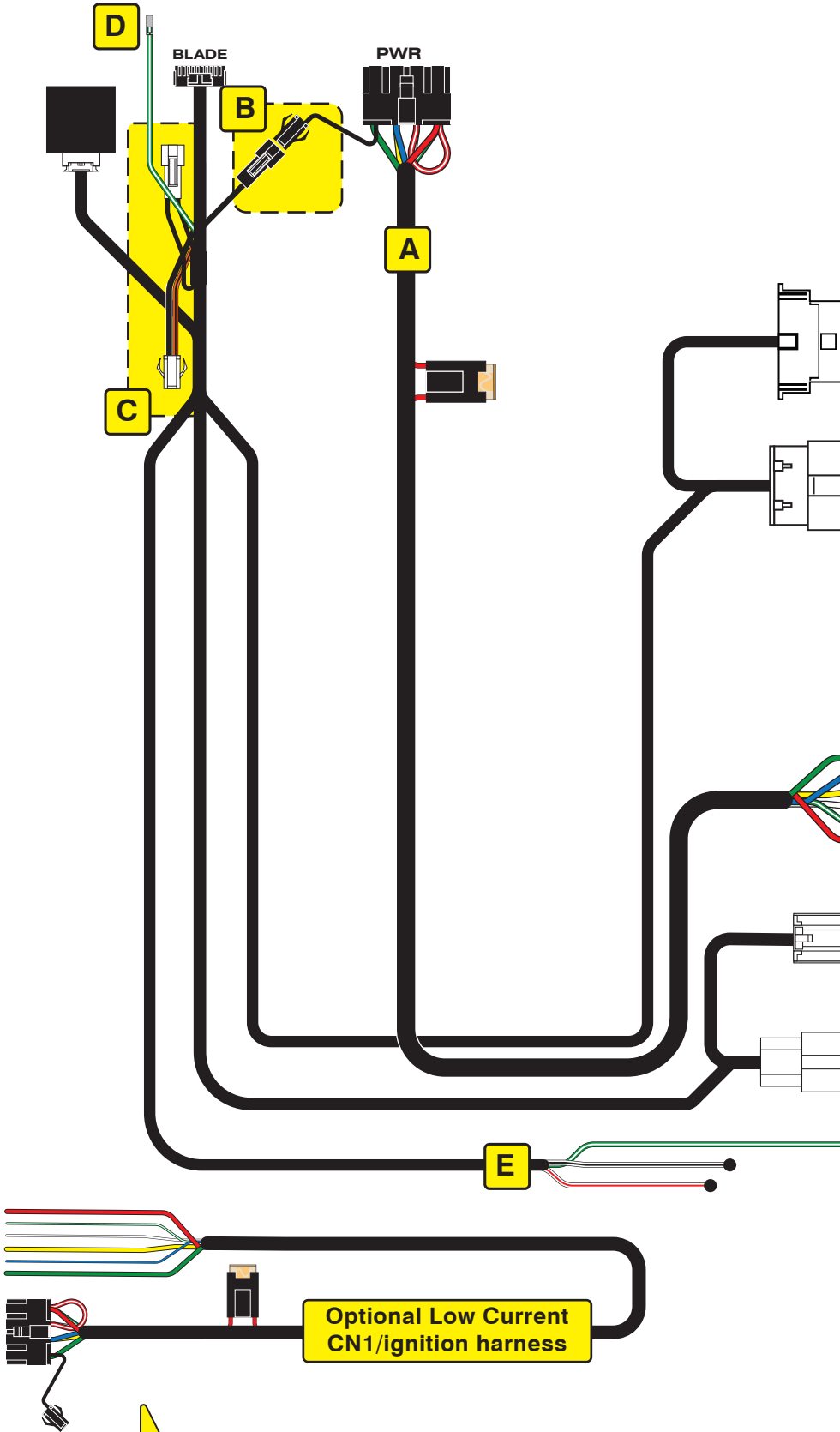

OBD-II Connector 1

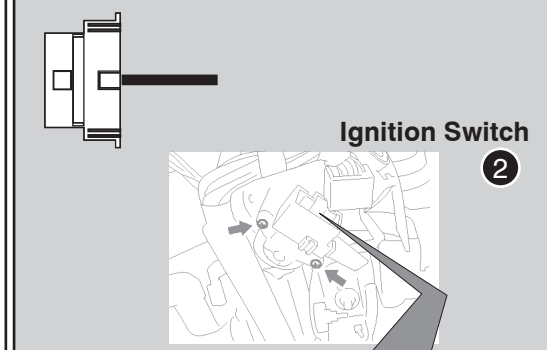
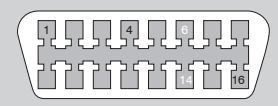

Ignition Switch 2

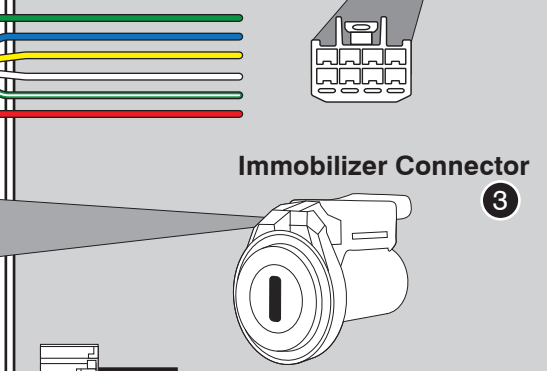

Immobilizer Connector 3

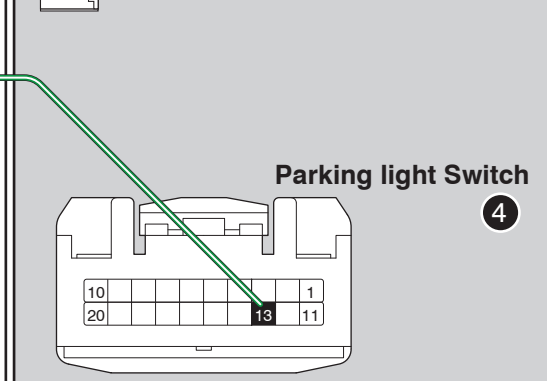

Parking light Switch 4



CN1 - Green/White - START
- CM7 - Jumper #3 to STARTER
- CMX - HCP#1 to 2ND START [2]
- CM9 - Feature option 1-06-2

LED Programming Error Codes

Module LED flashing RED during programming

- 1x - CAN error, check connections
- 2x - VIN detection failure, check CAN connections
- 3x - VIN unknown
- 4x - IMMO error, check connections
- 5x - OEM remote starter detected, remove from vehicle

Solid red LED - TXCT/CODE error, check wiring and confirm equipment level.

CARTRIDGE INSTALLATION

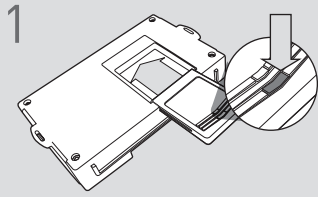

1 Slide cartridge into unit. Notice button under LED.

2

Ready for Module Programming Procedure.

TYPE 1 - MODULE PROGRAMMING PROCEDURE

NOTE

I Between each step, LED will turn solid RED, this is the default standby mode.

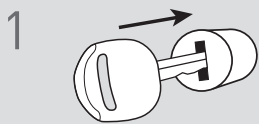

1 Insert key into ignition.



2 Turn key to ON position.



3 LED will flash BLUE once [1x].



4 Turn key to OFF position.

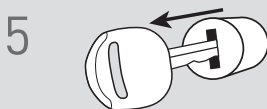

5 Remove key.

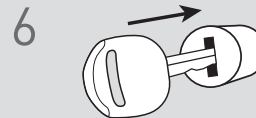

6 Insert key into ignition.

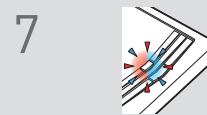

7 LED will flash BLUE and RED.
[If vehicle is not equipped with immobilizer, press module programming button.]

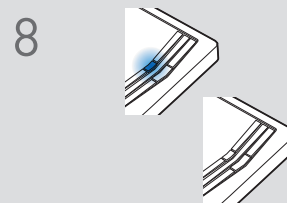

8 Wait, LED will turn solid BLUE then will turn OFF.

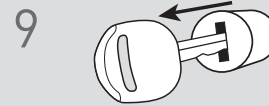

9 Remove key.

10

Module Programming Procedure completed.