

**Códigos de error de programación de LED**

El LED del módulo parpadea en ROJO durante la programación

- 1x - Sin datos CAN, confirmar conectores, verificar voltaje
- 2x - Esperando IGN ON
- 3x - Configuración incorrecta del arnés, verifique las conexiones
- 4x - Llave de detección distinta a la utilizada para la programación
- 5x - La secuencia del inmovilizador no se inicia, despierta el vehículo
- 6x - La secuencia del inmovilizador no se inicia, reinicia el módulo, despierta vehículo y vuelva a intentar la programación, si el problema persiste, reinicie
- 7x - Los datos de Klon no coinciden, procedimiento de reinicio y reinicio

## CARTRIDGE INSTALLATION

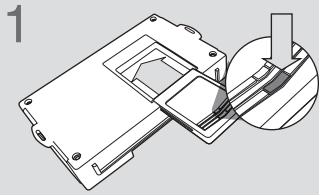

**1** Slide cartridge into unit. Notice button under LED.

**2**

Ready for Module Programming Procedure.

## MODULE PROGRAMMING PROCEDURE

**1** OFF ACC **ON** START

Set ignition to ON position.

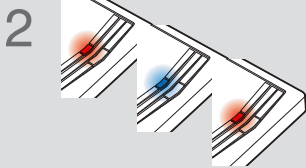

**2** Wait, LED will turn solid RED, then solid BLUE for 1 second, then solid RED.

**3** OFF ACC ON START

Set ignition to OFF position.



**4** Wait, LED will turn OFF.

**5** OFF ACC **ON** START

Set ignition to ON position.



**6** If LED flashes BLUE rapidly, proceed with step 7. If LED turns solid BLUE for 2 seconds, proceed with step 13.

**7** OFF ACC ON START

Set ignition to OFF position.



**8**

**WARNING:**  
Disconnect power last.  
Disconnect module from vehicle.

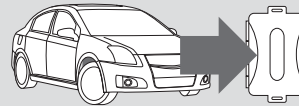

**9**

Connect module to computer and proceed with extended programming.

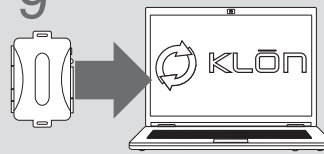

**10**

**WARNING:**  
Connect power first.  
Connect module to vehicle.



**11** OFF ACC **ON** START

Set ignition to ON position.



**12**

Wait, LED will turn solid BLUE for 2 seconds.

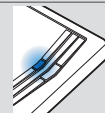

**13** OFF ACC ON START

Set ignition to OFF position.



**14**

Module Programming Procedure completed.

## WARNING: READ BEFORE REMOTE STARTING THE VEHICLE

### IMPORTANT

- I All vehicle doors must be closed and locked prior to remote start sequence. Failure to comply will result in remote starter malfunction.

## TAKE OVER PROCEDURE - PUSH TO START - TO THE VEHICLE OWNER

### NOTE

- I All vehicle doors must be closed and locked prior to remote start sequence.



**TIME RESTRICTION COMING UP !**

1



Unlock vehicle door using OEM or after-market remote, or door request switch.

2

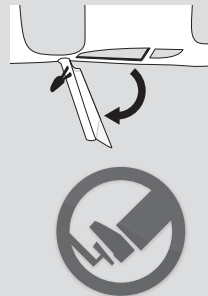

### TIME RESTRICTION

Within 45 SECONDS from previous step:

Open vehicle door.  
Enter vehicle.  
Close vehicle door.

Press and release BRAKE pedal.

3

Take over procedure completed.



Failure to follow procedure will result in vehicle engine shutdown.



