

FTI-NSP8: Vehicle Coverage and Preparation Notes

Make	Model	Year	Install	CAN	Lights	BCM	POC	I/O Changes
DL-NI8 Nissan	Altima PTS AT	2019-23	Type 1	BCM	Park / Auto POC 1	DSD	Hazard 1/2	Green White/Blue

NI8 Type 1 install requires **BLADE-AL(DL)-NI8**, flash module and update the controller firmware before installing.

CAN: CAN data is acquired from the BCM using the green harness cable.

POC1: Visual status confirmations and diagnostic information are provided by hazard light connections in the harness assembly, POC1 must be configured for either **Hazard1** (POC option #30 (momentary switch) **or** **Hazard2** (POC option #23 (latching switch)).

Type 1 Door Locks: Connect female white 2-pin door lock connector to male white 2-pin (A) BCM jumper.

CM Unlock Configuration: Proper unlock control requires configuring the controller disarm output to double-pulse unlock. Set feature option 1-4 to setting 2 (Double Pulse).

Vehicle Damage Warning:

Caution should be taken to avoid mixing up the BCM connectors, vehicle damage will result if the connectors are positioned improperly. It is advised that you make the BCM connections one at a time, confirming that each T-harness connection is at the correct BCM position before proceeding to the next connection, attempting to program, or attempting to remote start.

FTI-NSP8: Installation and Configuration Notes

A REQUIRED CONNECTIONS

B REQUIRED CONNECTIONS - SEE WARNING ABOVE

C REQUIRED CONNECTION - REQUIRES CONFIGURATION (Option 1-4 to 2)

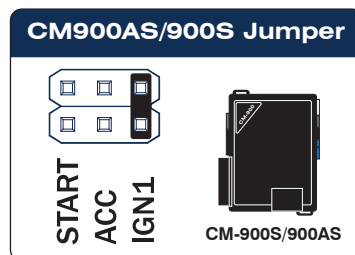

FEATURE COVERAGE															
IMMOBILIZER DATA															
DOOR LOCK															
DOOR UNLOCK															
ARM OEM ALARM															
DISARM OEM ALARM															
DOOR STATUS															
TRUNK STATUS															
BRAKE STATUS															
E-BRAKE STATUS															
TACH OUTPUT															
SECURE TAKEOVER															
HAZARD LIGHTS															

•FT-DAS Required for manual transmission.
•BOTH Red & Red/White MUST be connected with high current application.

Jumper Setting			
Parking Light	Accessory	Ignition (Default)	(+)Door Trigger In
Trunk	Starter	Parking Light (Default)	(-)Door Trigger In (Default)
Starter	Ignition	Accessory (Default)	

CM7000/7200

CMX

Cut loop for A/T

CMX High Current Programmable (+) Output Channels

HCP #1 - Parking Light
HCP #2 - Accessory
HCP #3 - Ignition

[2] 2ND START
[3] 2ND IGNITION
[4] 2ND ACCESSORY

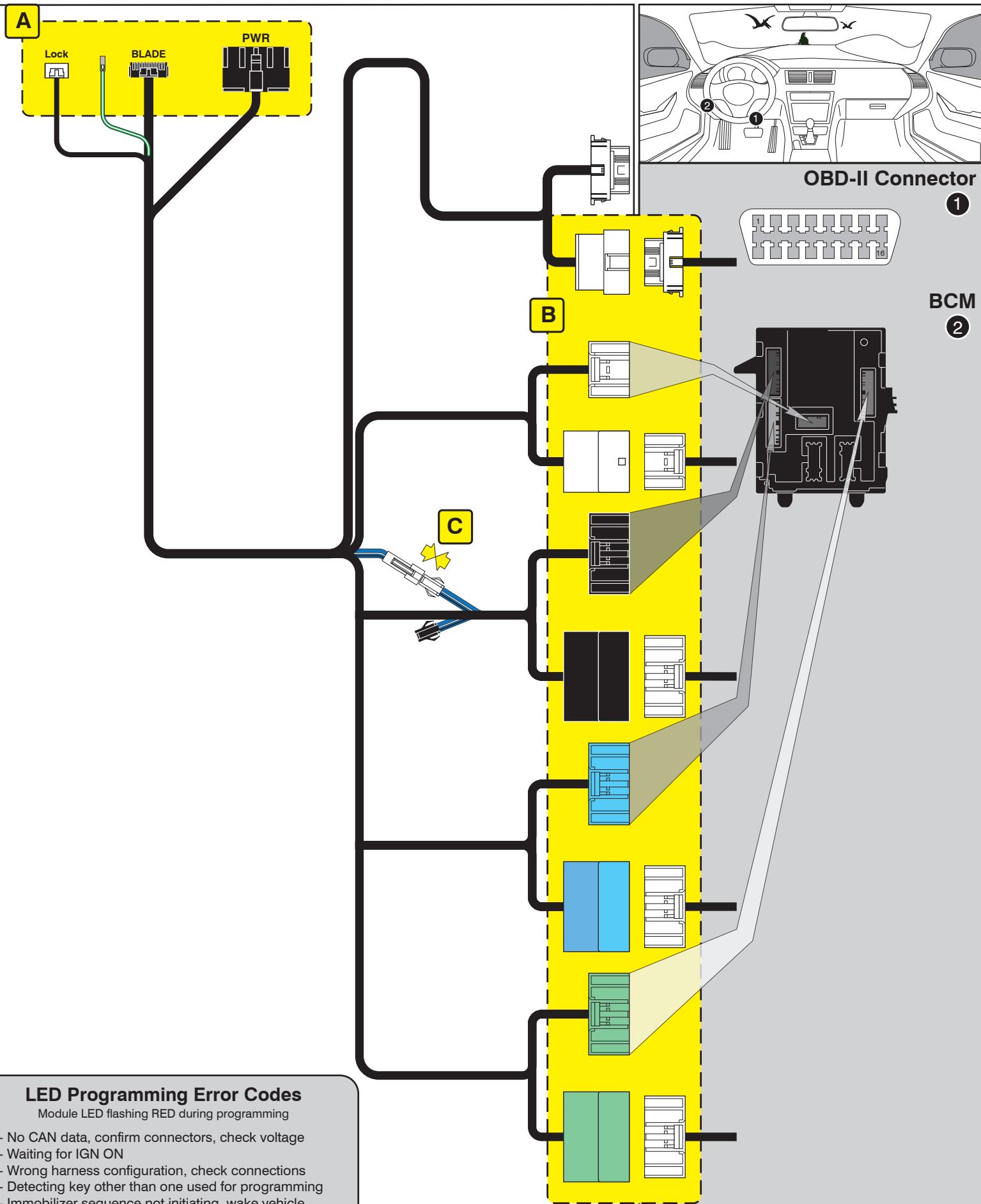

LED Programming Error Codes

Module LED flashing RED during programming

- 1x - No CAN data, confirm connectors, check voltage
- 2x - Waiting for IGN ON
- 3x - Wrong harness configuration, check connections
- 4x - Detecting key other than one used for programming
- 5x - Immobilizer sequence not initiating, wake vehicle
- 6x - Immobilizer sequence not initiating, reset module, wake vehicle and retry programming, if issue persists, restart
- 7x - Klon data does not match, reset and restart procedure

CARTRIDGE INSTALLATION

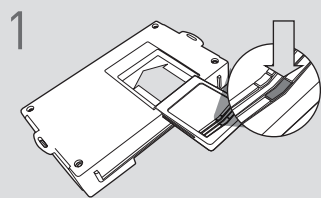

Slide cartridge into unit. Notice button under LED.

2

Ready for Module Programming Procedure.

MODULE PROGRAMMING PROCEDURE

1 OFF ACC **ON** START

Set ignition to ON position.

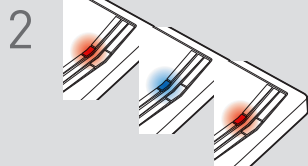

Wait, LED will turn solid RED, then solid BLUE for 1 second, then solid RED.

3 OFF ACC **ON** START

Set ignition to OFF position.



Wait, LED will turn OFF.

5 OFF ACC **ON** START

Set ignition to ON position.

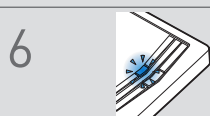

If LED flashes BLUE rapidly, proceed with step 7. If LED turns solid BLUE for 2 seconds, proceed with step 13.

7 OFF ACC **ON** START

Set ignition to OFF position.



8

WARNING:
Disconnect power last.
Disconnect module from vehicle.

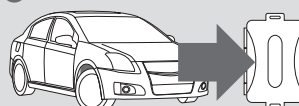

9

Connect module to computer and proceed with extended programming.

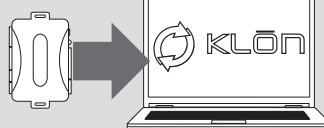

10

WARNING:
Connect power first.
Connect module to vehicle.



11 OFF ACC **ON** START

Set ignition to ON position.



12

Wait, LED will turn solid BLUE for 2 seconds.



13 OFF ACC **ON** START

Set ignition to OFF position.



14

Module Programming Procedure completed.

WARNING: READ BEFORE REMOTE STARTING THE VEHICLE

IMPORTANT

- I All vehicle doors must be closed and locked prior to remote start sequence. Failure to comply will result in remote starter malfunction.

TAKE OVER PROCEDURE - PUSH TO START - TO THE VEHICLE OWNER

NOTE

- I All vehicle doors must be closed and locked prior to remote start sequence.



TIME RESTRICTION COMING UP !

1



Unlock vehicle door using OEM or after-market remote, or door request switch.

2

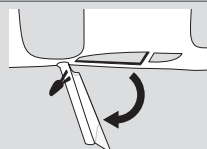

TIME RESTRICTION

Within 45 SECONDS from previous step:

Open vehicle door.
Enter vehicle.
Close vehicle door.

Press and release BRAKE pedal.

3

Take over procedure completed.



Failure to follow procedure will result in vehicle engine shutdown.

