

Make	Model	Year	Install	CAN	Lights	BCM	POC	I/O Changes
DL-NI8 Infiniti	QX50 PTS AT	2019-21	Type 2	BCM	Park / Auto POC 1	DSD	Hazard 1/2	Green White/Blue

NI8 Type 2 install requires **BLADE-AL(DL)-NI8**, flash module and update the controller firmware before installing.

CAN: CAN data is acquired from the BCM using the green harness cable.

POC1: Visual status confirmations and diagnostic information are provided by hazard light connections in the harness assembly, POC1 must be configured for either **Hazard1** (POC option #30 (momentary switch) **or** **Hazard2** (POC option #23 (latching switch)).

Type 2 Door Locks: Connect female white 2-pin door lock connector to male black 2-pin (B) BCM jumper.

CM Unlock Configuration: Proper unlock control requires configuring the controller disarm output to double-pulse unlock. Set feature option 1-4 to setting 2 (Double Pulse).

Vehicle Damage Warning:

Caution should be taken to avoid mixing up the BCM connectors, vehicle damage will result if the connectors are positioned improperly. It is advised that you make the BCM connections one at a time, confirming that each T-harness connection is at the correct BCM position before proceeding to the next connection, attempting to program, or attempting to remote start.

FTI-NSP8: Installation and Configuration Notes

- A** REQUIRED CONNECTIONS - SECURE UNUSED I/O CONNECTORS
- B** REQUIRED CONNECTIONS - SEE WARNING ABOVE
- C** REQUIRED CONNECTION - REQUIRES CONFIGURATION (Option 1-4 to 2)

- FT-DAS Required for manual transmission.
- BOTH Red & Red/White MUST be connected with high current application.

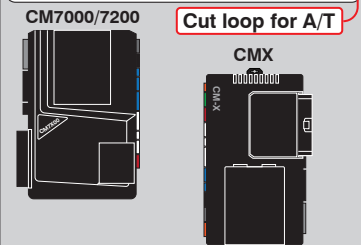
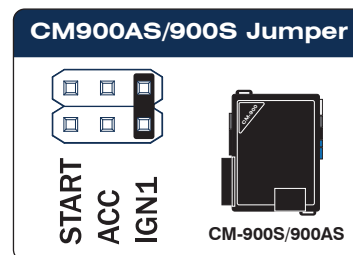
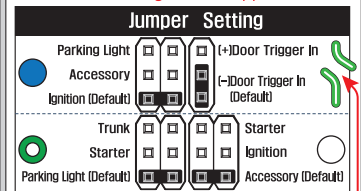

FEATURE COVERAGE													
IMMOBILIZER DATA													
DOOR LOCK													
DOOR UNLOCK													
ARM OEM ALARM													
DISARM OEM ALARM													
DOOR STATUS													
TRUNK STATUS													
BRAKE STATUS													
E-BRAKE STATUS													
TACH OUTPUT													
SECURE TAKEOVER													
HAZARD LIGHTS													

CMX High Current Programmable (+) Output Channels

HCP #1 - Parking Light
HCP #2 - Accessory
HCP #3 - Ignition

[2] 2ND START
[3] 2ND IGNITION
[4] 2ND ACCESSORY

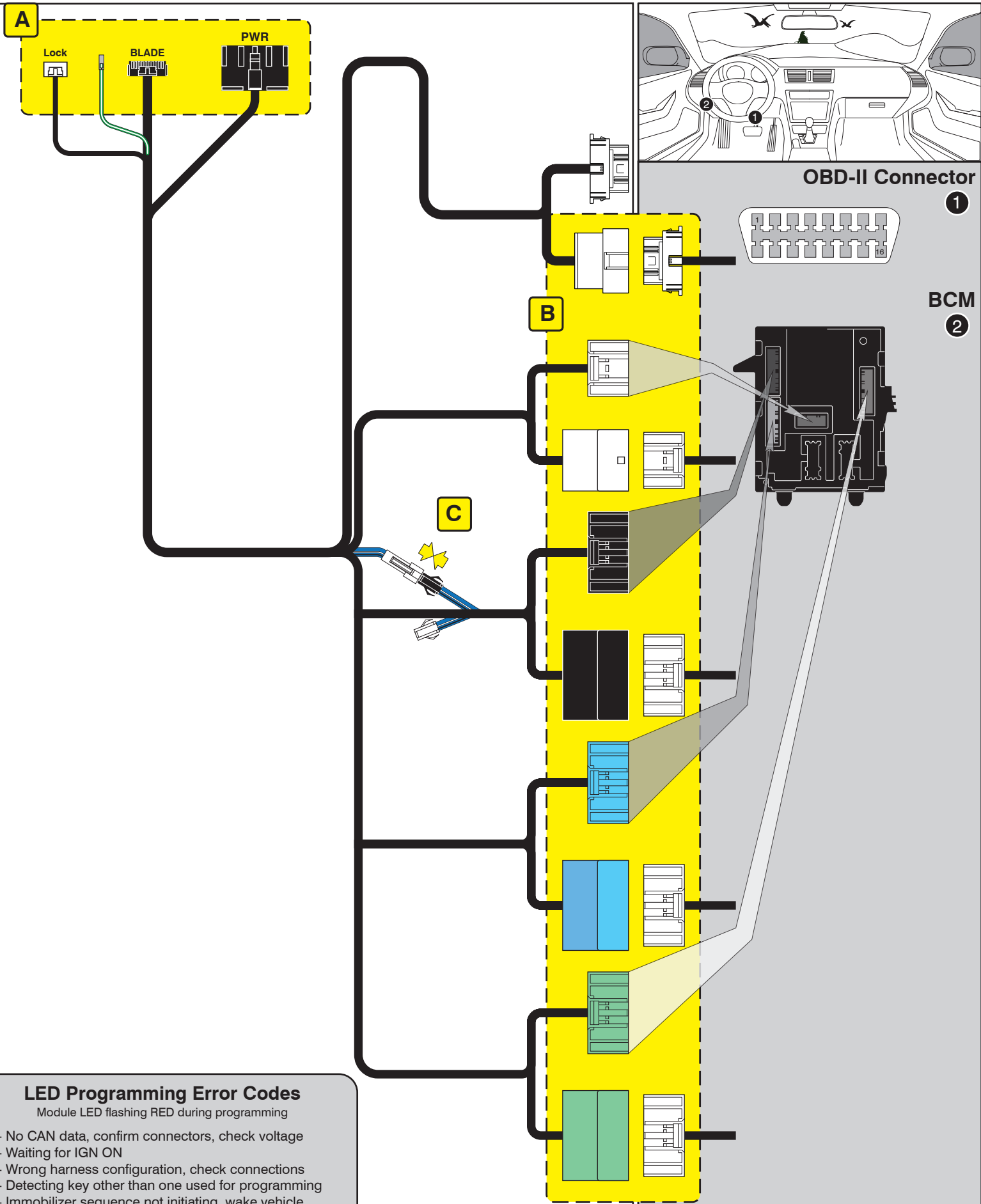

LED Programming Error Codes

Module LED flashing RED during programming

- 1x - No CAN data, confirm connectors, check voltage
- 2x - Waiting for IGN ON
- 3x - Wrong harness configuration, check connections
- 4x - Detecting key other than one used for programming
- 5x - Immobilizer sequence not initiating, wake vehicle
- 6x - Immobilizer sequence not initiating, reset module, wake vehicle and retry programming, if issue persists, restart
- 7x - Klon data does not match, reset and restart procedure

CARTRIDGE INSTALLATION

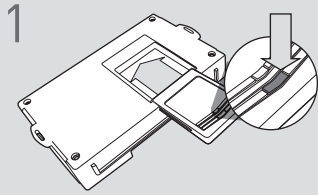

1 Slide cartridge into unit. Notice button under LED.

2

Ready for Module Programming Procedure.

MODULE PROGRAMMING PROCEDURE

1 OFF ACC **ON** START

Set ignition to ON position.

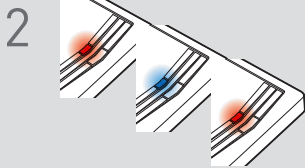

2 Wait, LED will turn solid RED, then solid BLUE for 1 second, then solid RED.

3 OFF ACC ON START

Set ignition to OFF position.



4 Wait, LED will turn OFF.

5 OFF ACC **ON** START

Set ignition to ON position.



6 If LED flashes BLUE rapidly, proceed with step 7. If LED turns solid BLUE for 2 seconds, proceed with step 13.

7 OFF ACC ON START

Set ignition to OFF position.



8

WARNING:
Disconnect power last.
Disconnect module from vehicle.

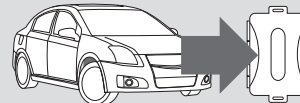

9

Connect module to computer and proceed with extended programming.

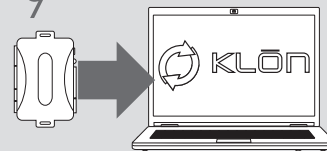

10

WARNING:
Connect power first.
Connect module to vehicle.



11 OFF ACC **ON** START

Set ignition to ON position.



12

Wait, LED will turn solid BLUE for 2 seconds.

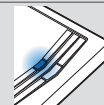

13 OFF ACC ON START

Set ignition to OFF position.



14

Module Programming Procedure completed.

WARNING: READ BEFORE REMOTE STARTING THE VEHICLE

IMPORTANT

- I All vehicle doors must be closed and locked prior to remote start sequence. Failure to comply will result in remote starter malfunction.

TAKE OVER PROCEDURE - PUSH TO START - TO THE VEHICLE OWNER

NOTE

- I All vehicle doors must be closed and locked prior to remote start sequence.



TIME RESTRICTION COMING UP !

1



Unlock vehicle door using OEM or after-market remote, or door request switch.

2



TIME RESTRICTION

Within 45 SECONDS from previous step:

Open vehicle door.
Enter vehicle.
Close vehicle door.

Press and release BRAKE pedal.

3

Take over procedure completed.



Failure to follow procedure will result in vehicle engine shutdown.

