

# FTI-HDP8: Vehicle Coverage and Preparation Notes

Make	Model	Year	Install	CAN	Lights	BCM	Clutch	S-NET Data
<b>DL-HA6</b>								
Honda	Odyssey PTS AT	2018-24	Type 1	Blue	Park / Auto white/pink	AFB	N/A	BCM Gray 40-pin Lt. Green

## Firmware:

This installation requires **BLADE-AL(DL)-HA6** firmware, flash module and update the controller firmware before installing.

## Lights:

This kit includes a pre-terminated harness for the purpose of connecting the parking lights and clutch wire (when required). Use of the included harness requires modification of the gray I/O connector of the control module, removal of the existing parking light and status wires (the negative start wire also, when clutch handling is required), and replacing them with wires from the included harness. The required connections are located in the gray 28-pin connector, parking lights (pin #11), auto-lights (pin #10)

## S-Net:

Gathering S-NET data requires a manual connection to be made at the Gray 40-pin connector of the BCM, the S-NET data wire is located at pin #35 of the connector.

# FTI-HDP8: Installation and Configuration Notes

- A** REQUIRED CONNECTION
- B** REQUIRED CONNECTIONS (SEE NOTES REGARDING REQUIRED MODIFICATION)
- C** REQUIRED CONNECTIONS
- D** NOT REQUIRED



FEATURE COVERAGE																	
IMMOBILIZER DATA	AM RS CONTROL	DOOR LOCK	DOOR UNLOCK	ARM OEM ALARM	DISARM OEM ALARM		POWER LIFTGATE	POWER SLIDING DOOR (L)	POWER SLIDING DOOR (R)	DOOR STATUS	TRUNK STATUS	HOOD STATUS	BRAKE STATUS	E-BRAKE STATUS	TACH OUTPUT	AUTOLIGHT CTRL	PARKING LIGHTS

•FT-DAS Required for manual transmission.  
•BOTH Red & Red/White MUST be connected with high current application.

Jumper Setting			
Parking Light			(+)Door Trigger In
Accessory			(-)Door Trigger In (Default)
Ignition (Default)			
Trunk			Starter
Starter			Ignition
Parking Light (Default)			Accessory (Default)

**CM7000/7200** Cut loop for A/T

**CM-900S/900AS**

**CM900AS/900S Jumper**

**START**  
**ACC**  
**IGN1**



### LED Programming Error Codes

Module LED flashing RED during programming

- 1x - No CAN activity, check connectors/CAN voltage
- 2x - Klon data error, confirm S-NET connection
- 3x - No S-NET data, confirm connection
- 4x - No VIN, confirm CAN connections and vehicle entered when flashing

After Klon:

- Solid red LED - redo part 1 of Klon
- 2x - Klon data is wrong, confirm data connection, start over from the beginning

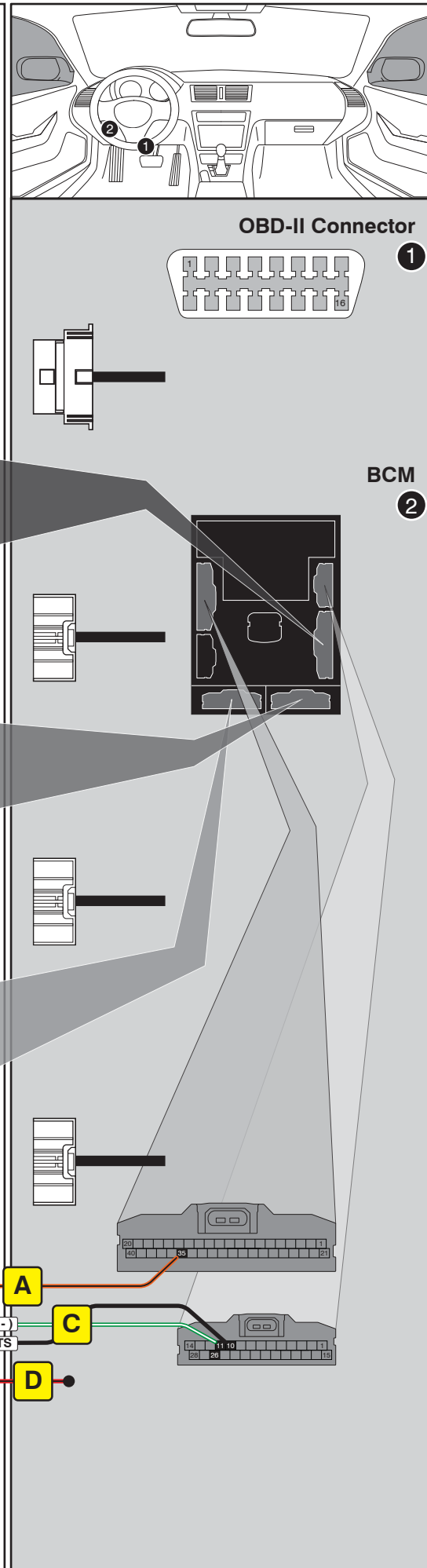

**Takeover not supported:** Vehicle engine will shut down when doors are opened.

## CARTRIDGE INSTALLATION

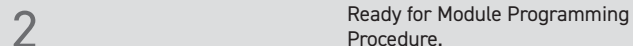
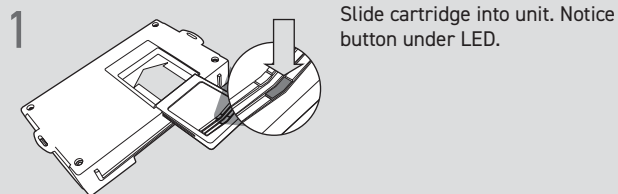

## MODULE PROGRAMMING PROCEDURE

