

BCM  
2

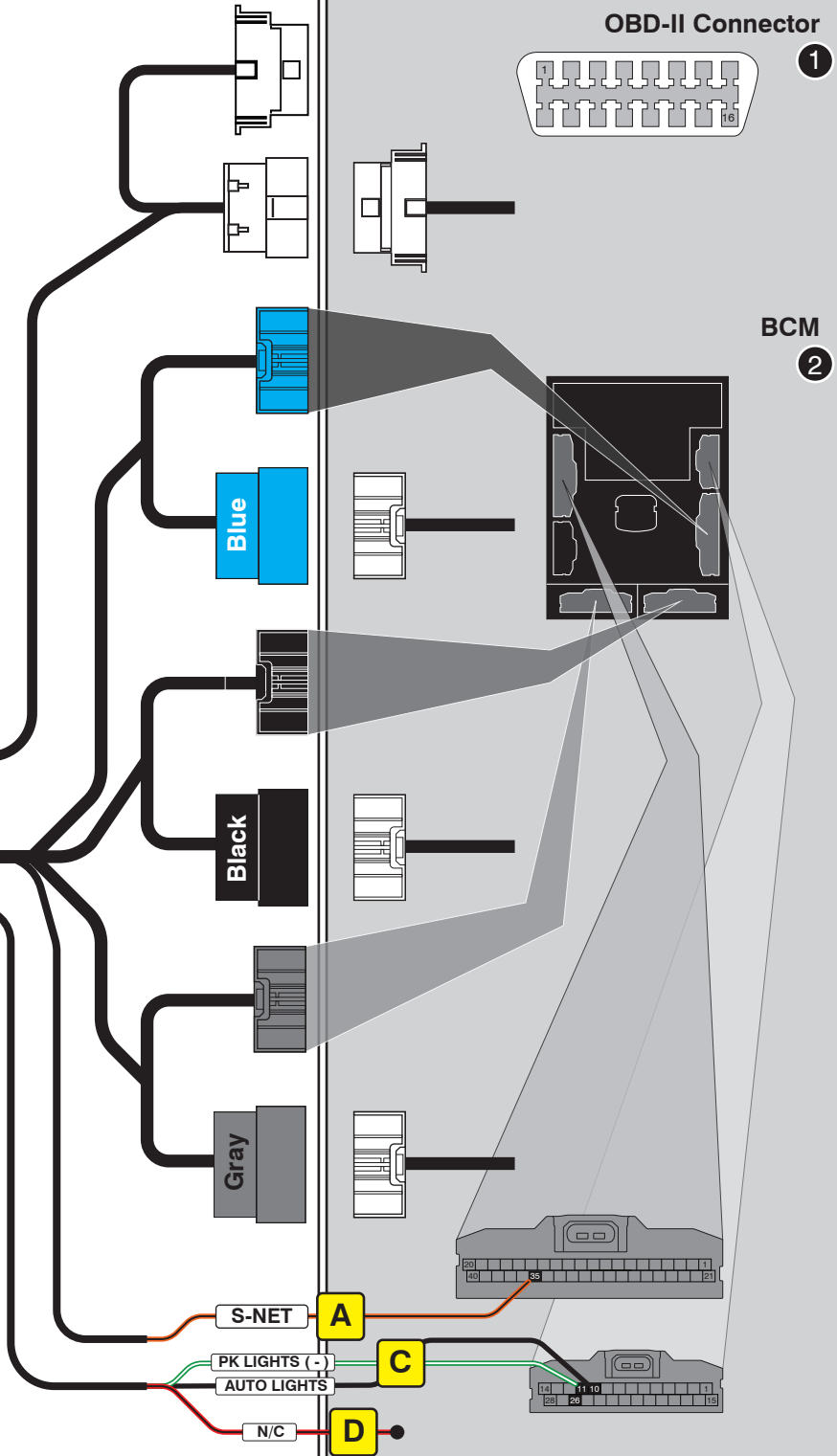

**Códigos de error de programación de LED**

El LED del módulo parpadea en ROJO durante la programación

- 1x - Sin actividad CAN, verifique conectores / voltaje CAN
- 2x - Error de datos de Klon, confirme la conexión S-NET
- 3x - No hay datos S-NET, confirme la conexión
- 4x - Sin VIN, confirme las conexiones CAN y el vehículo ingresado cuando parpadea

Después de Klon:

- LED rojo fijo - rehaga la parte 1 de Klon
- 2x - Los datos de Klon son incorrectos, confirme la conexión de datos, empezar de nuevo desde el principio

**Adquisición no admitida:** El motor del vehículo se apagará cuando se abran las puertas.

## CARTRIDGE INSTALLATION

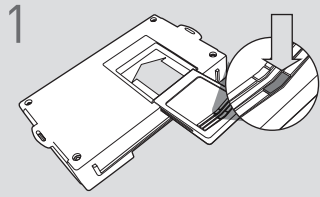

1 Slide cartridge into unit. Notice button under LED.

2

Ready for Module Programming Procedure.

## MODULE PROGRAMMING PROCEDURE

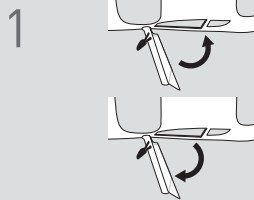

1 Close driver door.

Re-open driver door to wake up data bus.

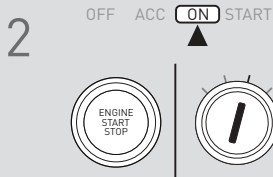

2 Turn ignition to ON position.

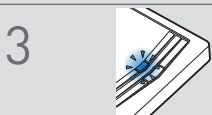

3 Wait, LED will flash BLUE rapidly.

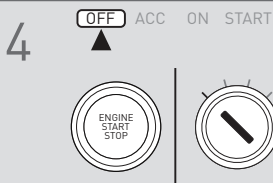

4 Turn ignition to OFF position.

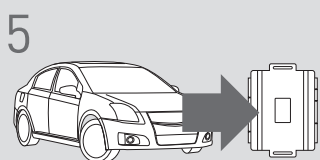

5 **WARNING:**  
Disconnect power last.  
Disconnect RS from vehicle.

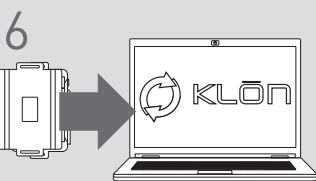

6 Connect RS to computer and proceed with extended programming.

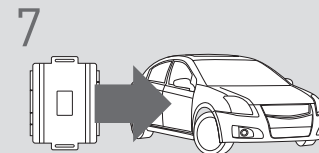

7 **WARNING:** Do not press RS programming button.  
Connect power first.  
Connect RS to vehicle.

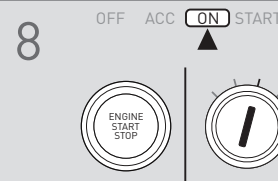

8 Turn ignition to ON position.

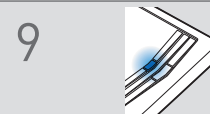

9 Wait, LED will turn solid BLUE for 2 seconds.

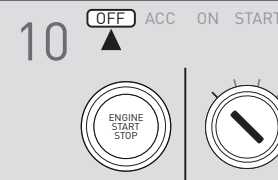

10 Turn ignition to OFF position.



11 Press UNLOCK on the OEM remote.

**!** If the vehicle is equipped with a power liftgate: Open and close the power liftgate with the OEM keyfob.

12

Module Programming Procedure completed.