

FTI-HDP8: Vehicle Coverage and Preparation Notes

Make	Model	Year	Install	CAN	Lights	BCM	Clutch	S-NET Data
DL-HA6 Honda	CR-V PTS AT	2017-22	Type 1	Blue	Park / Auto gray/pink	AFB	N/A	BCM Gray 40-pin Lt. Green

Firmware:

This installation requires **BLADE-AL(DL)-HA6** firmware, flash module and update the controller firmware before installing.

Lights:

This kit includes a pre-terminated harness for the purpose of connecting the parking lights and clutch wire (when required). Use of the included harness requires modification of the gray I/O connector of the control module, removal of the existing parking light and status wires (the negative start wire also, when clutch handling is required), and replacing them with wires from the included harness. The required connections are located in the gray 28-pin connector, parking lights (pin #11), auto-lights (pin #10)

S-Net:

Gathering S-NET data requires a manual connection to be made at the Gray 40-pin connector of the BCM, the S-NET data wire is located at pin #35 of the connector.



FTI-HDP8: Installation and Configuration Notes

- A** REQUIRED CONNECTION
- B** REQUIRED CONNECTIONS (SEE NOTES REGARDING REQUIRED MODIFICATION)
- C** REQUIRED CONNECTIONS
- D** NOT REQUIRED

•FT-DAS Required for manual transmission.
•BOTH Red & Red/White MUST be connected with high current application.

Jumper Setting

CM7000/7200 **Cut loop for A/T**

CM-900S/900AS

CM900AS/900S Jumper

START
ACC
IGN1



FEATURE COVERAGE	
IMMOBILIZER DATA	
A/M RS CONTROL	
DOOR LOCK	
DOOR UNLOCK	
ARM OEM ALARM	
DISARM OEM ALARM	
TRUNK/HATCH RELEASE	
DOOR STATUS	
TRUNK STATUS	
HOOD STATUS	
BRAKE STATUS	
E-BRAKE STATUS	
TACH OUTPUT	
AUTOLIGHT CTRL	
PARKING LIGHTS	

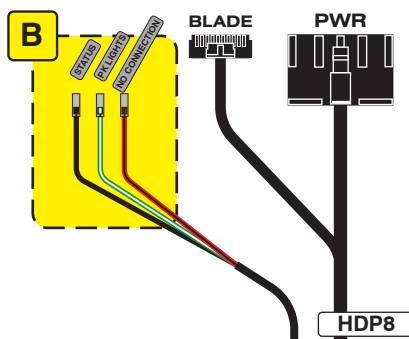

HDP8

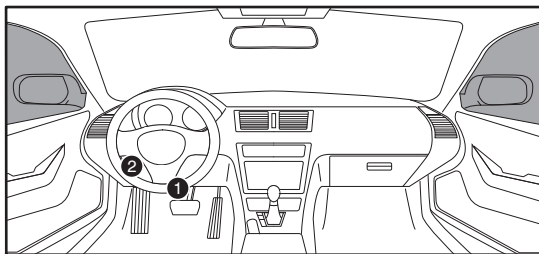
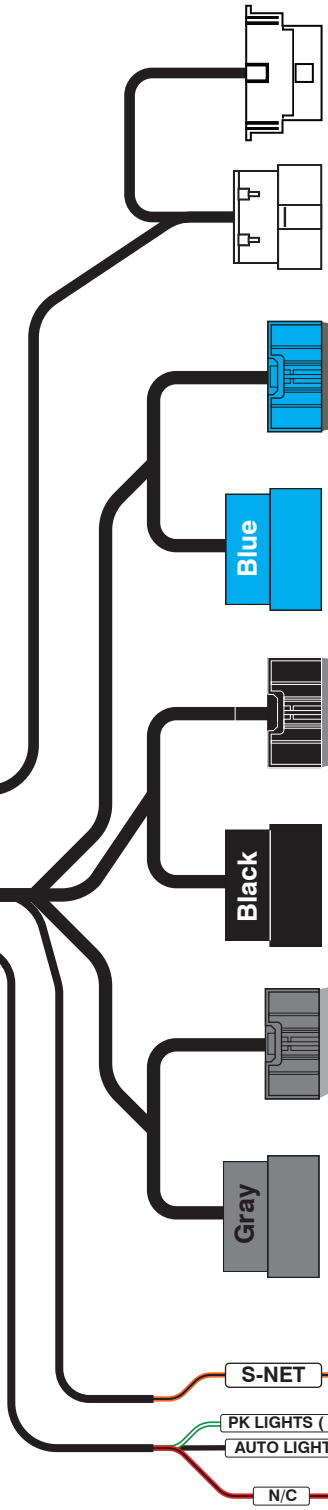

OBD-II Connector

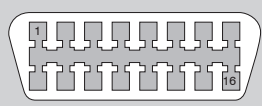

BCM

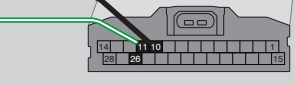
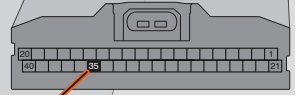
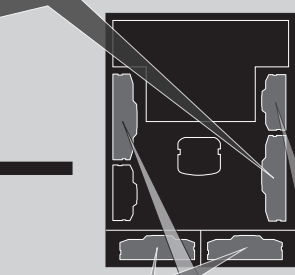

LED Programming Error Codes
Module LED flashing RED during programming

- 1x - No CAN activity, check connectors/CAN voltage
- 2x - Klon data error, confirm S-NET connection
- 3x - No S-NET data, confirm connection
- 4x - No VIN, confirm CAN connections and vehicle entered when flashing

After Klon:
Solid red LED - redo part 1 of Klon
2x - Klon data is wrong, confirm data connection, start over from the beginning

Takeover not supported: Vehicle engine will shut down when doors are opened.

CARTRIDGE INSTALLATION

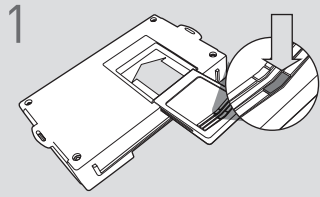

1 Slide cartridge into unit. Notice button under LED.

2

Ready for Module Programming Procedure.

MODULE PROGRAMMING PROCEDURE

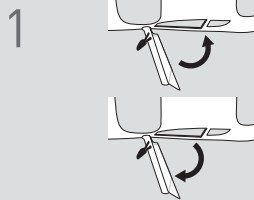

1 Close driver door.

Re-open driver door to wake up data bus.

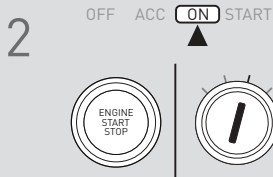

2 Turn ignition to ON position.

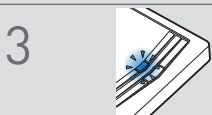

3 Wait, LED will flash BLUE rapidly.

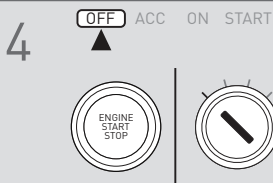

4 Turn ignition to OFF position.

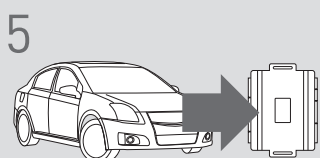

5 **WARNING:**
Disconnect power last.
Disconnect RS from vehicle.

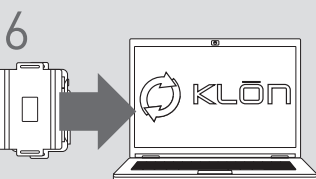

6 Connect RS to computer and proceed with extended programming.

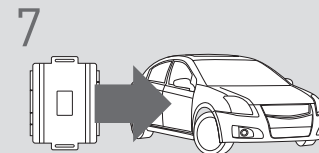

7 **WARNING:** Do not press RS programming button.
Connect power first.
Connect RS to vehicle.

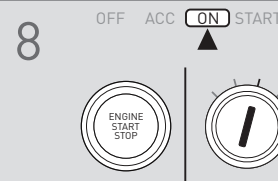

8 Turn ignition to ON position.

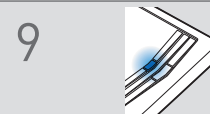

9 Wait, LED will turn solid BLUE for 2 seconds.

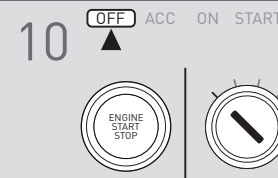

10 Turn ignition to OFF position.



11 Press UNLOCK on the OEM remote.

! If the vehicle is equipped with a power liftgate: Open and close the power liftgate with the OEM keyfob.

12

Module Programming Procedure completed.