

Takeover not supported: Vehicle engine will shut down when doors are opened.

CARTRIDGE INSTALLATION

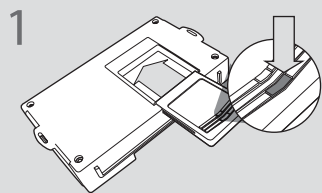

Slide cartridge into unit. Notice button under LED.

2

Ready for Module Programming Procedure.

MODULE PROGRAMMING PROCEDURE

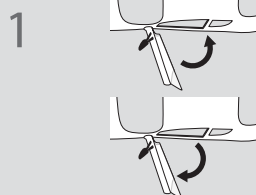

Close driver door.

Re-open driver door to wake up data bus.

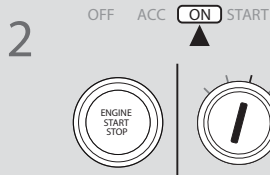

Turn ignition to ON position.

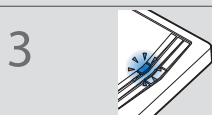

Wait, LED will flash BLUE rapidly.

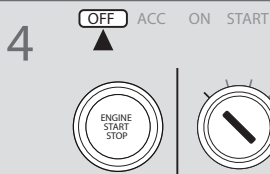

Turn ignition to OFF position.

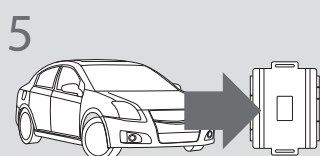

WARNING:
Disconnect power last.
Disconnect RS from vehicle.

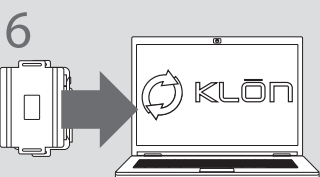

Connect RS to computer and proceed with extended programming.

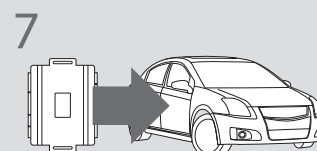

WARNING: Do not press RS programming button.
Connect power first.
Connect RS to vehicle.

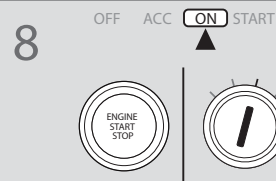

Turn ignition to ON position.

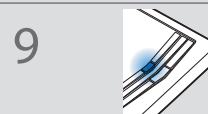

Wait, LED will turn solid BLUE for 2 seconds .

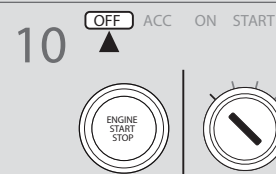

Turn ignition to OFF position.



Press UNLOCK on the OEM remote.

! If the vehicle is equipped with a power liftgate: Open and close the power liftgate with the OEM keyfob.

12

Module Programming Procedure completed.